

REV.	ECN NO OR DESCRIPTION	REVISED	DATE
A	PDR NO: T170921-4A	ALLEN	2018.03.12
B	ECN NO: S180406-R	PAN	2018.04.09

IEC & FCC SPEC

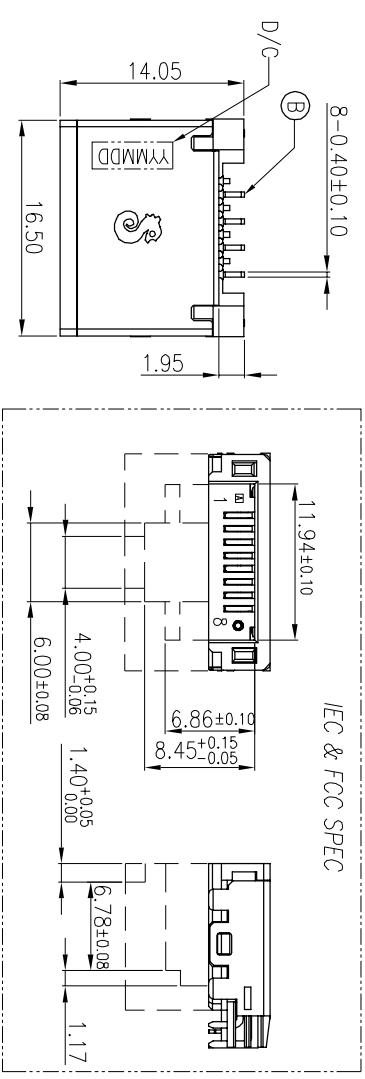

SPECIFICATIONS:

- ELECTRICAL CHARACTERISTICS:
 - CURRENT RATING: 1.5A MAX.
 - VOLTAGE RATING: 150V MAX.
 - CONTACT RESISTANCE: 50mΩ MAX.(INITIAL), 100mΩ MAX.(AFTER LIFE TEST).
 - INSULATION RESISTANCE: 100MΩ MIN.
 - Dielectric Withstanding Voltage : 500 V AC
- MECHANICAL CHARACTERISTICS:
 - DURABILITY: 5000 CYCLES.
 - INSERTION FORCE: 2.25kg MAX. WITH LATCH DEPRESSED.
 - WITHDRAWAL FORCE: 4.5kg MAX. WITH LATCH DEPRESSED.
 - OPERATING TEMPERATURE: -30℃ ~ +70℃.
- MARKING: MARK "S" INSIDE OF THE CONNECTOR.
- PACKAGING : TAPE & REEL.
- TO CONFORM TO SINGATRON HAZARDOUS SUBSTANCE FREE SPEC
- HALOGEN FREE PRODUCT IDENTIFICATION
- HALOGEN FREE PRODUCT IDENTIFICATION LOGO
- MARK ON PRODUCT: ○
- FOR REFLOW SOLDERING LEAD-FREE PROCESS.
- PRINTED DATE CODE "YY MM DD" ON TOP OF THE CONNECTOR.

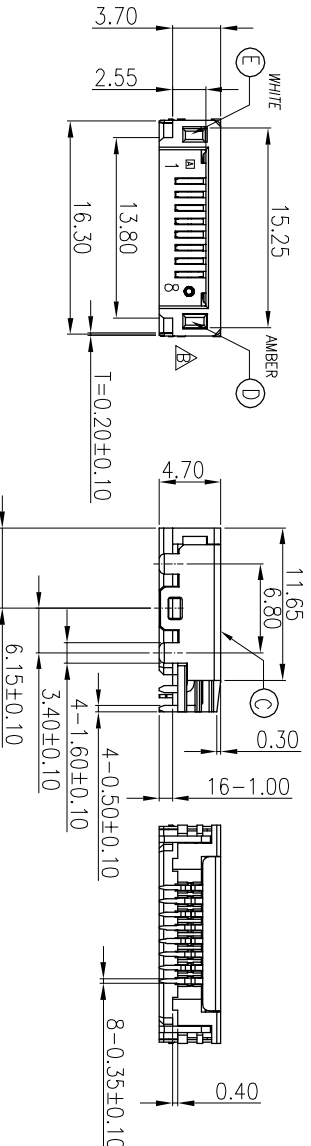

NODE	COLOR	A1~A2	B1~B2
A1(+)	AMBER	A1~A2	B1~B2
B1(+)	WHITE	B1~B2	B1~B2

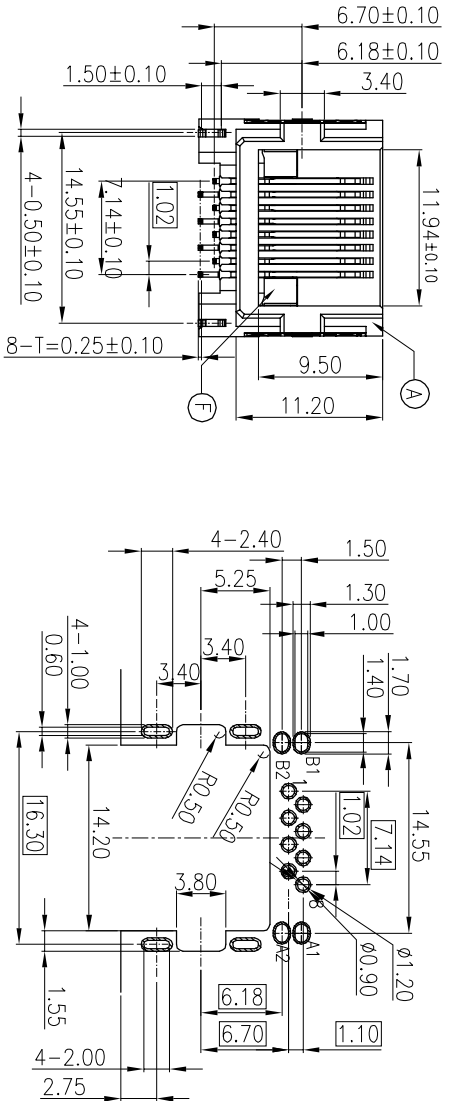

NO	DESCRIPTION	QTY	MATERIAL	PLATING & COLOR
F	STOP	2	HIGH TEMP.THERMOPLASTIC	UL 94V-0 & Yellow
E	LED 2	1	WHITE	Matte Sn 80u" ON SOLDER TAIL;
D	LED 1	1	AMBER	Matte Sn 80u" ON SOLDER TAIL;
C	SHELL	1	STAINLESS STEEL	NICKEL
B	TERMINAL	8	PHOSPHOR BRONZE	NIPDING ALL OVER
A	HOUSING	1	HIGH TEMP.THERMOPLASTIC	UL 94V-0 & BLACK

信音企業股份有限公司

UNLESS OTHERWISE SPECIFIED TOLERANCES:

DECIMALS: ANGLES:
 X :±0.5 X :±2°
 X.X :±0.3 X.X :±1'
 X.XX :±0.2

RECOMMENDED PCB LAYOUT
 TOP VIEW ; TOL.±0.05
 (PCB THICKNESS=1.00mm)

REV.	ECN NO OR DESCRIPTION	REVISED	DATE
A	PDR NO: T170921-4A	ALLEN	2018.03.12
B	ECN NO: S180406-R	PAN	2018.04.09

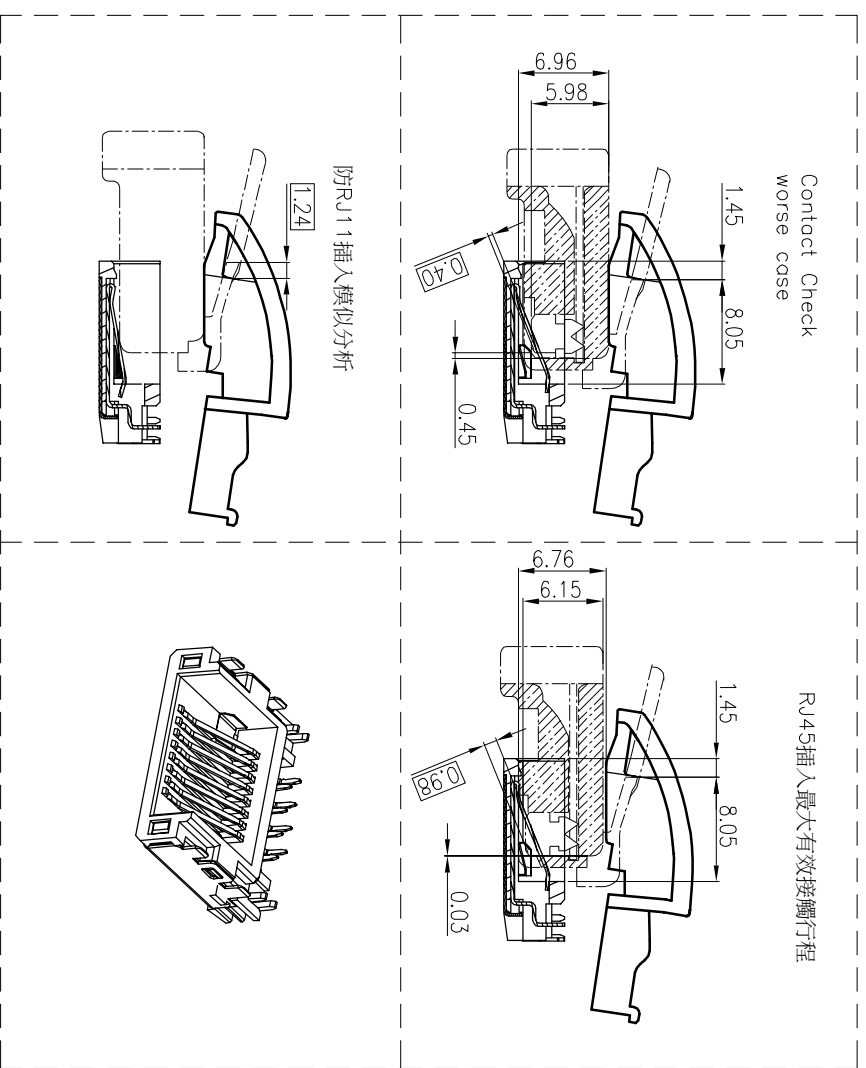

NO	DESCRIPTION	QTY	MATERIAL	PLATING & COLOR
UNLESS OTHERWISE SPECIFIED TOLERANCES				
Singatron Enterprise Co., Ltd. 信晉企業股份有限公司				
DECIMALS: ANGLES:				
X	:±0.5	X	:±2°	
X.X	:±0.3	X.X	:±1°	
X.XX	:±0.2			
TITLE				
DWN	PAN	PART NO.	*****	
CHKD	JAMES	SCALE 1:1	UNIT: mm	
APVD	BOYE	SIZE: A3	SHEET: 10F1	REV: 1
CUSTOMER COPY				

1 2 3 4 5 6 7 8

1 2 3 4 5 6 7 8

1 2 3 4 5 6 7 8

1 2 3 4 5 6 7 8

1 2 3 4 5 6 7 8

1 2 3 4 5 6 7 8

1 2 3 4 5 6 7 8

1 2 3 4 5 6 7 8