

| REV. | ECN NO OR DESCRIPTION | REVISED | DATE |
|------|-----------------------------|---------|------------|
| A | PDR NO: S190129-1A | PAN | 2019.03.05 |
| B | ECN NO: S190411-C&S190505-C | PAN | 2019.06.27 |

SPECIFICATIONS:

- ELECTRICAL CHARACTERISTICS:**
 - CURRENT RATING: 1.5A MAX.
 - VOLTAGE RATING: 150V MAX.
 - CONTACT RESISTANCE: 50mΩ MAX.(INITIAL), 100mΩ MAX.(AFTER LIFE TEST).
 - INSULATION RESISTANCE : 100MΩ MIN.
 - Dielectric Withstanding Voltage : 500 V AC
- MECHANICAL CHARACTERISTICS:**
 - DURABILITY: 5000 CYCLES.
 - INSERTION FORCE: 2.25kg MAX. WITH LATCH DEPRESSED.
 - WITHDRAWAL FORCE: 4.5kg MAX. WITH LATCH DEPRESSED.
 - OPERATING TEMPERATURE: -30℃ ~ +70℃.
- MARKING: MARK "Ⓢ" INSIDE OF THE CONNECTOR.
- PACKAGING : TAPE & REEL.
- TO CONFORM TO SINGATRON HAZARDOUS SUBSTANCE FREE SPEC
- HALOGEN FREE PRODUCT IDENTIFICATION
- MARK ON PRODUCT: ○
- HALOGEN FREE PRODUCT IDENTIFICATION LOGO ON THE PACKAGING: Ⓢ
- FOR REFLOW SOLDERING LEAD-FREE PROCESS.
- PRINTED DATE CODE "YY MM DD " ON TOP OF THE CONNECTOR.

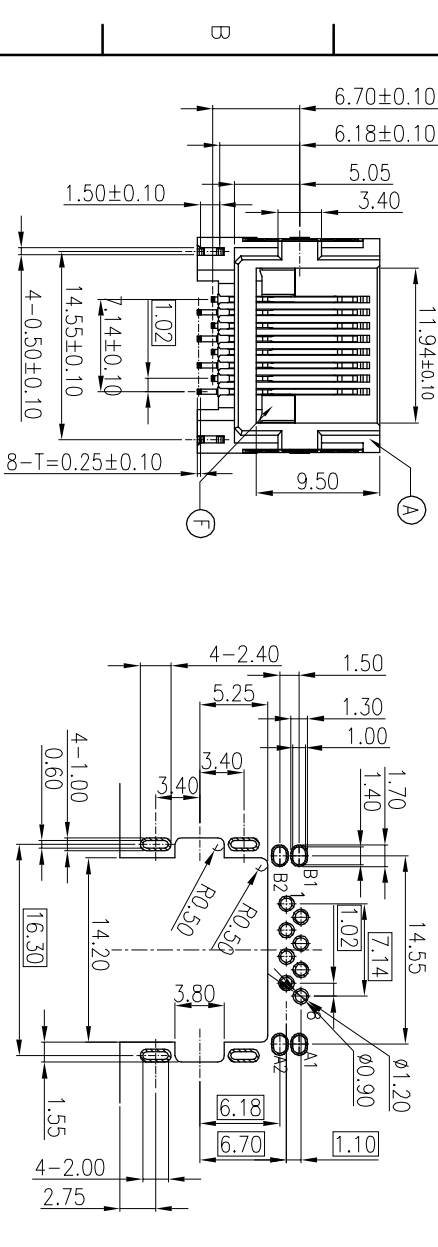
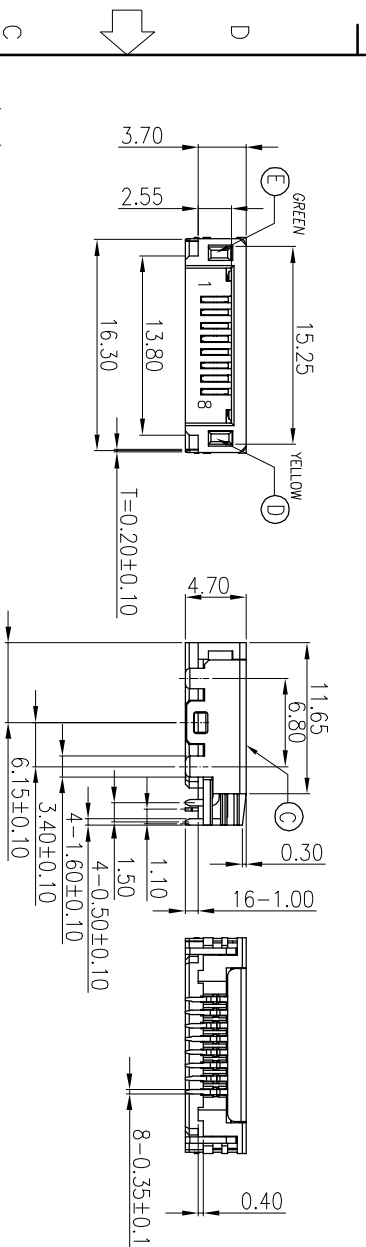
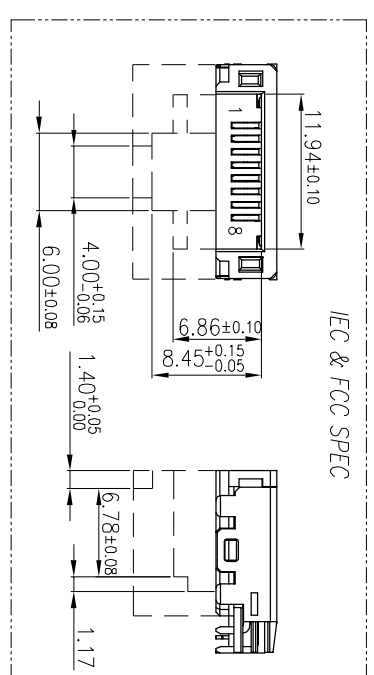

RECOMMENDED PCB LAYOUT
TOP VIEW : TOL.±0.05
(PCB THICKNESS=1.00mm)

| NODE | COLOR | Wavelength |
|-------|-------------|---------------------------|
| A1(+) | RED(-) | AI-#-A2 1M 585-594 |
| B1(+) | GREEN | BI-#-B2 1M 565-574 |
| F | STOP | 2 |
| E | LED 2 | HIGH TEMP.THERMOPLASTIC |
| D | LED 1 | GREEN |
| C | SHELL | YELLOW |
| B | TERMINAL | STAINLESS STEEL |
| A | HOUSING | PHOSPHOR BRONZE |
| NO | DESCRIPTION | 8 PHOSPHOR BRONZE |
| | | 1 HIGH TEMP.THERMOPLASTIC |
| | | 1 UL 94V-0 & BLACK |

UNLESS OTHERWISE SPECIFIED TOLERANCES

DECIMALS: ANGLES:

| TITLE | R445 JACK |
|-------|----------------------------------|
| DWN | PAN PART NO. 2RJ3081-1H8211F |
| CHKD | JAMES SCALE 4:1 UNIT: mm |
| APVD | BOYE SIZE: A3 SHEET: OF 2 REV: B |

Singatron Enterprise Co., Ltd.
信音企業股份有限公司

CUSTOMER COPY

