

# 2.0mm (0.079") Pin Header

Straight, 1.5mm Base  
(Dual Row, SMT Type)

1202M Series

## APPLICATION AND FEATURES

1. Side and end stackable (on unbroken edges).
2. Notches for easy breakable.
3. Variable pin length, gold, selective gold or tin plated.
4. Standoffs facilitate post soldering clean.
5. Mate with P.C.Board connectors such as 1212, 1213, 1312, 1215 & 1206 series.
6. RoHS compliant.

## SPECIFICATIONS

|                          |                           |
|--------------------------|---------------------------|
| Current Rating:          | 2 Amp                     |
| Insulator Resistance:    | 3000 Megohms min.         |
| Contact Resistance:      | 20 m ohm Max.             |
| Dielectric Withstanding: | AC 500V                   |
| Operating Temperature:   | -40°C to +105°C           |
| Max Processing Temp:     | 245±5°C for 3-5 seconds   |
| Contact Material:        | Brass                     |
| Insulator Material:      | Nylon 6T, UL 94V-0, Black |

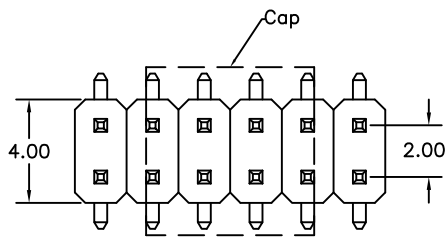

Recommended P.C.Board  
Hole Layout

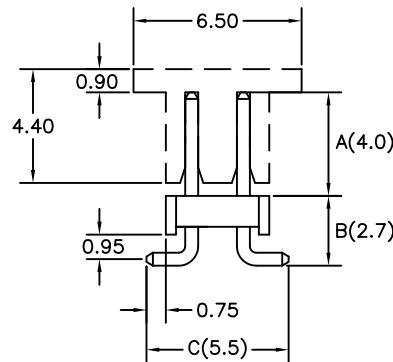
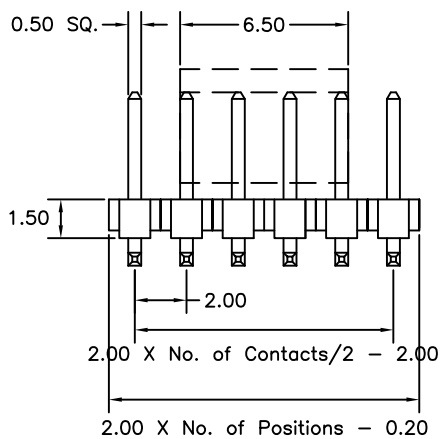
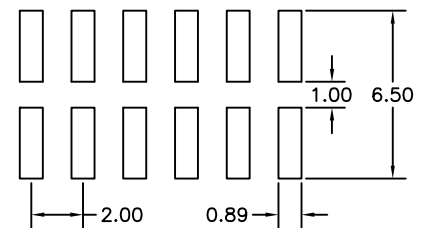

Tolerance: ±0.30mm

## Order Information 1202M Series

Example: 1202M-34-NS1-02-A/B/C-0-PT

| Series No. | Number of Contacts | Connector Type | Contact Plating | Pin Length mm |
|------------|--------------------|----------------|-----------------|---------------|
| 1202M      | 04 to 80 Contacts  | Straight NS1   | Tin Plated 01   | A B C         |
|            |                    |                | Gold Plated     | 4.0 2.7 5.5   |
|            |                    |                | Flash 02        |               |
|            |                    |                | 10 μ" 10        | Null: Tube    |
|            |                    |                | 30 μ" 30        | P: Cap+Tube   |
|            |                    |                |                 | PT: Cap+T&R   |