

2.0mm (0.079") Female Header

Dual Entry
(Double Row)

1216 Series

APPLICATION AND FEATURES

1. Dual entry low profile 4.3mm height.
2. Standoffs facilitate post soldering clean.
3. Mate with 2.0mm grid Dual Row male header such as 1202 & 1204D series.
4. RoHS compliant.

SPECIFICATIONS

Current Rating:	1 Amp
Insulator Resistance:	1000 Megohms min.
Contact Resistance:	30 m ohm Max.
Dielectric Withstanding:	AC 800 V
Operating Temperature:	-40°C to +105°C
Max Processing Temp:	230°C for 30 seconds and 260°C for 5 seconds
Contact Material:	Phosphor Bronze
Insulator Material:	Nylon 6T, UL 94V-0

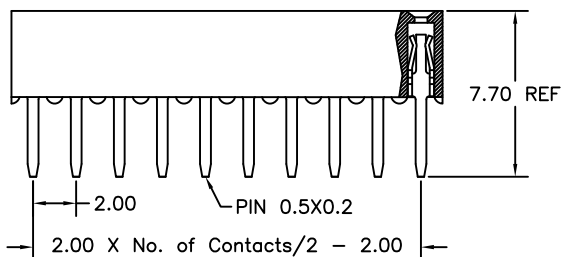

Recommended P.C.Board Hole Layout

Type 5

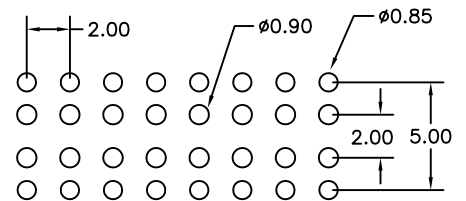
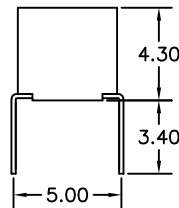
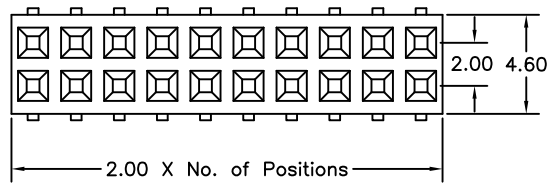

Type 6

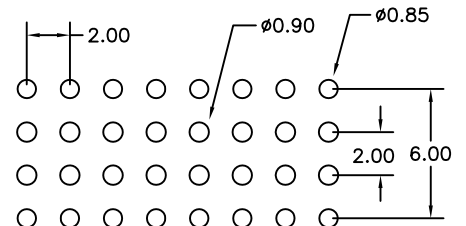
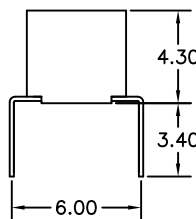
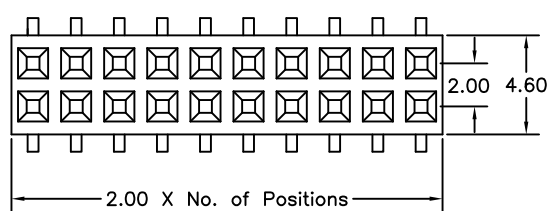

Tolerance: ±0.30mm

Order Information 1216 Series

Example: 1216 - 5 - 20 - 02

Series No.	Pitch Type	Number of Contacts	Contact Plating
1216	Pitch Code	04 to 80 Contacts	Tin Plated 01
	5.0mm 5		Gold Plated
	6.0mm 6		Flash 02
			10 μ" 10
			30 μ" 30