

2.0mm (0.079") SMT Pin Header

(Double Row)

1302 Series

APPLICATION AND FEATURES

1. Variable pin length, gold or tin plated.
2. Mate with 2.0mm pitch P.C.Board
Female Connector such as 1212, 1213, 1215, 1218, 1312, 1731 & 1732 series.
3. RoHS compliant.

SPECIFICATIONS

Current Rating:	2 Amp
Insulator resistance:	1000 Megohms min.
Dielectric withstanding:	500V AC/DC
Operating Temperature:	-40° to +105°C
Max Processing Temp:	230°C for 30 seconds (260°C for 5 seconds)
Contact Material:	Copper Alloy
Insulator Material:	High Temperature Thermoplastic, UL 94V-0

Recommended P.C.Board
SMD Layout

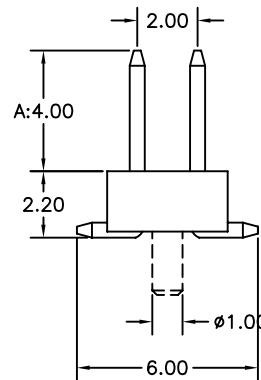
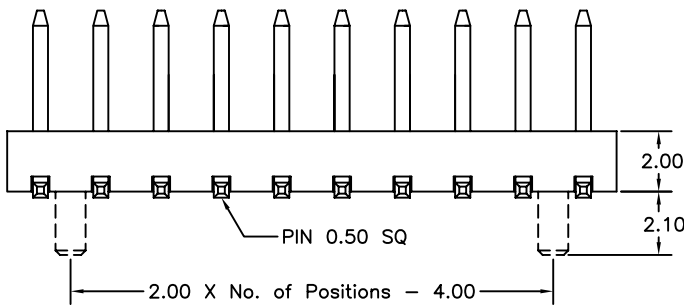
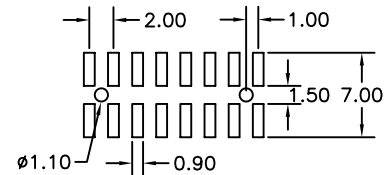
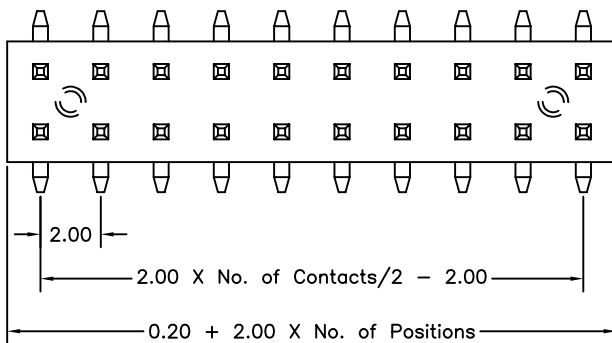

Order Information 1302 Series

Example: 1302 - 20 - S4 - 02 - 4.0 - 1 - G

