

# 2.0mm (0.079") Shrouded Header

1305 Series

## APPLICATION AND FEATURES

1. Assures reliable flat cable-to-P.C.Board interconnection.
2. Fully shrouded.
3. No ejector latches is for saving space.
4. RoHs compliant.

## SPECIFICATIONS

Current Rating: 1 Amps  
 Insulator Resistance: 1000 Megohms Min.  
 Dielectric Withstanding: AC 800V  
 Operating Temperature: -40°C to +105°C  
 Max Processing Temp: 230° for 30 seconds  
 (260° for 5 seconds)  
 Contact Material: Copper Alloy  
 Insulator Material: Nylon 9T (UL 94V-0)

Recommended P.C.Board  
SMD Layout

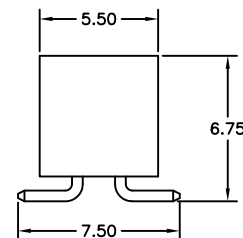
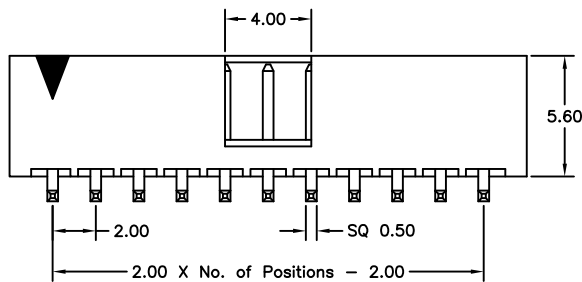
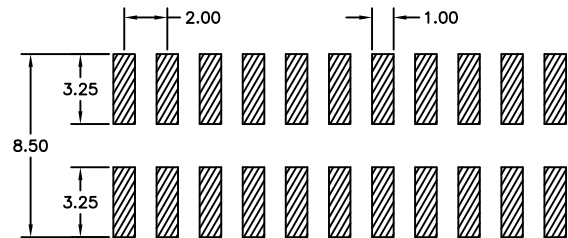
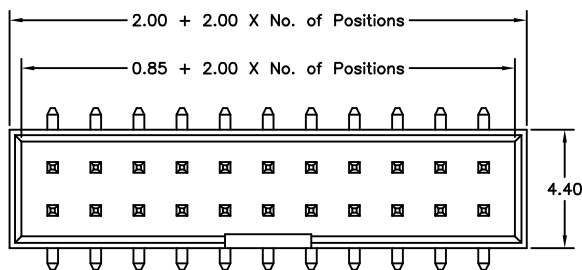

Tolerance:  $\pm 0.30\text{mm}$

## Order Information 1305 Series

Example: 1305-18-M-02-PT

Series No.	Number of Contacts	Connector Type	Contact Plating	Null: Tray
1305	8,10,12,14,16,18,20,24,26,28,30,32,44,50	SMT M	Tin Plated 01	P: Cap+Tube
			Gold Plated	PT: Cap+T&R
			Flash 02	
			10 $\mu$ " 10	
			30 $\mu$ " 30	