

2.0mm (0.079") Shrouded Header

1307 Series

APPLICATION AND FEATURES

- Mate with 2.0mm pitch P.C.Board Female Connector and shunt connector.
- RoHS compliant.

SPECIFICATIONS

Current Rating: 1 Amps
 Insulator resistance: 1000 Megohms Min.
 Dielectric withstanding: AC 800V for 1 minute.
 Operating Temperature: -55°C to +105°C
 Max. Processing Temp.: 230°C for 30 seconds.
 (260°C for 5 seconds)

Contact Material: Brass
 Insulator Material: Nylon 6T, UL 94V-0

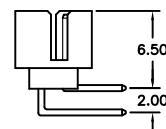
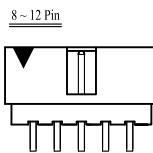
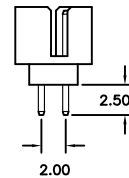
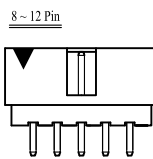
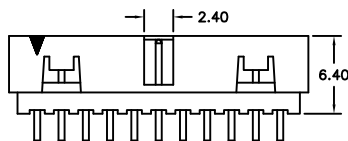
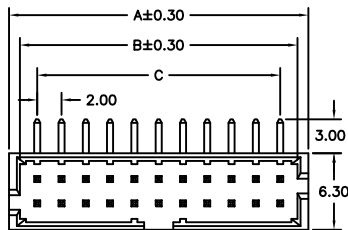
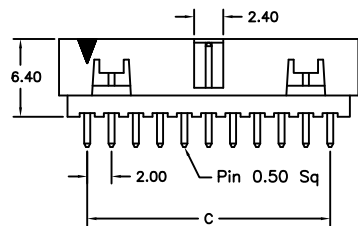
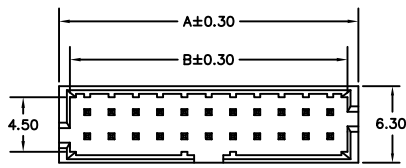

Recommended P.C.Board Hole Layout

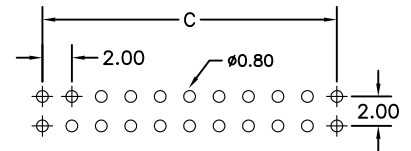

No. of Contacts	DIMENSION		
	A	B	C
8	10.65	8.85	6.00
10	12.65	10.85	8.00
12	14.65	12.85	10.00
14	16.65	14.85	12.00
16	18.65	16.85	14.00
20	22.65	20.85	18.00
24	26.65	24.85	22.00
26	28.65	26.85	24.00
30	32.65	30.85	28.00
34	36.65	34.85	32.00
40	42.65	40.85	38.00
44	46.65	44.85	42.00
50	52.65	50.85	48.00

Order Information 1307 Series

Example: 1307-34-S-02

Series No.	Number of Contacts	Connector Type	Contact Plating
1307	8,10,12,14,16,20,24 26,30,34,40,44,50	Straight <input type="checkbox"/> S Right Angle <input type="checkbox"/> R	Tin Plated <input type="checkbox"/> 01 Gold Plated Flash <input type="checkbox"/> 02 10 μ" <input type="checkbox"/> 10 30 μ" <input type="checkbox"/> 30