

2.0mm (0.079") SMT Female Header

(Single Row)

1311 Series

APPLICATION AND FEATURES

1. Low Profile: 4.5mm height.
2. High quality dual beam phosphor bronze contacts.
3. Mating with 2.0mm pitch 0.5mm Pin Headers, such as 1201 & 1204S series.
4. RoHS compliant.

SPECIFICATIONS

| | |
|--------------------------|---|
| Current Rating: | 2 Amp |
| Insulator Resistance: | 1000 Megohms min. |
| Contact Resistance: | 20 m ohm Max. |
| Dielectric Withstanding: | 500V AC |
| Operating Temperature: | -40°C to +105°C |
| Max Processing Temp: | 230°C for 30 seconds and 260°C for 5 seconds |
| Contact Material: | Phosphor bronze |
| Insulator Material: | Nylon 6T, UL 94V-0, Black |

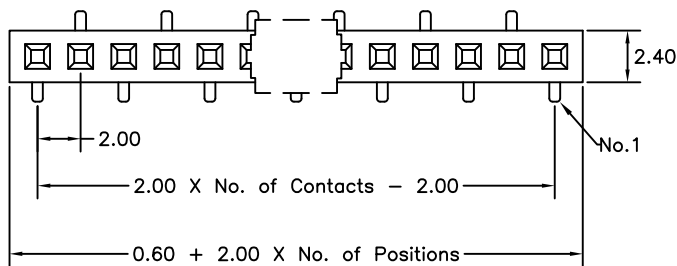

Recommended P.C.Board
SMD Layout

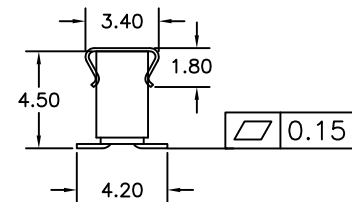
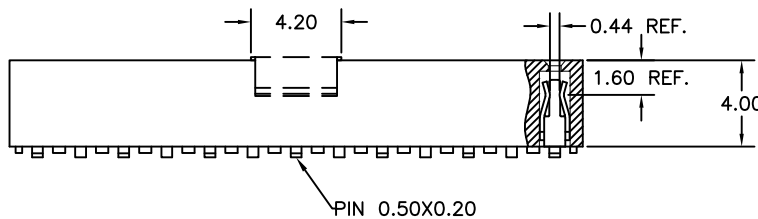
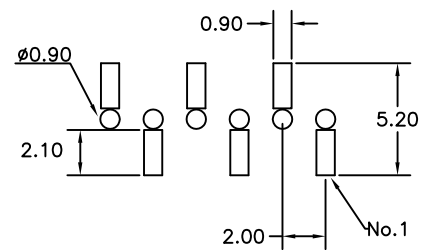

Tolerance: ±0.30mm

Order Information 1311 Series

Example: 1311-20-B1-02-PT-G

| | | | | |
|------------|--------------------|----------------|-----------------|-------------|
| Series No. | Number of Contacts | Foot Rank Type | Contact Plating | Null: Tube |
| 1311 | 03 to 40 Contacts | B1 | Tin Plated 01 | P: Cap+Tube |
| | | | Gold Plated | PT: Cap+T&R |
| | | | Flash 02 | |
| | | | 10 μ" 10 | |
| | | | 30 μ" 30 | |