

2.54mm (0.1") Shrouded Header

(Double Row 13.9mm Base)

2305 Series

APPLICATION AND FEATURES

1. Standoffs facilitate post solder cleaning.
2. Suggestion mating with 2235 & 6101 series.
3. RoHS compliant.

SPECIFICATIONS

Current Rating: 3 Amps
 Insulator resistance: 5000 Megohms Min.
 Dielectric withstanding: AC 500 V
 Operating Temperature: -40°C to +105°C
 Contact Material: Brass
 Insulator Material: Polyester, UL 94V-0
 © Standard: P.B.T

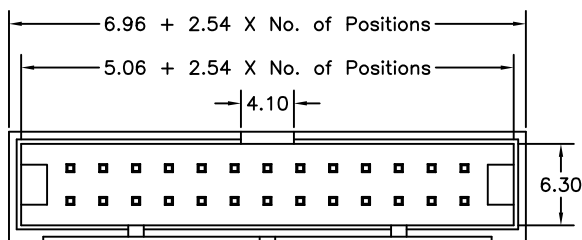

Recommended P.C.Board Hole Layout

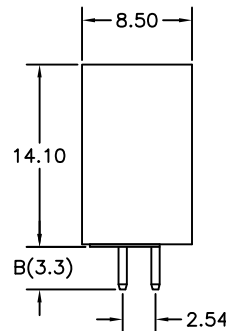
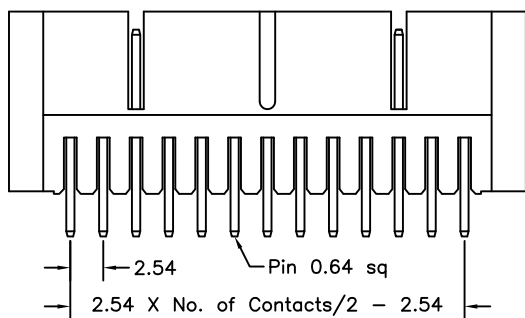
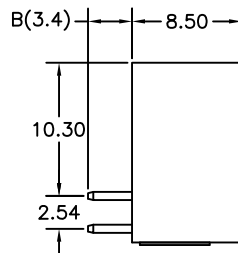
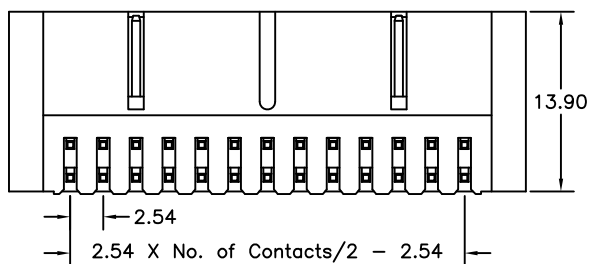
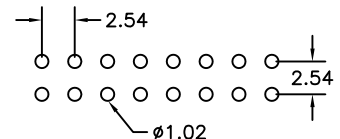

Order Information 2305 Series

Example: 2305-20-S-02-3.3

Series No.	Number of Contacts	Connector Type	Contact Plating	Pin Length mm
2305	10,14,16,20,26,30,34 40,50,60,64	Straight S Right Angle R	Tin Plated 01 Gold Plated Flash 02 10 μ" 10 30 μ" 30	S-B R-B 3.3 3.4