

2.54mm × 7.87mm(0.1"×0.31") Female Header

Side Entry Type

2905 Series

APPLICATION AND FEATURES

1. High reliable dual-beam phospher bronze contact.
2. Designed for right-Angle P.C.Board mounting.
3. Pin stop to prevent shorting circuits between rows.
4. Mates with P.C.Board connectors such as 2901 & 2903 series.
5. RoHS Compliant.

SPECIFICATIONS

Current Rating:	3 Amps
Insulator Resistance:	1000 Megohms min.
Contact Resistance:	20 Megohms Max.
Dielectric Withstanding:	AC 600 V
Operating Temperature:	-40°C to +105°C
Contact Material:	Phosphor bronze
Insulator Material:	Polyester,UL 94V-0
	©Standard:P.B.T



Recommended P.C.Board Hole Layout

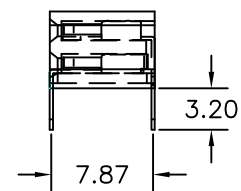
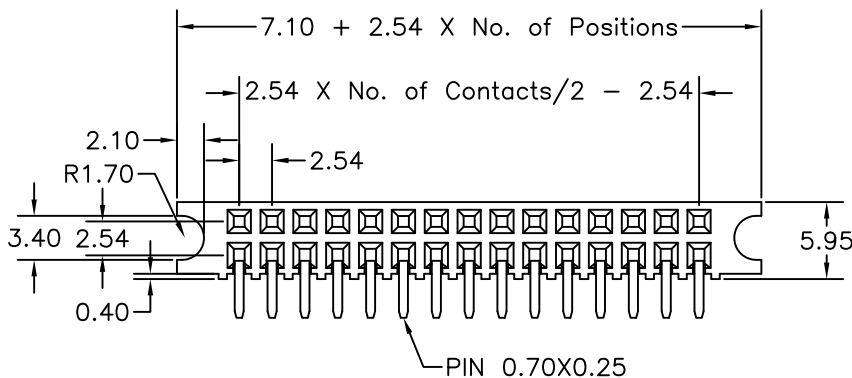
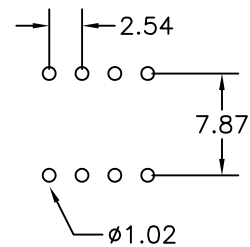

Order Information 2905 Series

Example: 2905 - 30 - R - 02 - G

Series No.	Number of Contacts	Connector Type	Contact Plating
2905	10~80	Right Angle R	Tin Plated 01
			Gold Plated
			Flash 02
			10 μ" 10
			30 μ" 30