

RECOMMENDED
PANEL CUT-OUT

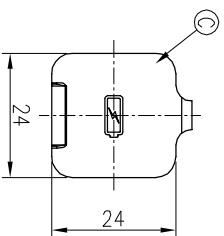
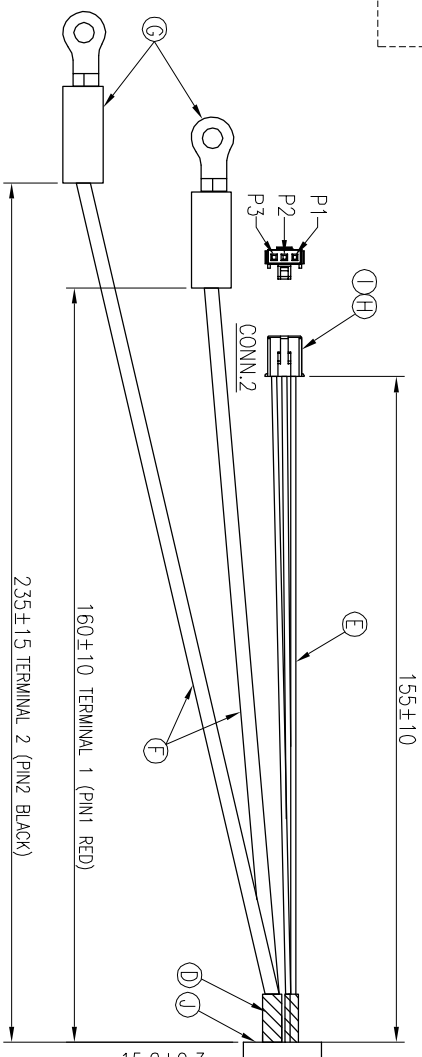

MATCH SCREW M2.5

PURPLE(26#)	5	3	/	CAN_L
BLUE(26#)	4	2	/	CAN_H
YELLOW(26#)	3	1	/	DET
BLACK(14#)	2	/	TERMINAL 2	P-
RED(14#)	1	/	TERMINAL 1	P+

- NOTES:
1. WATERPROOF RATE: IP67 WHEN MATED IP67: IMMERSED IN 1M WATER FOR 30 MINUTES.
 2. ELECTRICAL CHARACTERISTICS
 3. CURRENT RATING: 20+2A
 4. TO CONFORM TO SINGATRON HAZARDOUS SUBSTANCE FREE SPEC.
 5. GREEN PRODUCT IDENTIFICATION LABEL ON PACKAGING: **GM 7450**
 6. LIFE TEST: 1,000 CYCLES Min.

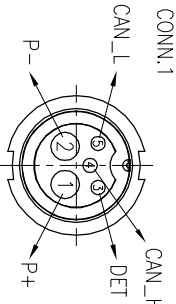
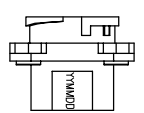

- DATE CODE: YYMMDD
- DAY MONTH YEAR

J	GLUE	1	N/A	BLACK
I	TERMINAL	3	CvLux C106T011PE0	TIN-PLATING
H	HOUSING	1	CvLux C1060350000	WHITE
G	0-TERMINAL	2	KST RV52-4	BLUE
F	WIRE	2	UL3266 14AWG	SEE PIN OUT
E	WIRE	3	UL1430 26AWG	SEE PIN OUT
D	HEAT SHRINK TUBE	5	N/A	BLACK
C	CAP	1	EPDM	BLACK
B	FEMALE PIN	5	PHOSPHOR BRONZE	GOLD PLATING OVER NICKEL PLATING
A	BODY	1	PLASTIC	BLACK

UNLESS OTHERWISE SPECIFIED TOLERANCES

DECIMALS: ANGLES:

X :±0.5 X :±2°

X.X :±0.3 X.X :±1°

X.XX :±0.2

Suzhou Singatron Auto Electronics CO.,LTD.
蘇州信營汽車電子有限公司

CM SERIES 180° MALE CONN. FEMALE (2+3) PIN

TITLE: **PART NO.2CM3020-W05EA2H**

DWN MF

CHKD JF

APVD STEVE

SCALE 1:1 UNIT: mm

SIZE: A3 SHEET: 1 OF 1 REV: B

CUSTOMER COPY

REV.	ECN NO.	OR DESCRIPTION	REVISED	DATE
A	PDR NO.:	T200622-1A	MF	2022.06.20
B	ECN NO.:	S2022209-C15	MF	2022.11.09