

REV.	ECN NO OR DESCRIPTION	REVISED	DATE
A	PDR NO.:T200525-2B	JAY	2021.05.31

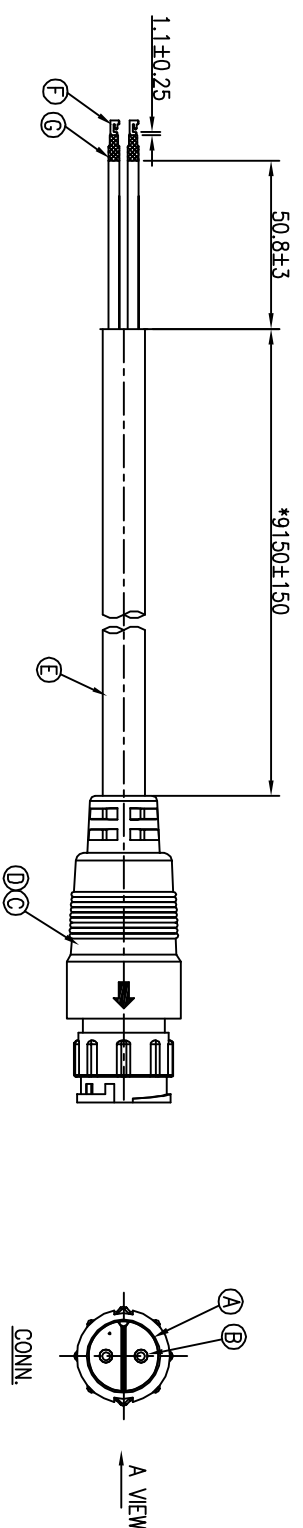

DELTA PART NO	REV	PART NO
3082402600	01	2CM3024-W02407H

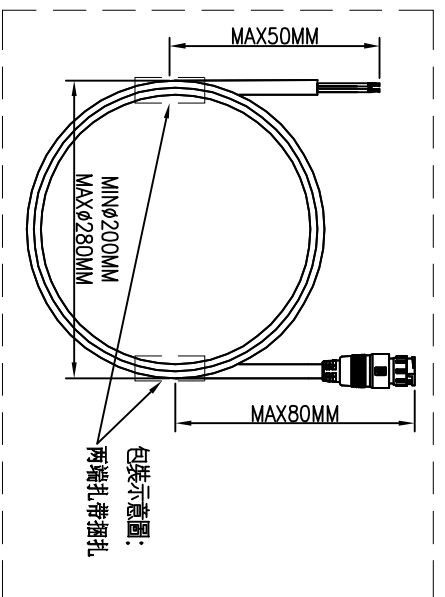
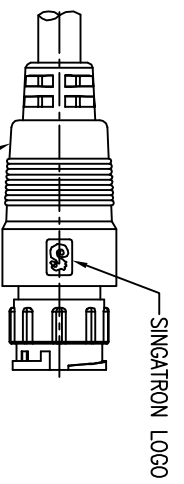

2	BLACK
1	RED
CONN. WIRE COLOR	
PIN OUT	
CONN.	

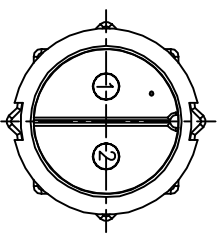

- NOTES:
- MUST MEET DELTA'S GENERAL SPEC.: 10000-0031, 10000-0038, 10000-0162
 - CABLE TIE MUST MEET TEST: TEST CONDITION:W=8 Kgf, HOLD TIME:1 MIN CRITERIA WIRE SHIFT<2MM.

G	SHRINK TUBE	2	φ4.0	BLACK
F	TERMINAL	2	TE:62109-2	BRASS/TIN
E	CABLE	1	SJTW 14AWG*2C	BLACK
D	INNER MOLD	1	TPU	NATURAL
C	OVER MOLD	1	PVC	BLACK
B	MALE PIN	2	BRASS	(1~3)μ" GOLD PLATING OVER NICKEL PLATING
A	BODY	1	NYLON+GF	BLACK
NO	DESCRIPTION	QTY	MATERIAL	PLATING & COLOR

UNLESS OTHERWISE SPECIFIED TOLERANCES

Suzhou Singatron Auto Electronics CO.,LTD.
蘇州信營汽車電子有限公司

TITLE: CIRCULAR MIDDLE SIZE (IP67)
MALE CONN. MALE PIN 2 PIN(104) LOCK TYPE

DECIMALS: ANGLES: DWN JAY PART NO. 2CM3024-W02407H
X.XX :±0.5 X :±2
X.X :±0.3 X.X :±1'
X.XX :±0.2

CHKD JF SCALE 1:1 UNIT: mm
APVD Steve SIZE: A3 SHEET:1 OF 1 REV: A

CUSTOMER COPY