

REV.	ECN NO OR DESCRIPTION	REVISED	DATE
A	PDR NO.:S100118-1C	LILY	2010.04.19
B	ECN NO.:S110408	LILY	2011.05.24

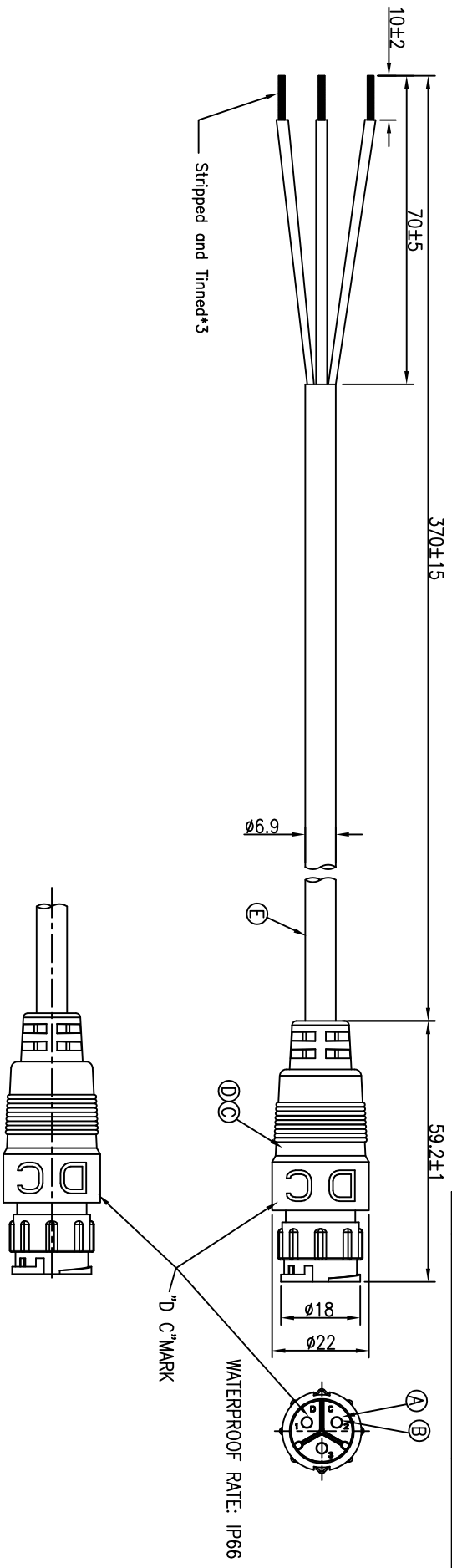

YELLOW/GREEN	3
BLUE	2
BROWN	1
WIRE COLOR	CONN.
PIN OUT	

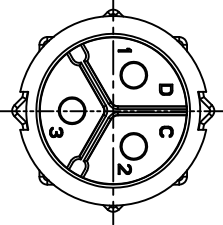

Pin Assignments  
Front View

- NOTES:
1. WATERPROOF RATE: IP66
  2. CURRENT RATING: 10A
  3. SPECIFICATIONS:SEE "CIRCULAR SERIES SPECIFICATIONS".
  4. TO CONFORM TO SINGATRON HAZARDOUS SUBSTANCE FREE SPEC.
  5. GREEN PRODUCT IDENTIFICATION LABEL ON PACKAGING:



NO	DESCRIPTION	QTY	MATERIAL	PLATING & COLOR
A	BODY	1	NYLON+30%GF 94V-0	BLACK
B	MALE PIN	3	BRASS	(1~3)u" GOLD PLATING OVER NICKEL PLATING
C	OVER MOLD	1	PVC VW-1	BLACK
D	INNER MOLD	1	ABS 94V-0	NATURAL
E	CABLE	1	245 IEC 57(YZW) 3*0.75mm <sup>2</sup> (RESISTANT UV)	BLACK

UNLESS OTHERWISE SPECIFIED TOLERANCES:

DECIMALS:	ANGLES:
X :±0.5	X :±2°
X.X :±0.3	X.X :±1°
X.XX :±0.2	

Singatron Enterprise Co., Ltd.  
信音企業股份有限公司  
CIRCULAR MIDDLE SIZE (IP66)  
MALE CONN. MALE 3 PIN LOCK TYPE

TITLE: PART NO. 2CM3024-W03403  
DWN: LILY  
CHKD: Steve  
APVD: Quan

SCALE: 1:1 UNIT: mm  
SIZE: A3 SHEET: 1 OF 1 REV: B

CUSTOMER COPY