

| | | | |
|------|-----------------------|---------|------------|
| REV. | ECN NO OR DESCRIPTION | REVISED | DATE |
| A | PDR NO:S101116-7A | LILY | 2010.11.24 |

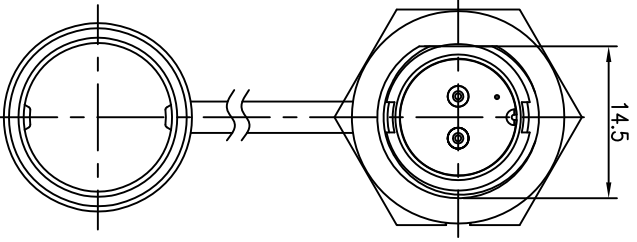

| | | | |
|--|---------|--------------|---------|
| | CONN. 1 | WIRE COLOR | CONN. 2 |
| | | WHITE/ORANGE | 1 |
| | | ORANGE | 2 |
| | | WHITE/GREEN | 3 |
| | | BLUE | 4 |
| | | WHITE/BLUE | 5 |
| | | GREEN | 6 |
| | | WHITE/BROWN | 7 |
| | | BROWN | 8 |

CONN. 1
PIN OUT

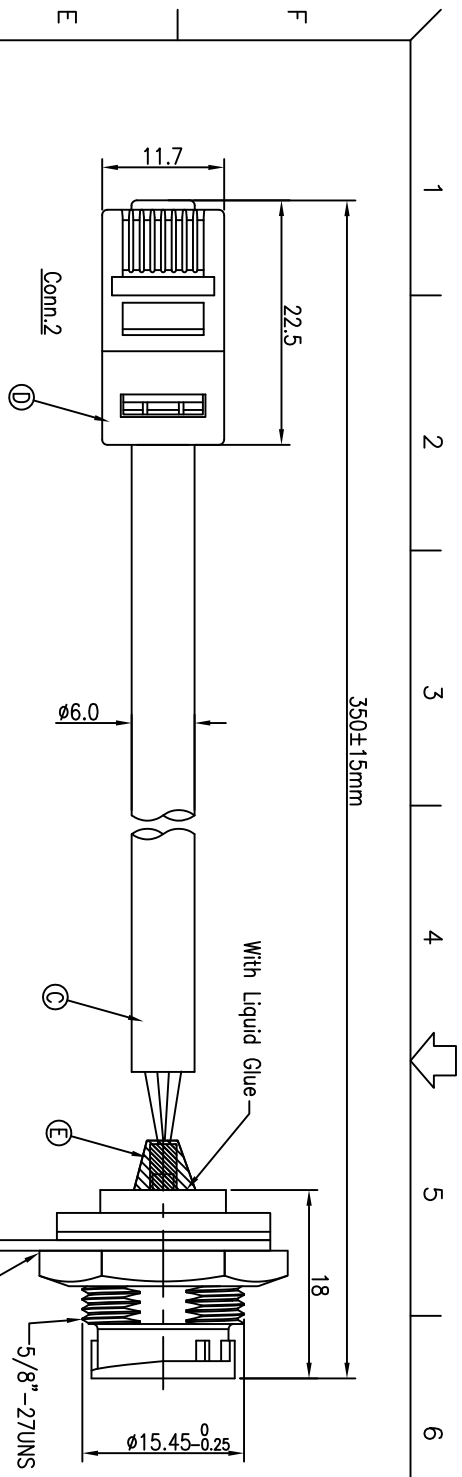
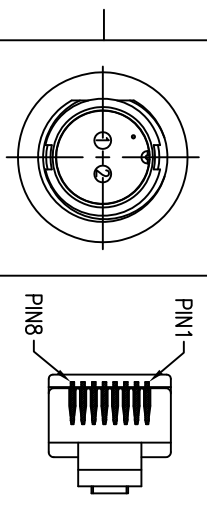

Pin Assignments
Front View

- NOTES:
1. WATERPROOF RATE: IP67
IP67: IMMERSED IN 1M WATER FOR 30 MINUTES
 2. CURRENT RATING: 5A
 3. SPECIFICATIONS:SEE "CIRCULAR SERIES SPECIFICATIONS".
 4. TO CONFORM TO THE SINGATRON HAZARDOUS SUBSTANCE FREE SPEC.
 5. GREEN PRODUCT IDENTIFICATION LABEL ON PACKAGING:

| | | | |
|---|---------------------------------------|---------|---|
| E | Liquid Glue | 1 | |
| D | RL45 PLUG | 1 | CRK P/N:NS4311-003-01 |
| C | CABLE | 1 | PVC JACKET CAT5E FTP 24#*4P+MY+D+A/M |
| B | Waterproof Cap | 1 | P/N:2CT3000-W0000W |
| A | Waterproof Conn. | 1 | P/N:2CT3002-W02300 |
| NO | DESCRIPTION | QTY | MATERIAL |
| | UNLESS OTHERWISE SPECIFIED TOLERANCES | | PLATING & COLOR |
| | DECIMALS: | ANGLES: | |
| X | :±0.5 | X | :±2° |
| X:X | :±0.3 | X:X | :±1° |
| X:XX | :±0.2 | | |
| Singatron Enterprise Co., Ltd. 信音企業股份有限公司 CIRCULAR STANDARD SIZE (SOLDER TYPE) MALE CONN. MALE 2PIN PART NO.2CT3002-W02302 SCALE 2:1 UNITS: mm SHEET:1 OF 1 REV: A CUSTOMER COPY | | | |