

REV.	ECN NO	OR DESCRIPTION	REVISED	DATE
A	PDR NO:S140526-8N	YF		2014.07.31

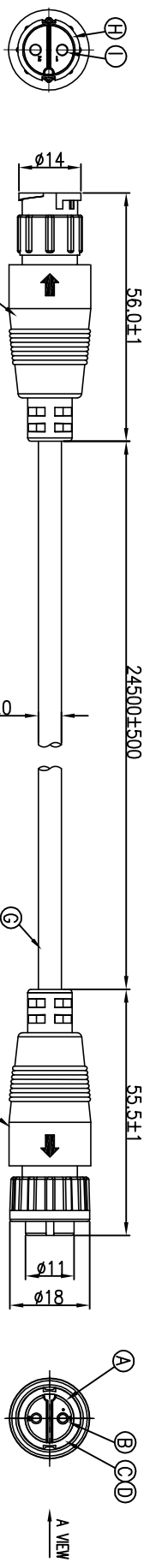

CONN. WATERPROOF RATE: IP67

CONN. WATERPROOF RATE: IP67



2	BLACK	2
1	BROWN	1
CONN.2	WIRE COLOR	CONN.1

PIN OUT

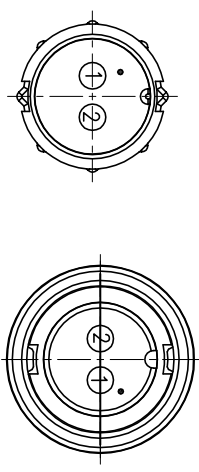

Pin Assignments

Pin Assignments

- NOTES:
1. WATERPROOF RATE: IP67
  2. CURRENT RATING: 10A
  3. SPECIFICATIONS:SEE "CIRCULAR SERIES SPECIFICATIONS".
  4. TO CONFORM TO SINGATRON HAZARDOUS SUBSTANCE FREE SPEC.
  5. GREEN PRODUCT IDENTIFICATION LABEL ON PACKAGING: RoHS

I	MALE PIN	2	BRASS	1~3u" GOLD PLATING OVER NICKEL PLATING
H	BODY	1	NYLON+33%GF	BLACK
G	CABLE	1	H05RN-F 2*1.0MM² (UV RESISTANT)	BLACK(PVC JACKET)
F	INNER MOLD	2	TPU	NATURAL
E	OVER MOLD	2	PVC	BLACK
D	O-RING	1	EPDM	BLACK
C	LOCK NUT	1	NYLON+33%GF	BLACK
B	FEMALE PIN	2	Phosphor Bronze CS441	1~3u" GOLD PLATING OVER NICKEL PLATING
A	BODY	1	NYLON+33%GF	BLACK
NO	DESCRIPTION	QTY	MATERIAL	PLATING & COLOR
UNLESS OTHERWISE SPECIFIED TOLERANCES				
DECIMALS: ANGLES: X :±0.5 X :±2° X.X :±0.3 X.X :±1° X.XX :±0.2				
TITLE: CIRCULAR STANDARD SIZE (IP67) FEMALE CONN. TO MALE CONN. LOCK TYPE				
DWN	YF	PART NO.	2CT3004-W02407H	
CHKD	Harden	SCALE	2:1	UNIT: mm
APVD	Steve	SIZE: A3	SHEET: 1 OF 1	REV: A

CUSTOMER COPY