

REV.	ECN NO.	OR DESCRIPTION	REVISED	DATE
A	PDR NO:S110114-4B		LLY	2011.02.22
B	ECN NO.:S110408 / $\Delta$		LLY	2011.05.27

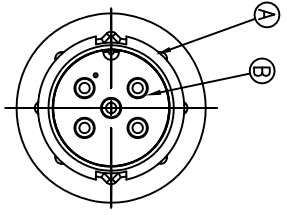

YELLOW/GREEN	5
PURPLE	4
BLACK	3
BLUE	2
BROWN	1
WIRE COLOR	CONN.
PIN OUT	

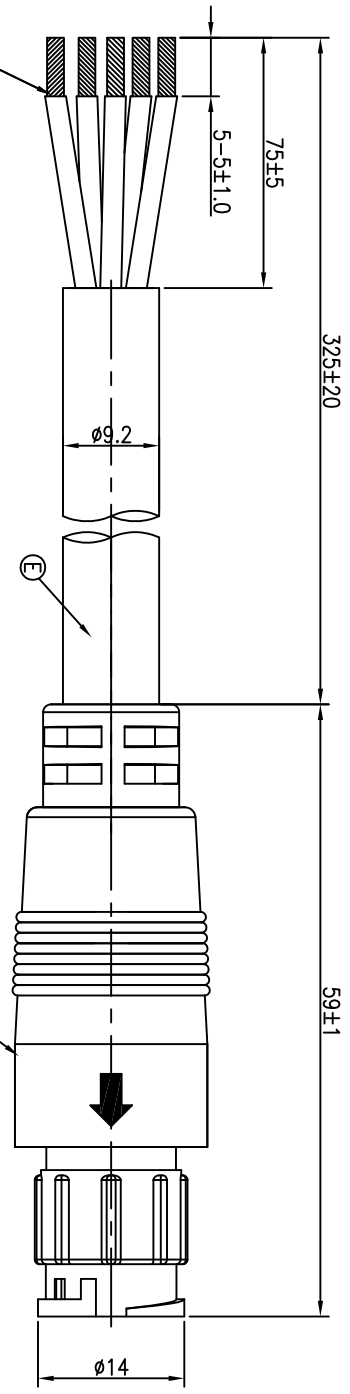
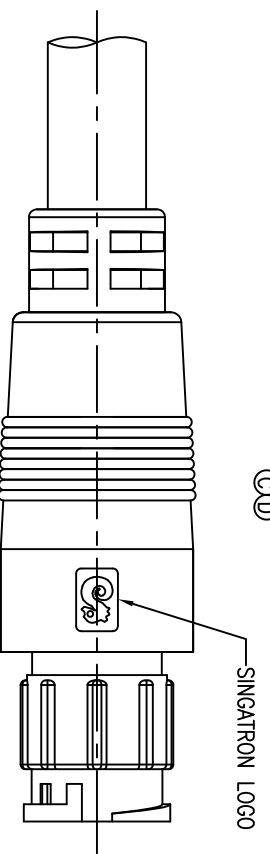

- NOTES:
1. WATERPROOF RATE: IP65
  2. SPECIFICATIONS:SEE "CIRCULAR SERIES SPECIFICATIONS".
  3. TO CONFORM TO SINGATRON HAZARDOUS SUBSTANCE FREE SPEC.
  4. GREEN PRODUCT IDENTIFICATION LABEL ON PACKAGING:

NO	DESCRIPTION	QTY	MATERIAL	PLATING & COLOR
E	CABLE	1	245 IEC 57(YZW)5*1.0 mm <sup>2</sup> 0D9.2	BLACK (RUBBER)
D	INNER MOLD	1	PVC	BLACK
C	OVER MOLD	1	PVC	BLACK
B	MALE PIN	5	BRASS	6u" GOLD PLATING OVER NICKEL PLATING
A	BODY	1	PA66+30%GF 94V-0 (MAPEX A0620NH B06)	BLACK

UNLESS OTHERWISE SPECIFIED TOLERANCES

DECIMALS:	ANGLES:
X :±0.5	X :±2°
X.X :±0.3	X.X :±1°
X.XX :±0.2	

Singatron Enterprise Co., Ltd.  
信普企業股份有限公司  
CIRCULAR STANDARD SIZE (IP65)  
MALE CONN. MALE SPIN(SA) LOCK TYPE  
PART NO. 2CT3024-W05304  
SCALE 2:1 UNIT: mm  
SIZE: A3 SHEET: 1 OF 1 REV: B

CUSTOMER COPY