

REV	ECN NO OR DESCRIPTION	REVISED	DATE
A	PDR NO.:A191021-2A	Jun	2020.05.19

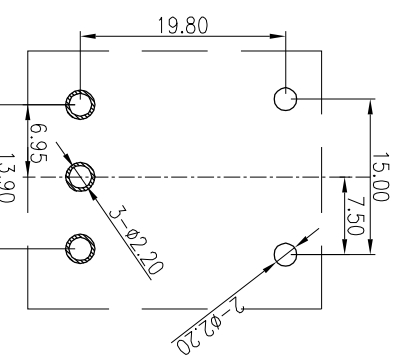

RECOMMENDED PCB LAYOUT
COMPONENT SIDE
(TOLERANCE: ±0.05)

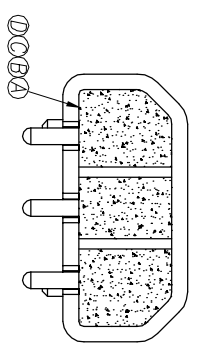
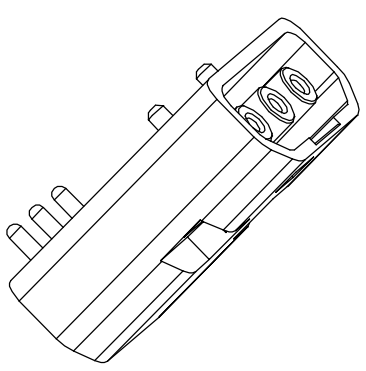
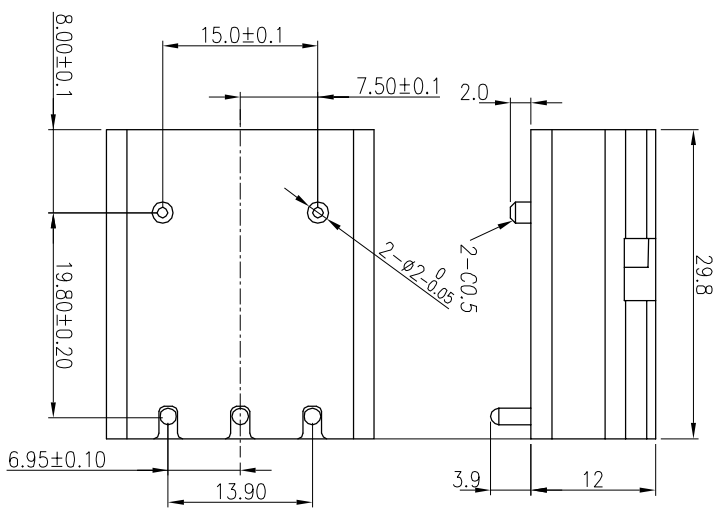
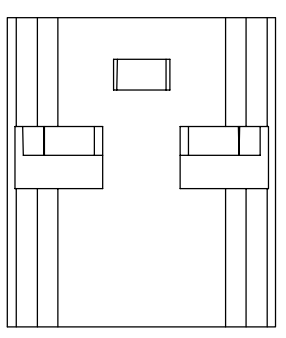
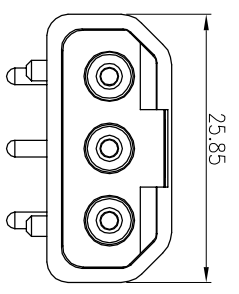

- NOTES:
- ELECTRICAL CHARACTERISTICS
TEMPERATURE RANGE: -40°C~80°C
CURRENT RATING: 10A
VOLTAGE RATING: 250V AC
 - TEST CONDITIONS:
INSULATION RESISTANCE: 100MΩMIN. BY 1000 VDC
 - OTHER GENERAL SPEC. TO REFER CIRCULAR SERIES SPEC."
 - TO CONFORM TO SINGATRON HAZARDOUS SUBSTANCE FREE SPEC.
 - GREEN PRODUCT IDENTIFICATION LABEL ON PACKAGING: **G.P. PASS**

NO	DESCRIPTION	QTY	MATERIAL	PLATING & COLOR
D	UV GLUE	1	N/A	N/A
C	GLUE	1	N/A	BLACK
B	FEMALE PIN	3	Phosphor Bronze	(1-3)100µm Plating Over Nickel Plating
A	BODY	1	Nylon	BLACK

UNLESS OTHERWISE SPECIFIED TOLERANCES

DECIMALS:	ANGLES:
X :±0.5	X :±2°
X.X :±0.3	X.X :±1°
X.XX :±0.2	

Singatron Enterprise Co., Ltd.
信譽企業股份有限公司

TITLE	POWER CONN
DWN	Jun
CHKD	Cerry
APVD	William
PART NO.	2CT3100-W00476H
SCALE	4:1
UNIT	mm
SIZE	A3
SHEET	1 OF 1
REV	A

CUSTOMER COPY