

RECOMMENDED PCB LAYOUT
COMPONENT SIDE
(TOLERANCE: ±0.05)

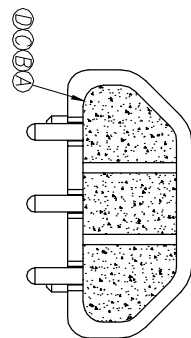
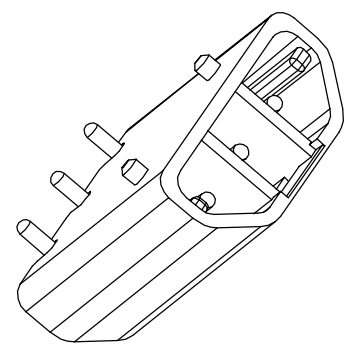
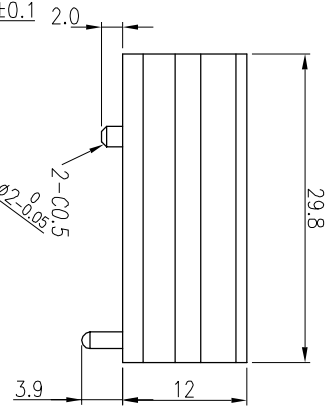
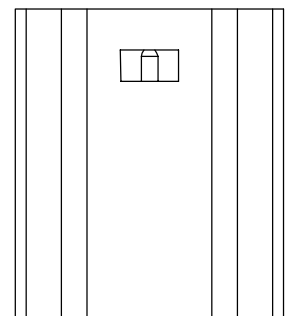
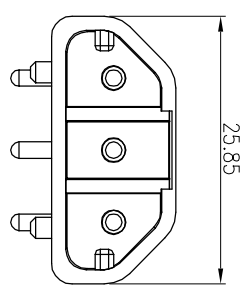

- NOTES:
- ELECTRICAL CHARACTERISTICS
TEMPERATURE RANGE: -40°C~80°C
CURRENT RATING: 10A
VOLTAGE RATING: 250V AC
 - TEST CONDITIONS:
INSULATION RESISTANCE: 100M Ω MIN. BY 1000 VDC
 - OTHER GENERAL SPEC. TO REFER CIRCULAR SERIES SPEC."
 - TO CONFORM TO SINGATRON HAZARDOUS SUBSTANCE FREE SPEC.
 - GREEN PRODUCT IDENTIFICATION LABEL ON PACKAGING: **G.P. PASS**

D	UV GLUE	1	N/A	N/A
C	GLUE	1	N/A	BLACK
B	MALE PIN	3	BRASS	(1-3)Black Plating Over Nickel Plating
A	BODY	1	NYLON	BLACK
NO	DESCRIPTION	QTY	MATERIAL	PLATING & COLOR
UNLESS OTHERWISE SPECIFIED TOLERANCES				
Singatron Enterprise Co., Ltd. 信登企業股份有限公司				
TITLE POWER CONN				
DWN	Jun	PART NO. 2CT3100-W00477H		
CHKD	Cerry	SCALE 4:1	UNIT: mm	
APVD	William	SIZE: A3	SHEET: 1 OF 1	REV: A

CUSTOMER COPY

REV	ECN NO OR DESCRIPTION	REVISED	DATE
A	PDR NO.:A191021-2B	Jun	2020.05.19

