

DETAIL-A
SCALE 2:1

Recommended PCB Layout
<TOP VIEW> TOLERANCE: ±0.05 A-A SIDE VIEW
(PCB THICKNESS: 1.5mm)

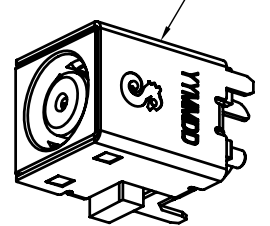

SPECIFICATIONS:

- ELECTRICAL CHARACTERISTICS:
 - RATING: 20V 13A
 - CONTACT RESISTANCE: 20mΩ MAX (INITIAL)
 - DIELECTRIC WITHSTANDING VOLTAGE: 150V AC FOR ONE MINUTE.
 - INSULATION RESISTANCE: 100MΩ MIN. MEASURED BY 500 VDC
- MECHANICAL CHARACTERISTICS:
 - INSERTION FORCE : 3.0 KGF Max.
 - WITHDRAWAL FORCE : 0.35 KGF Min.
- LIFE TEST: 5,000 CYCLES MIN.
- OTHER GENERAL SPEC. TO REFER "2DC1003-000113 SPEC"
- TO CONFORM TO SINGATRON HAZARDOUS SUBSTANCE FREE SPEC.
- GREEN PRODUCT IDENTIFICATION MARK ON JACK:
- GREEN PRODUCT IDENTIFICATION LABEL ON PACKAGING: **G.P. PASS**
- FOR REFLOW SOLDERING LEAD-FREE PROCESS.

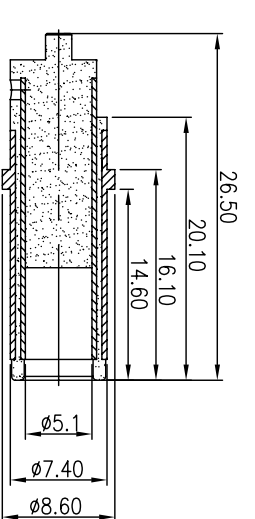

MATING PLUG: OD φ7.4 ; ID φ5.1
Loading 20V 13A for Singatron P/n:2DP1003-000111
(TOLERANCE:±0.05)

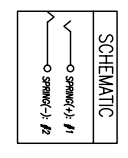

| REV. | ECN NO. | OR DESCRIPTION | REVISED | DATE |
|------|-----------------|----------------|------------|------|
| A | PRODUCT RELEASE | JASON | 2008.04.12 | |
| B | ECN NO: T080142 | Even | 2008.07.25 | |
| C | ECN NO:S100146 | Tom | 2010.01.26 | |

| NO | DESCRIPTION | QTY | MATERIAL | PLATING & COLOR |
|----|-------------|-----|--------------------------|--------------------------|
| E | SHELL | 1 | BRASS 0.35t | NICKEL(60u Min.) PLATING |
| D | SPRING (+) | 1 | COPPER ALLOY 0.3t | GOLD FLASH(~3u) PLATING |
| C | SPRING (-) | 1 | COPPER ALLOY 0.3t | GOLD FLASH(~3u) PLATING |
| B | COVER | 1 | HIGH TEMP. THERMOPLASTIC | BLACK COLOR |
| A | HOUSING | 1 | HIGH TEMP. THERMOPLASTIC | BLACK COLOR |
| NO | DESCRIPTION | QTY | MATERIAL | PLATING & COLOR |

UNLESS OTHERWISE SPECIFIED TOLERANCES

Singatron Enterprise Co., Ltd.
信音企業股份有限公司

| TITLE | DC POWER JACK |
|-------|------------------|
| DWN | Rev 2010.01.26 |
| CHKD | Jason 2010.01.26 |
| APVD | Tom 2010.01.26 |

PART NO. 2DC1003-000113
SCALE 3:1
UNIT: mm
SIZE: A3
SHEET: 1 OF 1
REV: C

CUSTOMER COPY