

SPECIFICATIONS:

- ELECTRICAL CHARACTERISTICS:
 - RATING: 42V 10A
 - CONTACT RESISTANCE: 20mΩ MAX.(INITIAL)
 - DIELECTRIC WITHSTANDING VOLTAGE: 150V AC FOR ONE MINUTE.
 - INSULATION RESISTANCE: 100MΩ MIN. MEASURED BY 500 VDC
- MECHANICAL CHARACTERISTICS:
 - INSERTION FORCE :3.0 KGF MAX
 - WITHDRAWAL FORCE : 0.35~3.5KGF
- LIFE TEST: 5,000 CYCLES MIN.
- OTHER GENERAL SPEC. TO REFER "ZDC1003-021111F SPEC".
- TO CONFORM TO SINGATRON HAZARDOUS SUBSTANCE FREE SPEC.
- HALOGEN FREE PRODUCT IDENTIFICATION MARK ON JACK: Ⓞ
- HALOGEN FREE PRODUCT IDENTIFICATION LABEL ON PACKAGING: ♻️
- FOR REFLOW SOLDERING LEAD-FREE PROCESS.
- PACKAGING: TAPE&REEL
- PRINTED DATE CODE "YYMMDD" ON TOP OF CONNECTOR.
- THE PANEL'S ID MUST BE GREATER THAN THE PLUG'S OD WHICH MUST HAVE A DIFFERENCE OF LESS THAN OR EQUAL TO 0.50mm.(AS SHOWN IN FIGURE 1.)

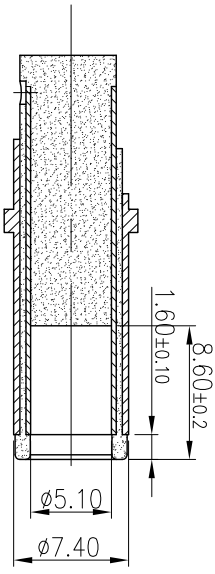

MATING PLUG: OD $\phi 7.40$
Tolerance: ±0.05

NO	DESCRIPTION	QTY	MATERIAL	PLATING & COLOR
E	SHELL	1	BRASS 0.35T	NICKEL
D	CONTACT (+)	1	COPPER ALLOY 0.3T	GOLD FLUSH OVER "N. 50U"
C	SPRING (-)	1	COPPER ALLOY 0.3T	GOLD FLUSH OVER "N. 50U"
B	COVER	1	HIGH TEMP. THERMOPLASTIC	BLACK
A	HOUSING	1	HIGH TEMP. THERMOPLASTIC	BLACK
NO	DESCRIPTION	QTY	MATERIAL	PLATING & COLOR

UNLESS OTHERWISE SPECIFIED TOLERANCES

DECIMALS:	ANGLES:
X :±0.5	X :±2°
X.X :±0.3	X.X :±1°
X.XX :±0.2	

TITLE	DC POWER JACK
DMW Springwul	PART NO. ZDC1003-021111F
CHKD Sky	SCALE 4:1 UNIT: mm
APVD Lussen	SIZE: A3 SHEET: 1 OF 1 REV: A

Singatron Enterprise Co., Ltd.
信亨企業股份有限公司

CUSTOMER COPY

