

RECOMMENDED P.C.B. LAYOUT(T=1.2) for COMPAL
TOP VIEW (TOLERANCE: ±0.05)

SPECIFICATIONS:

1. ELECTRICAL CHARACTERISTICS:
 1-1. RATING: 20V 7A
 1-2. CONTACT RESISTANCE: 30mΩ MAX.(INITIAL)
 1-3. DIELECTRIC WITHSTANDING VOLTAGE: 500V AC FOR ONE MINUTE.
 1-4. INSULATION RESISTANCE: 100M Ω MIN. MEASURED BY 500 VDC
 2. MECHANICAL CHARACTERISTICS:
 2-1. INSERTION FORCE : 1.0~3.0 KGF
 2-2. WITHDRAWAL FORCE : 0.5 KGF MIN.
 3. LIFE TEST: 10000 CYCLES MIN.
 3. OTHER GENERAL SPEC. TO REFER "2DC2003-004111F SPEC".
 4. TO CONFORM TO SINGAITRON HAZARDOUS SUBSTANCE FREE SPEC.
 5. HALOGEN FREE PRODUCT IDENTIFICATION MARK ON PRODUCT: ©
 6. HALOGEN FREE PRODUCT IDENTIFICATION LABEL ON PACKAGING: ©
 7. FOR REFLOW SOLDERING LEAD FREE PROCESS.
 8. PACKAGING: TAPE & REEL.

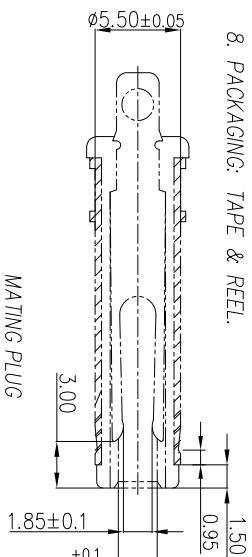

MATING PLUG

G	GROUND	1	STAINLESS	N/A
F	STOPPER	1	HIGH TEMP. THERMOPLASTIC	BLACK
E	SHELL	1	COPPER ALLOY	NICKEL PLATING
D	PIN	1	COPPER ALLOY	GOLD FLASH
C	TERMINAL B	1	COPPER ALLOY	Tu* Au Min. plated on contact area : 100u" Min. Matte Tin (鍍錫) plated on solderarea : 60~120u" Nickel plated on overall area . (D16)
B	TERMINAL A	1	COPPER ALLOY	Tu* Au Min. plated on contact area : 100u" Min. Matte Tin (鍍錫) plated on solderarea : 60~120u" Nickel plated on overall area . (D16)
A	BODY	1	HIGH TEMP. THERMOPLASTIC	BLACK
NO	DESCRIPTION	QTY	MATERIAL	PLATING & COLOR
UNLESS OTHERWISE SPECIFIED TOLERANCES				
DECIMALS:		ANGLES:	TITLE	
X : ±0.5	X : ±2°		DC POWER JACK	
X.X : ±0.3	X.X : ±1°		DWM TRY 14/1/16 PART NO. 2DC2003-004111F	
X.XX : ±0.2			CHKD ZUZ 14/1/16 SCALE 3:1 UNIT: mm	
			APVD Liao 14/1/16 SIZE: A3 SHEET: 1 OF 1 REV: B	
CUSTOMER COPY				

Singatron Enterprise Co., Ltd.
信音企業股份有限公司