

MATING PLUG (TOLERANCE: ±0.05)

**SPECIFICATIONS:**

1. ELECTRICAL CHARACTERISTICS:
  - 1-1. RATING: DC 20V 12A
  - 1-2. CONTACT RESISTANCE: 30mΩ MAX.(INITIAL)
  - 1-3. JACK SHALL WITHSTAND 500 V AC BETWEEN ANY ADJACENT TERMINAL(EXCEPT LED) FOR ONE MINUTE.
  - 1-4. INSULATION RESISTANCE: 100MΩ MIN. MEASURED BY 500 VDC
2. MECHANICAL CHARACTERISTICS:
  - 2-1. INSERTION FORCE : 2.5 KGf MAX.
  - 2-2. WITHDRAWAL FORCE : 1.0 KGf MIN.
3. LIFE TEST: 5,000 CYCLES MIN.
4. OTHER GENERAL SPEC. TO REFER "2DC3007-210111F SPEC".
5. TO CONFORM TO SINGATRON HAZARDOUS SUBSTANCE FREE SPEC.
6. HALOGEN FREE PRODUCT IDENTIFICATION MARK ON JACK: ☉
7. HALOGEN FREE PRODUCT IDENTIFICATION LABEL ON PACKAGING: ☉
8. CAUTION: DEVICES ARE CLASS 1 ESD SENSITIVE. PLEASE OBSERVE APPROPRIATE PRECAUTIONS DURING HANDLING AND PROCESSING.
9. THE PANEL'S ID MUST BE GREATER THAN THE PLUG'S OD WHICH MUST HAVE A DIFFERENCE OF LESS THAN OR EQUAL TO 0.5 mm.(AS SHOWN IN FIGURE 1.)

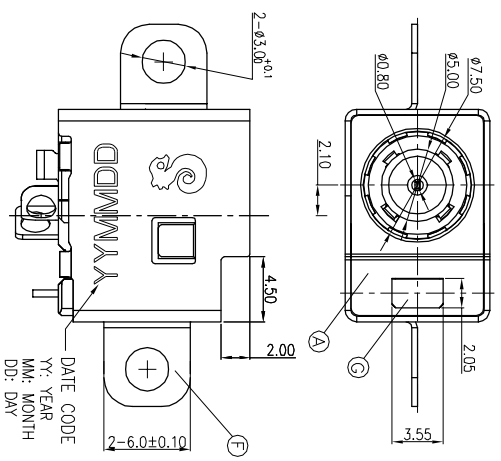

**LED Soldering Condition:**

Peak temperature 350 °C Max.  
Soldering Iron 350 °C Max.  
Dwell time 3 sec Max.  
(one time only)

LED TYPE  
AMBER (584~594)

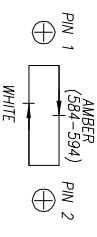

MODE	COLOR
PN1(+)	AMBER
PN2(-)	AMBER
PN1(-)	WHITE
PN2(+)	WHITE

DC JACK

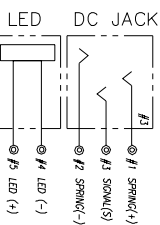

SCHEMATIC

UNLESS OTHERWISE SPECIFIED TOLERANCES

Singatron Enterprise Co., Ltd.  
信登企業股份有限公司

TITLE	DC POWER JACK + LED
DWN	Ron
CHKD	Sky
APVD	Lussen
PART NO. 2DC3007-210111F	
SCALE: 4:1 UNIT: mm	
SIZE: A3 SHEET: 1 OF 1 REV: A	
CUSTOMER COPY	