

REV.	ECN NO OR DESCRIPTION	REVISED	DATE
A	PDR RELEASE	IVY-C	2017.03.10

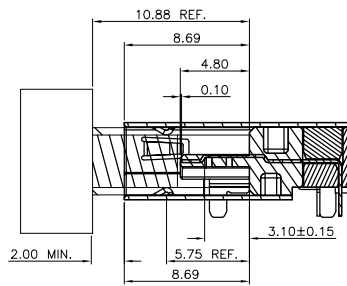

PLUG Fully Insert

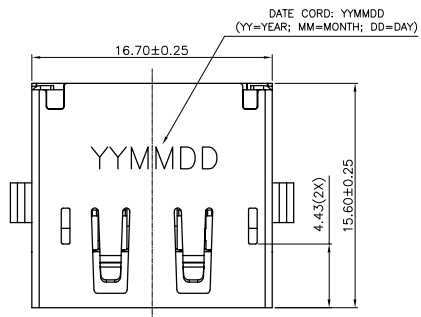
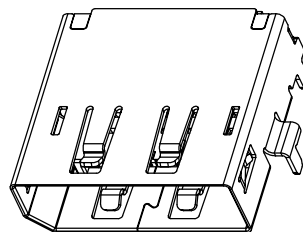

3D VIEW

- ELECTRICAL CHARACTERISTICS:
 - CURRENT RATING: 0.5 AMP.
 - VOLTAGE RATING: 40V.
 - CONTACT RESISTANCE: 30mΩ MAX.
 - INSULATION RESISTANCE: 100MΩ MIN. @ 500V DC.
 - DIELECTRIC WITHSTANDING VOLTAGE: 500V AC FOR 1 MINUTE.
- MECHANICAL CHARACTERISTICS:
 - INSERTION FORCE: 4.5Kgf MAX.
 - WITHDRAWAL FORCE: 1.0~4.0Kgf.
- LIFE TEST: 10,000 CYCLES.
- TO CONFORM TO THE SINGATRON HAZARDOUS SUBSTANCE FREE SPEC.
- HALOGEN FREE PRODUCT IDENTIFICATION LABEL ON PACKAGING:
- PACKAGE: SEE "2DT1517-320111F" PACKAGE.
- FOR REFLOW SOLDERING LEAD-FREE PROCESS.
- OTHER GENERAL SPEC. TO REFER "2DT1517-320211F SPEC".

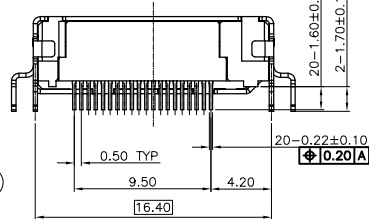
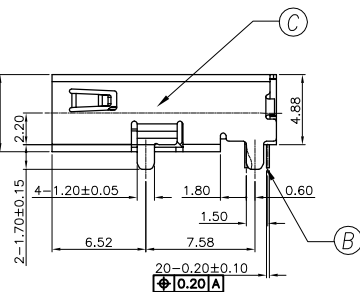
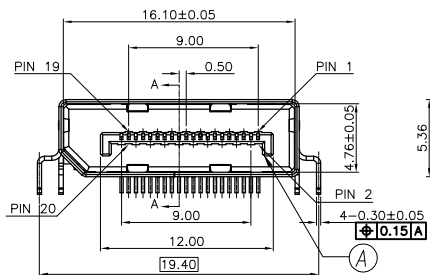

PART NO.

2DT1517-320111F

CH.: 2.2mm

SUFFIX: HALOGEN FREE

TERMINAL TAIL LENGTH:
2 : SHELL :1.70mm
CONTACT :1.60mm

PACKAGE
1: TAPE AND REEL
HOUSING COLOR
1: BLACK
CONTACT PLATING
1: 30u" GOLD PLATED ON CONTACT AREA,
MATTE TIN PLATED ON SOLDER AREA,
NICKEL UNDERPLATED OVERALL.

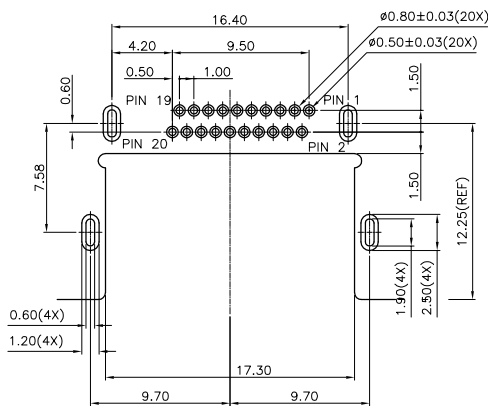
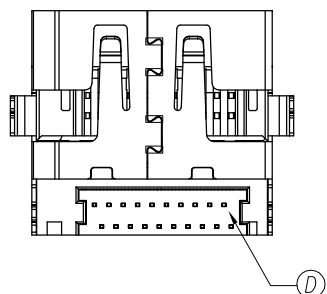

RECOMMENDED PCB LAYOUT(TOP VIEW)
(THICKNESS=1.20±0.05mm)
(TOLERANCE=±0.05mm)

NO	DESCRIPTION	QTY	MATERIAL	PLATING & COLOR
D	COVER	1	LCP+30%GF 94V-0(E130)	BLACK
C	SHELL	1	SUS304-1/2H T=0.3	NICKEL PLATED
B	CONTACT	20	C2680R-H T=0.2	SEE PART NO.
A	HOUSING	1	LCP+30%GF 94V-0(E130)	BLACK
UNLESS OTHERWISE SPECIFIED TOLERANCES		Singatron Enterprise Co., Ltd. 信音企業股份有限公司		
DECIMALS: X ±0.5 X.X ±0.3 X.XX ±0.2		TITLE: DISPLAY PORT RECEPTACLE,SINKING, C.H=2.2mm DWN: WY-C 2017.03.10 PART NO. 2DT1517-320111F CHKD: ANGELA2017.03.10 SCALE:3.3/1 UNIT: mm APVD: ANGELA2017.03.10 SIZE: A3 SHEET:1 OF 1 REV: A		

CUSTOMER COPY