

REV.	ECN NO OR DESCRIPTION	REVISED	DATE
A	PDR NO. T141126-4B	Ron	2016.03.31
B	ECN NO.S160539-E	Ken	2016.07.29

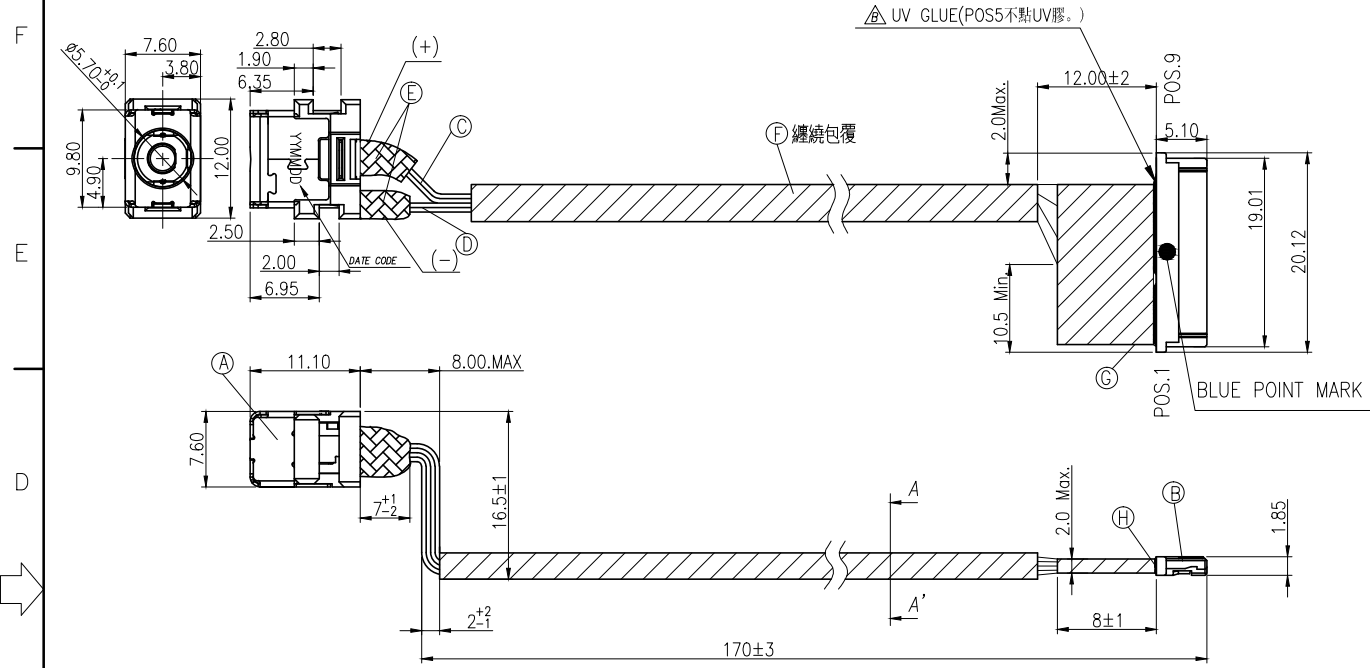

WIRE DIAGRAM		
WIRE TO BOARD CONNECTOR	WIRE	DC POWER JACK
POS 1	RED (UL10064 24AWG)	PIN (+)
POS 2	RED (UL10064 24AWG)	
POS 3	RED (UL10064 24AWG)	
POS 4	RED (UL10064 24AWG)	
POS 5	N/A	
POS 6	BLACK (UL10064 24AWG)	SPRING(-)
POS 7	BLACK (UL10064 24AWG)	
POS 8	BLACK (UL10064 24AWG)	
POS 9	BLACK (UL10064 24AWG)	

SPECIFICATIONS:

- DC POWER JACK ADD WIRE AND WIRE TO BOARD CONNECTOR
 - RATING:20V 10A
 - TEMPERATURE RISE : THE TEMPERATURE RISE SHALL NOT EXCEED 30 DEGREE C
 - VOLTAGE DROP ; THE VOLTAGE DROP SHALL NOT EXCEED 60mV.
- DC POWER JACK-p/n:2DC3156-000111F
 - RATING:20V 10A
 - CONTACT RESISTANCE:15mΩ MAX.(INITIAL / AFTER LIFE TEST)
 - DIELECTRIC WITHSTANDING VOLTAGE:500V AC FOR ONE MINUTR.
 - INSULATION RESISTANCE:100MΩ MIN. MEASURED BY 500V DC.
 - INSERTION FORCE:0.8~2.0 Kgf.(INITIAL / AFTER LIFE TEST)
 - WITHDRAWAL FORCE:0.8~2.0 Kgf.(INITIAL / AFTER LIFE TEST)
 - LIFT TEST:8000 CYCLES MIN.
- WIRE TO BOARD CONNECTOR - VENDER : ACES, p/n:50459
 - RATING CURRENT : 3.5 A/PER PIN(AWG 24 OR MORE)
- OTHER GENERAL SPEC. TO REFER "2DW3156-006111F SPEC".
- TO CONFORM TO SINGATRON HAZARDOUS SUBSTANCE FREE SPEC.
- HALOGEN FREE PRODUCT IDENTIFICATION MARK ON PRODUCT:
- HALOGEN FREE PRODUCT IDENTIFICATION LOGO ON PACKAGING:
- PRINTED DATE CODE" **YYMMDD** " ON TOP OF CONNECTOR.
DATE CODE:YYMMDD (YY:YEAR MM:MONTH DD:DAY)

NO	DESCRIPTION	QTY	MATERIAL	PLATING & COLOR
H	UV GLUE	1	8860	WHITE
G	ACETATE TAPE	1	W8*T0.12	BLACK
F	ACETATE TAPE	1	W11*T0.12	BLACK
E	HEAT SHRINK TUBE	2	φ3.5*6.0(125',300V)	BLACK
D	WIRE	4	UL10064 24AWG	BLACK
C	WIRE	4	UL10064 24AWG	RED
B	CONNECTOR (ACES 50459)	8	PHOSPHOR BRONZE	GOLD FLASH
A	DC POWER JACK	1	NYLON66 UL94V-0	WHITE
			TO SEE SINGATRON DC JACK P/N:2DC3156-000111F	

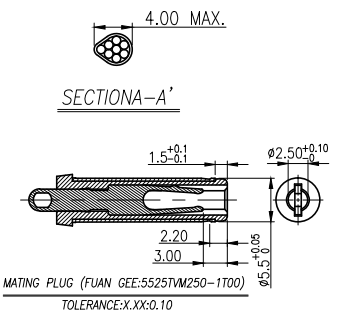

UNLESS OTHERWISE SPECIFIED TOLERANCES		TITLE	
DECIMALS:	ANGLES:	DC JACK CABLE	
X :±0.5	X :±2°	DWN	Ken
X.X :±0.3	X.X :±1°	CHKD	Cerry
X.XX :±0.2		APVD	lussen
		SCALE:-- UNIT: mm	
		SIZE: A3 SHEET:1 OF 1	

CUSTOMER COPY			
PART NO.2DW3156-006111F			
REV:B			