

REV.	REVISOR NOIE	DAIE
0	NEW DESIGN	2013-06-18
1	UPDATE PCB LAYOUT	2013-08-27
2	MODIFY DESIGN	2013-10-18

NOTES:

1. MATERIAL:
 - 1.1 SHELL: STAINLESS STEEL
 - 1.2 HOUSING: HIGH TEMPERATURE THERMOPLASTIC UL94V-0
 - 1.3 COVER: HIGH TEMPERATURE THERMOPLASTIC UL94V-0
 - 1.4 TERMINAL: COPPER ALLOY
 2. PLATING:
 - 2.1 TERMINAL: GOLD PLATED OVER NICKEL ON CONTACT AREA AND SEE P/N TABLE ON SOLDER TAILS
 - 2.2 SHELL: NICKEL PLATED
 3. P/N: 2HE15-10X-0001
- TERMINAL PLATING CODE:
- A: CONTACT AREA: GOLD FLASH MATTE TIN ON SOLDER AREA.
 B: CONTACT AREA: 5u" GOLD MATTE TIN ON SOLDER AREA.
 C: CONTACT AREA: 15u" GOLD MATTE TIN ON SOLDER AREA.

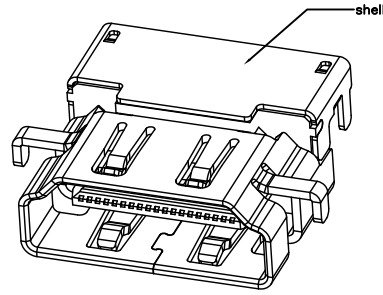
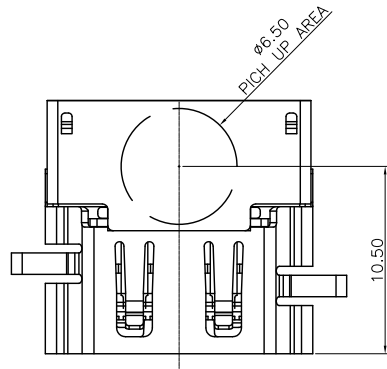

3D VIEW

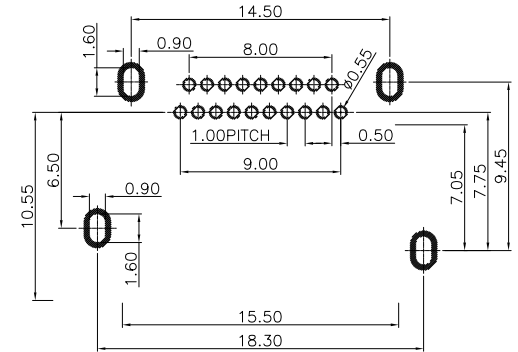
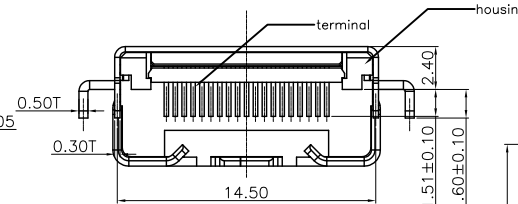
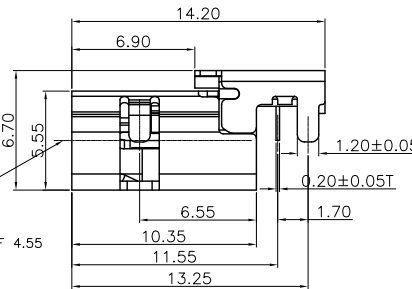
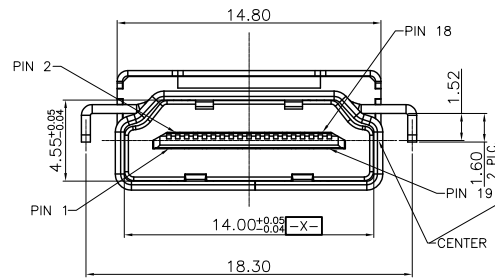

RECOMMENDED PCB LAYOUT(TOP VIEW)
 (THICKNESS=1.0±0.10mm)
 (TOLERANCE=±0.05mm)

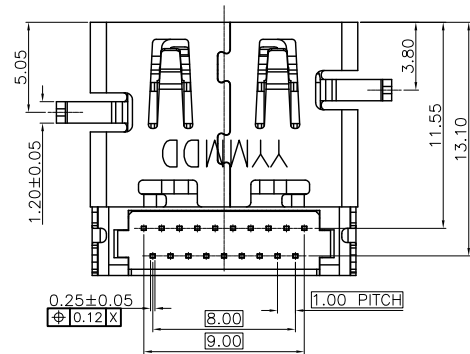

GENERAL TOLERANCES
 (UNLESS SPECIFIED)

X ± 0.30 X' ± 2'
 .X ± 0.20 .X' ± 1'

Singatron Enterprise Co., Ltd.			
TITLE	HDMI TYPE A FEMALE DIP TYPE		
DWN	PART NO.	2HE15-10X-0001	
CHKD	SCALE	UNIT:	mm
APVD	SIZE:	SHEET:	1 OF 1
REV: 1			
CUSTOMER COPY			