

SPECIFICATIONS:

- ELECTRICAL CHARACTERISTICS:
 - CURRENT RATING: 0.5 AMP.
 - VOLTAGE RATING: 40V.
 - INITIAL CONTACT RESISTANCE EXCLUDING CONDUCTOR RESISTANCE: 10mΩ MAX (TARGET DESIGN VALUE). AFTER TEST: Δ30mΩ MAX.
 - INSULATION RESISTANCE: 100MΩ MIN. @ 500V DC.
 - DIELECTRIC WITHSTANDING VOLTAGE: 500V AC FOR 1 MINUTE.
- MECHANICAL CHARACTERISTICS:
 - INSERTION FORCE: 4.5kgf MAX.
 - WITHDRAWAL FORCE: 1.0~4.0kgf.
- LIFE TEST: 10,000 CYCLES.
- OTHER GENERAL SPEC. TO REFER "ZHE1683-002111F SPEC".
- TO CONFORM TO THE SINGATRON HAZARDOUS SUBSTANCE FREE SPEC.
- HALOGEN FREE PRODUCT IDENTIFICATION LABEL ON PACKAGING.
- PACKAGE: SEE "ZHE1683-002111F PACKAGE".
- FOR REFLOW SOLDERING LEAD-FREE PROCESS.
- Salt Spray : 48 hours.

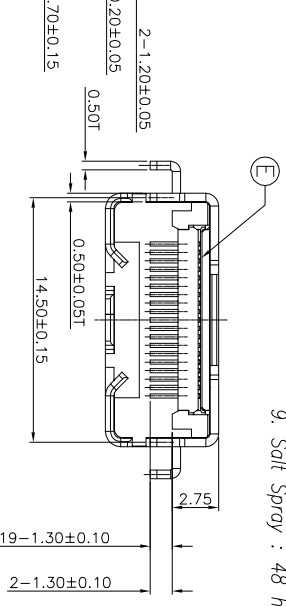
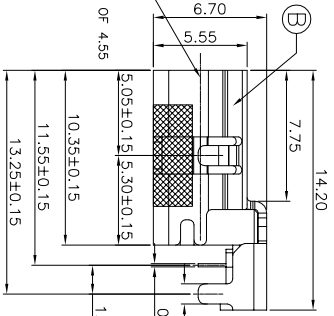
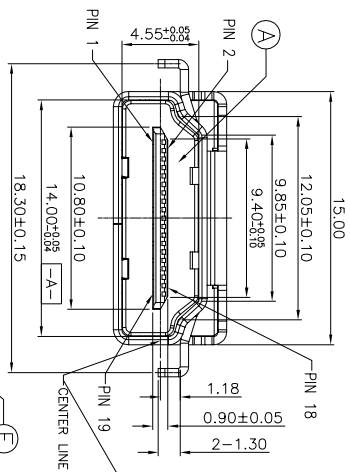

PART NO.
ZHE1683-002111F

SUFFIX: HALOGEN FREE
PACKAGE
1: TAPE AND REEL
HOUSING COLOR
1: BLACK
CONTACT PLATING
1: GOLD FLASH ON CONTACT AREA
MATE TIN ON SOLDER AREA.

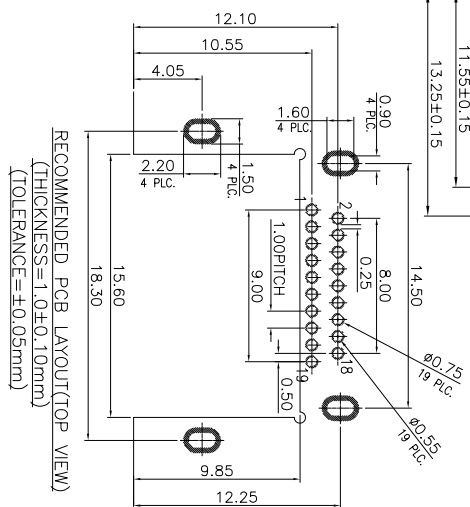
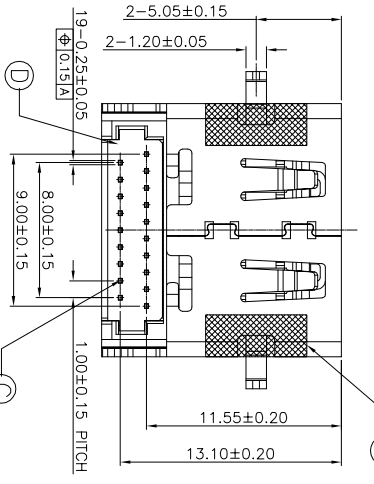

NO	DESCRIPTION	QTY	MATERIAL	PLATING & COLOR
F	MALVAR	2	N/A	YELLOW
E	TOP COVER	1	LCP UL 94V-0	BLACK
D	BOTTOM COVER	1	LCP UL 94V-0	BLACK
C	CONTACT	19	C2680	SEE PART NO.
B	SHELL	1	SUS 304	NICKEL PLATED
A	HOUSING	1	LCP UL 94V-0	BLACK

UNLESS OTHERWISE SPECIFIED TOLERANCES

DECIMALS: ANGLES: X: ±0.5 X: ±2° X.X: ±0.3 X.X: ±1' X.XX: ±0.2

TITLE: HDMI A TYPE FEMALE, REVERSE, DIR, CH=-1.18mm

DWG: ENH 2018.12.27 PART NO. ZHE1683-002111F

CHKD: SCALE: 3:1 UNIT: mm

APVD: AME312018.12.27 SIZE: A3 SHEET: 1 OF 1 REV: A

CUSTOMER COPY

Singaton Enterprise Co., Ltd.
信音企業股份有限公司