

REV.	ECN NO OR DESCRIPTION	REVISED	DATE
A	PDR RELEASE	IVY-C	2016.06.20

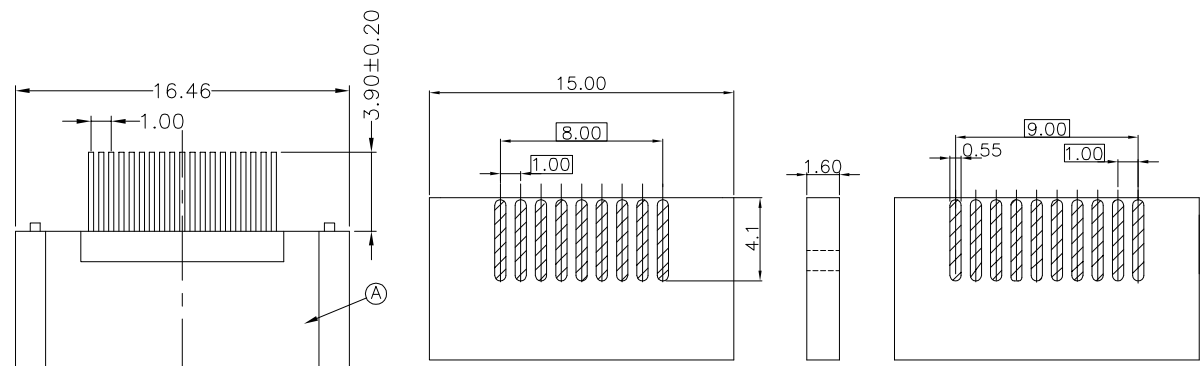

- SPECIFICATIONS:
- ELECTRICAL CHARACTERISTICS:
 - CURRENT RATING: 0.5 AMP.
 - VOLTAGE RATING: 40V.
 - INITIAL CONTACT RESISTANCE EXCLUDING CONDUCTOR RESISTANCE: 10mΩ MAX (TARGET DESIGN VALUE). AFTER TEST: Δ30mΩ MAX.
 - INSULATION RESISTANCE: 100MΩ MIN. @ 500V DC.
 - DIELECTRIC WITHSTANDING VOLTAGE: 300V AC FOR 1 MINUTE.
 - MECHANICAL CHARACTERISTICS:
 - INSERTION FORCE: 4.5Kgf MAX.
 - WITHDRAWAL FORCE: 1.0~4.0Kgf.(INITIAL) 0.5~4.0kg.(AFTER LIFE TEST)
 - LIFE TEST: 5,000 CYCLES.
 - OTHER GENERAL SPEC. TO REFER "2HE1764 SERIES SPEC".
 - TO CONFORM TO THE SINGATRON HAZARDOUS SUBSTANCE FREE SPEC.
 - GREEN PRODUCT IDENTIFICATION LABEL ON PACKAGING: **G.P. PASS**
 - PACKAGE: SEE "2HE1764 SERIES" PACKAGE.
 - FOR REFLOW SOLDERING LEAD-FREE PROCESS.

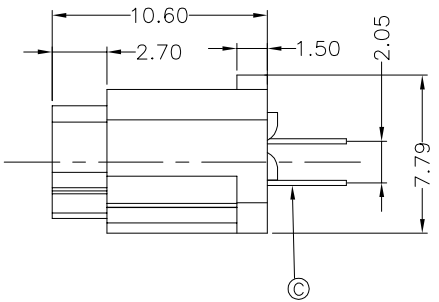
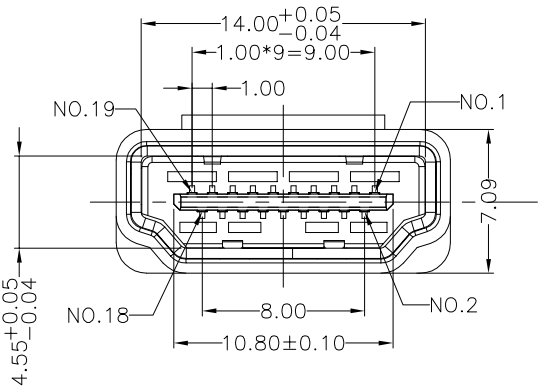

PART NO.
2HE1764-000111H

- SUFFIX: HALOGEN
- PACKAGE: 1: TRAY
- HOUSING COLOR: 1: BLACK
- CONTACT PLATING: 1: GOLD FLASH ON CONTACT AREA, TIN ON SOLDER AREA, NI UNDER PLATING OVERALL

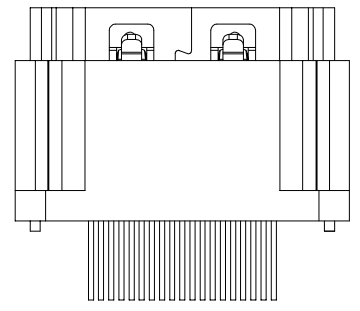

C	CONTACT	19	C2680	SEE PART NO.
B	SHELL	1	C5191	NICKEL PLATED
A	HOUSING	1	LCP UL 94V-0	BLACK
NO	DESCRIPTION	QTY	MATERIAL	PLATING & COLOR
UNLESS OTHERWISE SPECIFIED TOLERANCES		Singatron Enterprise Co., Ltd. 信音企業股份有限公司		
DECIMALS: ANGLES:		TITLE: HDMI A TYPE FEMALE, DIP TYPE		
X	:±0.5	X	:±2°	DWN IVY-C 2016.06.20 PART NO. 2HE1764-000111H
X.X	:±0.3	X.X	:±1°	CHKD ANGELA 2016.06.20 SCALE 3.3:1 UNIT: mm
X.XX	:±0.2	APVD	ANGELA 2016.06.20	SIZE: A3 SHEET: 1 OF 1 REV: A
CUSTOMER COPY				