

PULG INSERTION DEPTH

3D VIEW

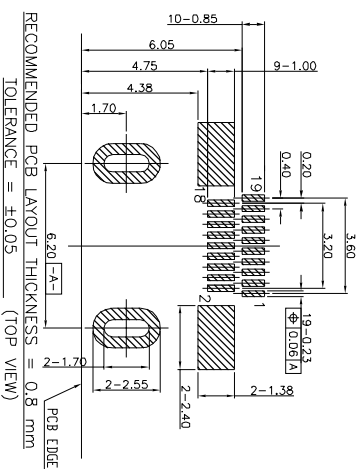
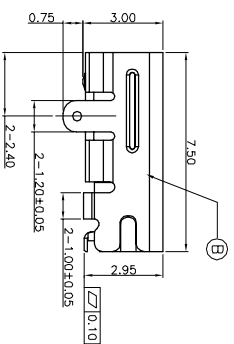
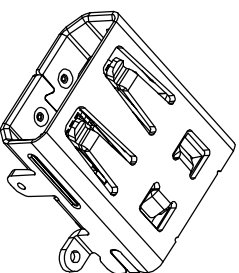

SPECIFICATIONS:

- ELECTRICAL CHARACTERISTICS:
  - CURRENT RATING: 0.3 AMP.
  - VOLTAGE RATING: 40V.
  - INITIAL CONTACT RESISTANCE EXCLUDING CONDUCTOR RESISTANCE: 10mΩ MAX (TARGET DESIGN VALUE). AFTER TEST:  $\Delta$  30mΩ MAX.
  - INSULATION RESISTANCE: 100MΩ MIN. @ 500V DC.
  - DIELECTRIC WITHSTANDING VOLTAGE: 250V AC FOR 1 MINUTE.
- MECHANICAL CHARACTERISTICS:
  - INSERTION FORCE: 4.5kgf MAX.
  - WITHDRAWAL FORCE: 0.5~2.5kgf.
- LIFE TEST: 5,000 CYCLES
- OTHER GENERAL SPEC. TO REFER "HDMI SERIES SPEC."
- TO CONFORM TO THE SINGATRON HAZARDOUS SUBSTANCE FREE SPEC.
- HALOGEN FREE PRODUCT IDENTIFICATION LABEL ON PACKAGING.
- PACKAGE: SEE "2HE1780-000111F" PACKAGE.
- FOR REFLOW SOLDERING LEAD-FREE PROCESS.



PART NO.  
2HE1780-000111F

- SUFFIX: HALOGEN FREE
- PACKAGE
- 1: TAPE & REEL
- HOUSING COLOR
- 1: BLACK
- CONTACT PLATING
- 1: 15μ" GOLD PLATED ON CONTACT AREA
- GOLD FLASH ON SOLDER TAILS

D	MYLAR	1		YELLOW
C	CONTACT	19	C5191	SEE PART NO.
B	SHELL	1	C5191	NICKEL
A	HOUSING	1	LCP E130I-GF UL94V-0	BLACK
NO	DESCRIPTION	QTY		

UNLESS OTHERWISE SPECIFIED TOLERANCES

Singatron Enterprise Co., Ltd.  
信音企業股份有限公司

DECIMALS: ANGLES:  
 ±0.5 X ±.2°  
 X.X ±0.3 X.X ±.1°  
 X.XX ±0.2

TITLE	HDMI TYPE D FEMALE
DWN	Qizhen PART NO. 2HE1780-000111F
CHKD	SCALE N/A UNIT: mm
APVD	SIZE: A3 SHEET: 1 OF 1 REV: B

CUSTOMER COPY

A 1 2 3 4 5 6 7 8