

REV.	ECN NO OR DESCRIPTION	REVISED	DATE
A	PDR RELEASE	EVEN	2021.12.20

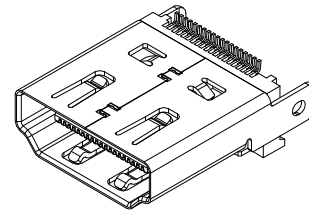

SPECIFICATIONS: (HDMI A TYPE)

- ELECTRICAL CHARACTERISTICS:
 - CURRENT RATING: 0.5 AMP.
 - VOLTAGE RATING: 40V.
 - INITIAL CONTACT RESISTANCE EXCLUDING CONDUCTOR RESISTANCE: 10mΩ MAX. (TARGET DESIGN VALUE). AFTER TEST: Δ 30mΩ MAX.
 - INSULATION RESISTANCE: 100MΩ MIN. @ 500V DC.
 - DIELECTRIC WITHSTANDING VOLTAGE: 500V AC FOR 1 MINUTE.
- MECHANICAL CHARACTERISTICS:
 - INSERTION FORCE: 4.5Kgf MAX.
 - WITHDRAWAL FORCE: 1.0~4.0Kgf.
- LIFE TEST: 10,000 CYCLES.
- OTHER GENERAL SPEC. TO REFER "HDMI SERIES SPEC".
- TO CONFORM TO THE SINGATRON HAZARDOUS SUBSTANCE FREE SPEC.
- HALOGEN FREE PRODUCT IDENTIFICATION LABEL ON PACKAGING:
- PACKAGE: SEE "2HE1810-000111F" PACKAGE.
- FOR REFLOW SOLDERING LEAD-FREE PROCESS.

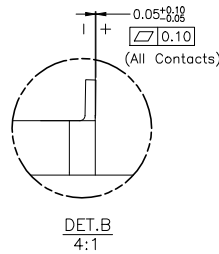
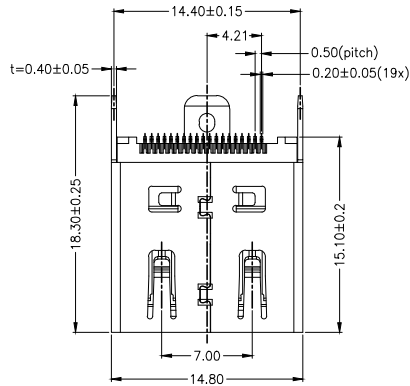

PART NO.
2HE1810-000111F

- SUFFIX: HALOGEN FREE
- PACKAGE: 1: TAPE AND REEL
- HOUSING COLOR: 1: BLACK
- CONTACT PLATING: 1: GOLD FLASH(1u Min.) ON CONTACT AREA, MATTE TIN 80u" MIN. ON SOLDER AREA, 50u" MIN. NI UNDER PLATING OVERALL

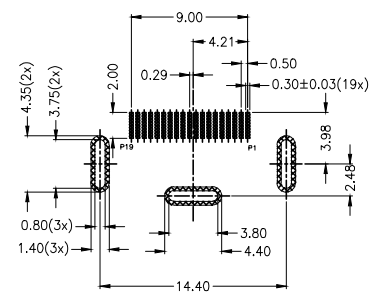
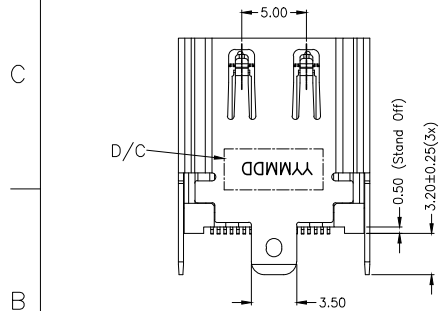
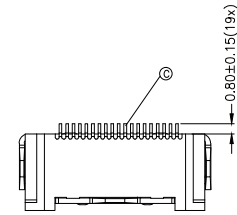
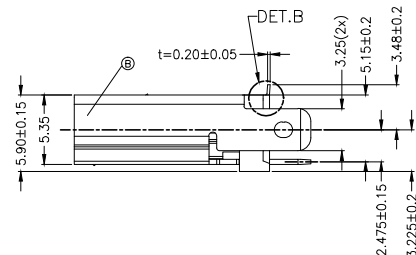
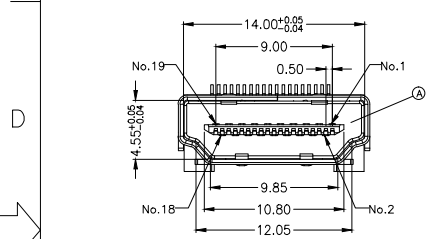

RECOMMENDED P.C.B LAYOUT (COMPONENT SIDE)
THICKNESS=1.60±0.05 (TOP VIEW)

HDMI TYPE A PIN ASSIGNMENT

PIN	Signal Assignment
1	TMDS Data2+
2	TMDS Data2 Shield
3	TMDS Data2-
4	TMDS Data1+
5	TMDS Data1 Shield
6	TMDS Data1-
7	TMDS Data0+
8	TMDS Data0 Shield
9	TMDS Data0-
10	TMDS Clock+
11	TMDS Clock Shield
12	TMDS Clock-
13	CEC
14	Utility
15	SCL
16	SDA
17	DDC/CEC Ground
18	+5V Power
19	Hot Plug Detect

D	CAP	1	LCP UL 94V-0	BLACK
C	CONTACT	19	C2680-H	SEE PART NO.
B	SHELL	1	SUS304	50u" MIN. NICKEL
A	HOUSING	1	LCP UL 94V-0	BLACK
NO	DESCRIPTION	QTY	MATERIAL	PLATING & COLOR

UNLESS OTHERWISE SPECIFIED TOLERANCES		信音科技(香港)有限公司		
DECIMALS: ANGLES:		TITLE: HDMI A Type Receptacle SMT PRODUCT H=15.1mm		
X : ±0.5	X : ±2°	DWN	EVEN 2021.12.20	PART NO. 2HE1810-000111F
X.X : ±0.3	X.X : ±1°	CHKD	SCALE: 1:1	UNIT: mm
X.XX : ±0.2		APVD	ANGELA2021.12.20	SIZE: A3 SHEET: 1 OF 1 REV: A
CUSTOMER COPY				

