

REV.	ECN NO	OR DESCRIPTION	REVISED	DATE
A		PDR RELEASE	EVEN	2022.08.02

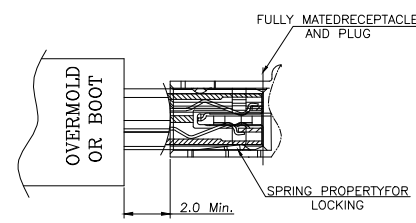

- SPECIFICATIONS: (HDMI A TYPE)
- ELECTRICAL CHARACTERISTICS:
 - CURRENT RATING: 0.5 AMP.
 - VOLTAGE RATING: 40V.
 - INITIAL CONTACT RESISTANCE EXCLUDING CONDUCTOR RESISTANCE: 10mΩ MAX. (TARGET DESIGN VALUE). AFTER TEST: Δ 30mΩ MAX.
 - INSULATION RESISTANCE: 100MΩ MIN. @ 500V DC.
 - DIELECTRIC WITHSTANDING VOLTAGE: 500V AC FOR 1 MINUTE.
 - MECHANICAL CHARACTERISTICS:
 - INSERTION FORCE: 4.5Kgf MAX.
 - WITHDRAWAL FORCE: 1.0~4.0Kgf.
 - LIFE TEST: 10,000 CYCLES.
 - OTHER GENERAL SPEC. TO REFER "HDMI SERIES SPEC".
 - TO CONFORM TO THE SINGATRON HAZARDOUS SUBSTANCE FREE SPEC.
 - HALOGEN FREE PRODUCT IDENTIFICATION LABEL ON PACKAGING:
 - PACKAGE: SEE "2HE1817-000111F" PACKAGE.
 - FOR REFLOW SOLDERING LEAD-FREE PROCESS.

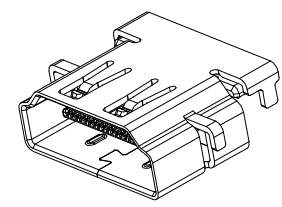
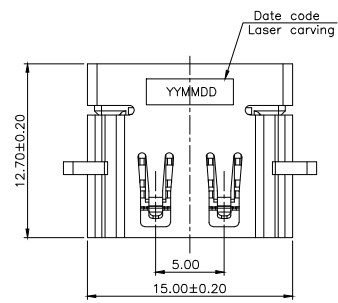
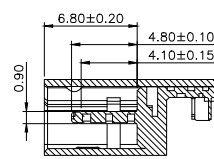
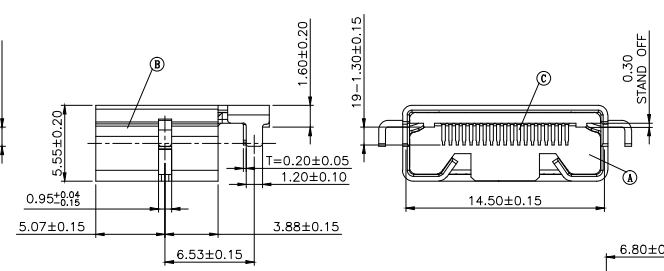
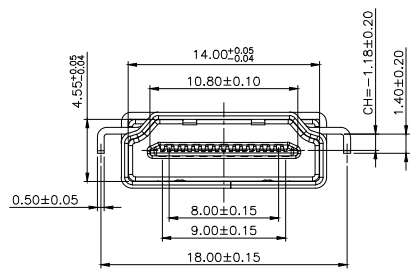

PART NO.
2HE1817-000111F

- SUFFIX: HALOGEN FREE
- PACKAGE: 1: TAPE AND REEL
- HOUSING COLOR: 1: BLACK
- CONTACT PLATING: 1: GOLD FLASH(1~3u") ON CONTACT AREA, MATTE TIN 100u" MIN. ON SOLDER AREA, 50u" MIN. NI UNDER PLATING OVERALL

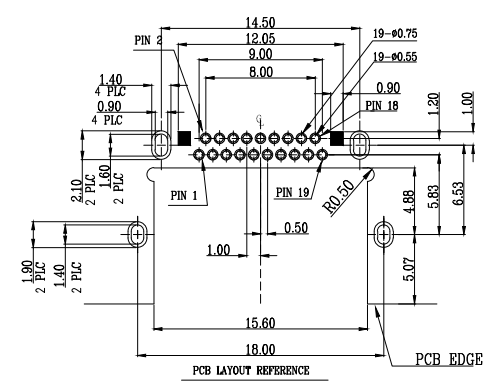
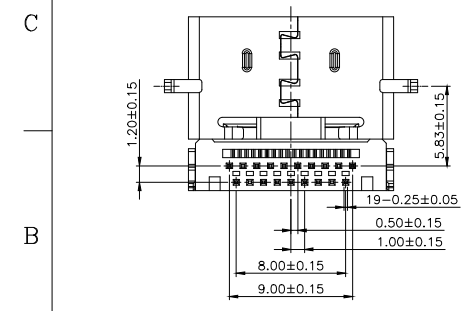

PIN	Signal Assignment
1	TMD5 Data2+
2	TMD5 Data2 Shield
3	TMD5 Data2-
4	TMD5 Data1+
5	TMD5 Data1 Shield
6	TMD5 Data1-
7	TMD5 Data0+
8	TMD5 Data0 Shield
9	TMD5 Data0-
10	TMD5 Clock+
11	TMD5 Clock Shield
12	TMD5 Clock-
13	CEC
14	Utility
15	SCL
16	SDA
17	DDC/CEC Ground
18	+5V Power
19	Hot Plug Detect

NO	DESCRIPTION	QTY	MATERIAL	PLATING & COLOR
C	CONTACT	19	C2680-EH	SEE PART NO.
B	SHELL	1	SUS201	50u" MIN. NICKEL
A	HOUSING	1	LCP UL 94V-0	BLACK

UNLESS OTHERWISE SPECIFIED TOLERANCES

DECIMALS: X :±0.5 X.X :±0.3 X.XX :±0.2

ANGLES: X :±2° X.X :±1°

信音科技(香港)有限公司			
TITLE	HDMI A TYPE FEMALE,RVS,DIP TYPE,CH1.18mm		
DWN	EVEN 2022.08.02	PART NO. 2HE1817-000111F	
CHKD		SCALE:1:1	UNIT: mm
APVD	ANGELA 2022.08.02	SIZE: A3	SHEET: 1 OF 1

CUSTOMER COPY