

REV.	ECN NO OR DESCRIPTION	REVISED	DATE
A	PDR RELEASE	EVEN	2023.07.24
B	ECN NO: L202308-002	EVEN	2023.09.11

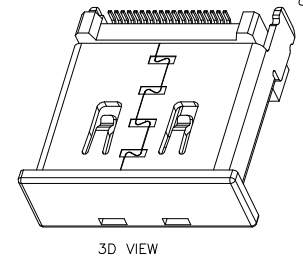

PART NO.  
2HE1823-000111F

- SUFFIX: HALOGEN FREE
- PACKAGE
- 1: TAPE AND REEL
- HOUSING COLOR
- 1: BLACK
- CONTACT PLATING
- 1: GOLD FLASH(1~3u") ON CONTACT AREA,  
MATTE TIN 75u"MIN. ON SOLDER AREA.  
50u" MIN. NI UNDER PLATING OVERALL

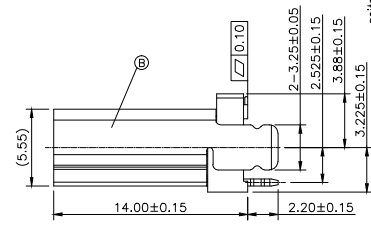
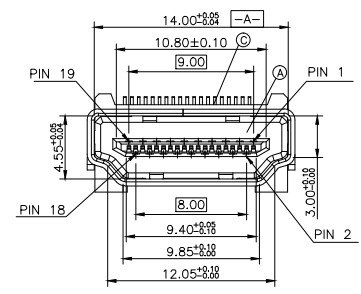
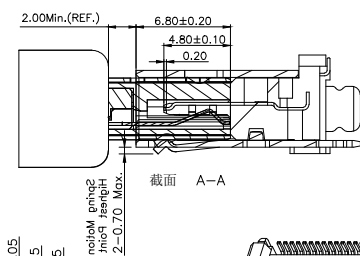
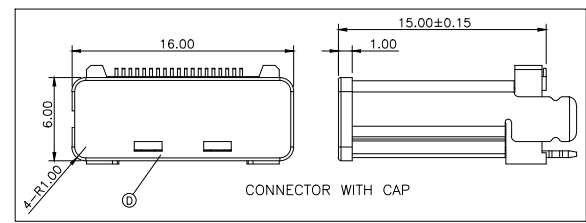
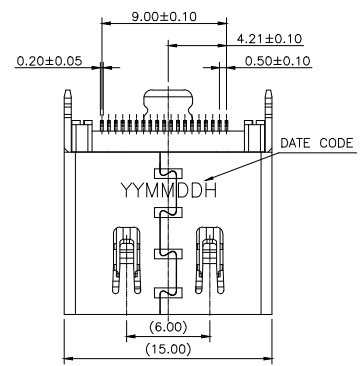
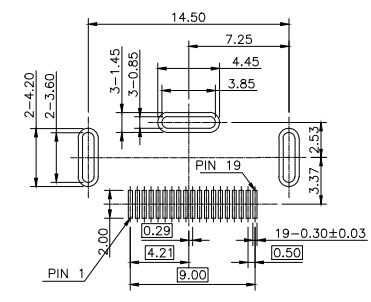
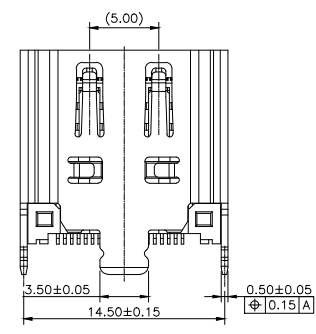

RECOMMENDED PCB LAYOUT(TOP VIEW)  
(DEFAULT DIMENSION TOL=1.20±0.05mm)

HDMI TYPE A PIN ASSIGNMENT

PIN	Signal Assignment
1	TMDS Data2+
2	TMDS Data2 Shield
3	TMDS Data1-
4	TMDS Data1+
5	TMDS Data1 Shield
6	TMDS Data1-
7	TMDS Data0+
8	TMDS Data0 Shield
9	TMDS Data0-
10	TMDS Clock+
11	TMDS Clock Shield
12	TMDS Clock-
13	CEC
14	Utility
15	SCL
16	SDA
17	DDC/CEC Ground
18	+5V Power
19	Hot Plug Detect

D	DESCRIPTION	QTY	MATERIAL	PLATING & COLOR
1	CAP	1	LCP UL 94V-0	BLACK
19	CONTACT	C2680-H		SEE PART NO.
1	SHELL	SUS304		50u" MIN. NICKEL
1	HOUSING	LCP UL 94V-0		BLACK

UNLESS OTHERWISE SPECIFIED TOLERANCES

DECIMALS:	ANGLES:	TITLE	信音科技(香港)有限公司	
X : ±0.5	X : ±2°	DWN	EVEN 2023.09.11	PART NO. 2HE1823-000111F
X.X : ±0.3	X.X : ±1°	CHKD		SCALE: 1:1 UNIT: mm
X.XX : ±0.2		APVD	VER542023.09.11	SIZE: A3 SHEET: 1 OF 1 REV:B

CUSTOMER COPY