

- SPECIFICATIONS:
- ELECTRICAL CHARACTERISTICS:
    - CURRENT RATING: 0.5A
    - VOLTAGE RATING: 40V
    - CONTACT RESISTANCE: 10mohm MAX.(INITIAL)
    - DIELECTRIC WITHSTANDING VOLTAGE: 500V AC FOR ONE MINUTE
    - INSULATION RESISTANCE: 100Mohm MIN. MEASURED BY 500V DC
  - MECHANICAL CHARACTERISTICS:
    - INSERTION FORCE : 4.5KGF MAX.
    - WITHDRAWAL FORCE : 1.0~4.0 KGF
  - LIFE TEST: 10,000 CYCLES.
  - OTHER GENERAL SPEC. TO REFER "HDMI SERIES SPEC".
  - TO CONFORM TO SINGATRON HAZARDOUS SUBSTANCE FREE SPEC.
  - HALOGEN FREE PRODUCT IDENTIFICATION LABEL ON PACKAGING.
  - FOR REFLOW SOLDERING LEAD-FREE PROCESS.
  - PART NO.

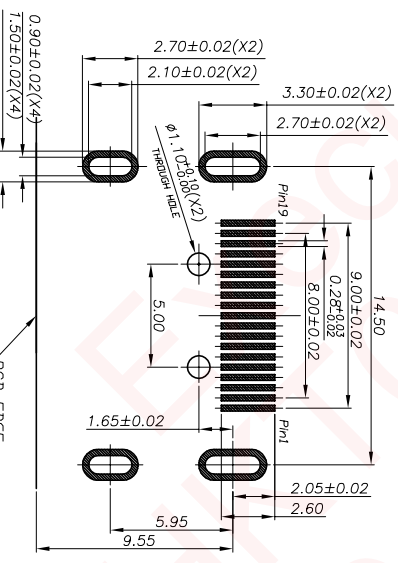

RECOMMENDED PCB LAYOUT(TOP VIEW)  
(PCB THICKNESS=1.20±0.10mm)  
(GENERAL TOLERANCE=±0.05mm)

C	TERMINAL	19	COPPER ALLOY	CONTACT AREA: GOLD FLASH SOLDER AREA: MATTE TIN
B	HOUSING	1	LCP E130I	BLACK
A	SHELL	1	SUS 304R-1/2H	NICKEL
NO	DESCRIPTION		MATERIAL	PLATING & COLOR
UNLESS OTHERWISE SPECIFIED TOLERANCES				
DECIMALS:	ANGLES:			
X : ±0.5	X : ±2°			
X.X : ±0.3	X.X : ±1°			
X.XX : ±0.2				
TITLE: HDMI TYPE A FEMALE SMT TYPE				
DWG: Charles PART NO. 2HE3Y36-001111F				
CHKD: James SCALE 1:1 UNIT: mm				
APVD: Boye SIZE: A3 SHEET: 1 OF 1 REV: A				

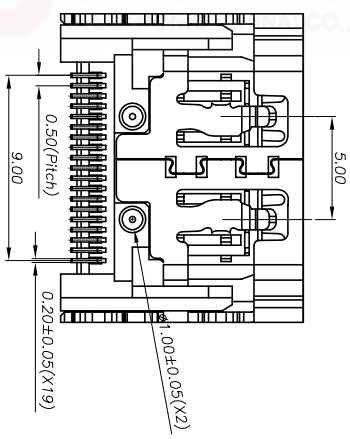
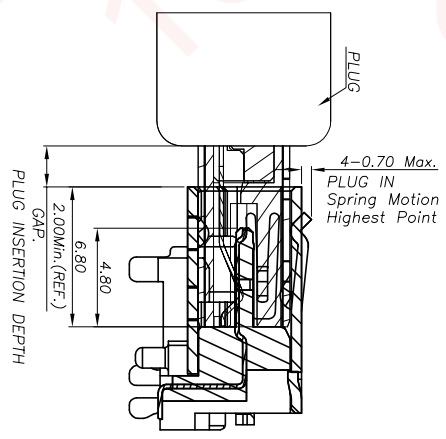
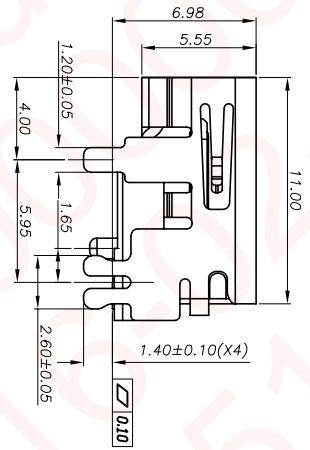
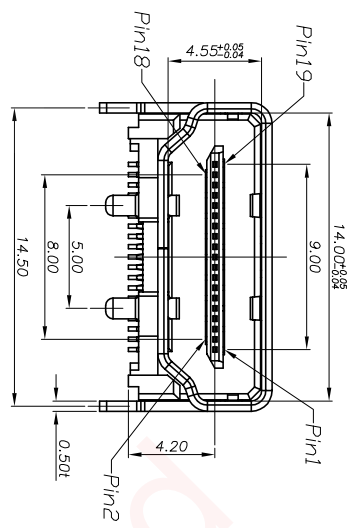

Singatron Enterprise Co., Ltd.  
信晉企業股份有限公司

CUSTOMER COPY