

RoHS COMPLIANT HF COMPLIANT

REV	ZONE	LTR	DESCRIPTION	DATE	REVISER	APPD
0.1			NEW DESIGN	04/03'14	Jason	

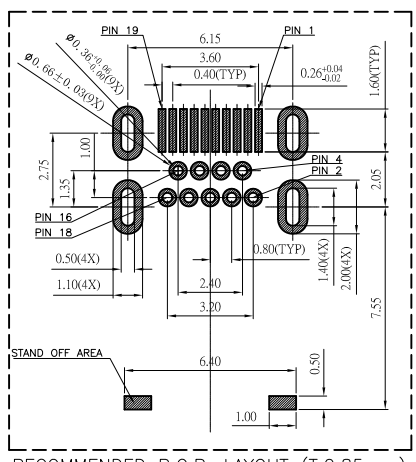

RECOMMENDED P.C.B. LAYOUT (T:0.85mm)
TOLERANCE UNSPECIFIED ±0.05mm

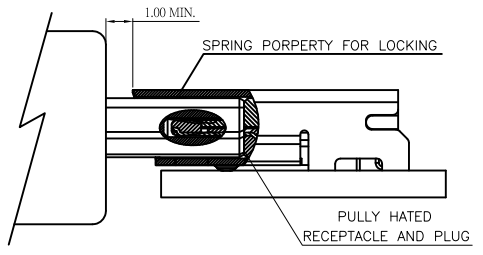
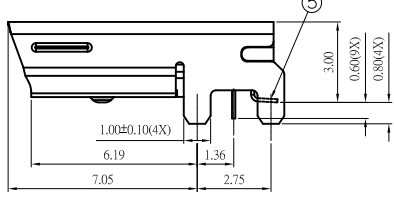
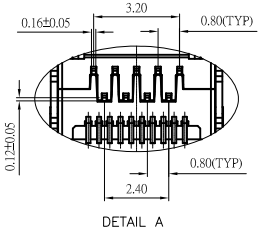

PRELIMINARY

ORDERING INFORMATION

2HE65 UL 019 S - * * * 0 0 C R 0 0 *
(1) (2) (3) (4) (5) (6) (7) (8) (9) (10)(11) (12)

- SERIES NO.
2HE65: HDMI CONNECTOR, TYPE D
- TAIL CONSTRUCTION TYPE
UL: FRONT SOLDER TAIL IS DIP AND BACK SOLDER TAIL IS SMT TYPE
- NUMBER OF PIN
019: 19 POSITIONS
- CONTACT & CONNETING TYPE
S: SOCKET
- CONTACT PLATING
0: GOLD FLASH PLATED ON CONTACT AREA, TIN 120U" MIN. PLATED ON SOLDER AREA, OVER 50U" NICKEL UNDERPLATING
- SHELL PLATING
N: 50U" NICKEL PLATING OVER ALL
- ENVIRONMENTAL PROTECTION
3: RoHS+HALOGEN FREE COMPLIANT
- RESERVED CODE
00: RESERVED CODE
- RESERVED CODE
C: RESERVED CODE
- THE PACKAGE NO
R: TAPE REEL PACKAGE
- SUFFIX NO.1
0: NONE
- SUFFIX NO.2

1	LCP+30%G.F UL94V-0	CAP	⑥
10	C5191R-H T=0.12mm	SMT CONTACT	⑤
9	C5191R-H T=0.12mm	DIP CONTACT	④
1	LCP+30%G.F UL94V-0	BOTTOM INSULATOR	③
1	LCP+30%G.F UL94V-0	TOP INSULATOR	②
1	SUS201-1/2H T=0.25mm	SHELL	①
QTY'S	SPECIFICATION	PART	ITEM

Singatron Enterprise Co., Ltd.

TITLE	HDMI D TYPE RECEPTACLE CH=1.60MM, DIP+SMT TYPE
DWN	Jason 04/03'14 PART NO. 2HE65UL019S-***00CR00*
CHKD	Lujun 04/03'14 SCALE 1:1 UNIT: mm
APVD	Bill 04/03'14 SIZE: A3 SHEET:1 OF 1 REV:0.1

CUSTOMER COPY

TOLERANCE UNSPECIFIED
 . . . ±0.05
 . . . ±0.10
 . . . ±0.20
 . . . ±0.30
 ANGLE ± 1°

F
E
D
C
B
A

F
E
D
C
B
A

1 2 3 4 5

6 7 8

1 2 3 4 5

6 7 8