

| REV. | ECN NO OR DESCRIPTION | REVISED | DATE |
|------|--|---------|------------|
| A | PDR NO.: T200417-2A~D PDR NO.: T200427-1A~D | MF | 2021.01.20 |
| B | ECN NO.: S202110-R15 | MF | 2022.04.07 |

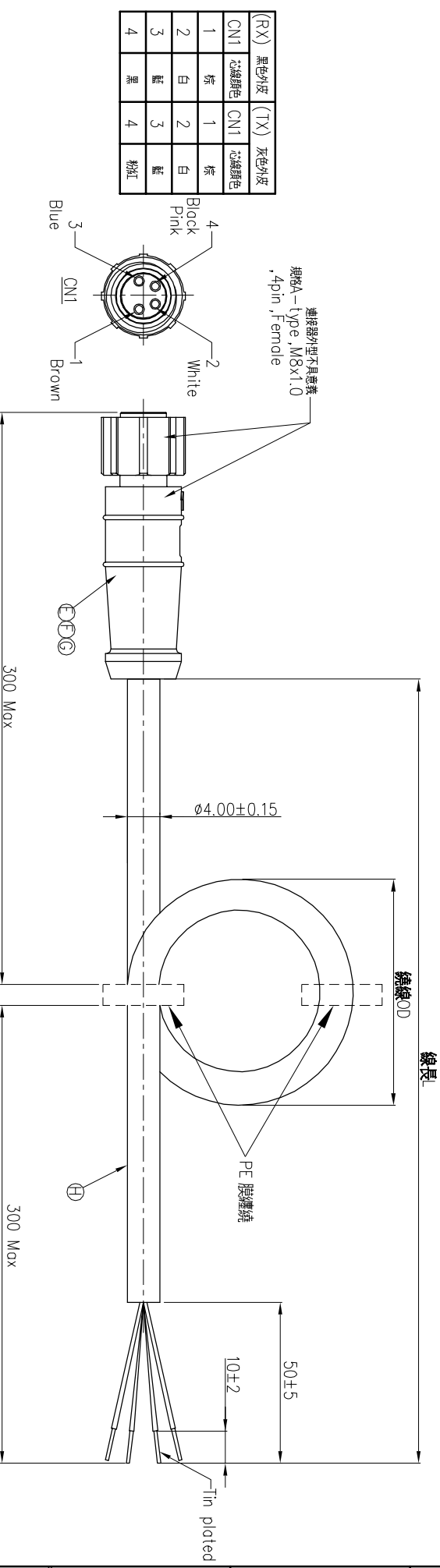

| (RX) | 黑色外皮 (TX) | 灰色外皮 |
|------|-----------|------|
| CN1 | 芯線顏色 | CN1 |
| 1 | 棕 | 1 |
| 2 | 白 | 2 |
| 3 | 藍 | 3 |
| 4 | 黑 | 4 |

| 外殼顏色 | COLOR | 黑色 BLACK | 灰色 GRAY | 黑色 BLACK | 灰色 GRAY | 黑色 BLACK | 灰色 GRAY | 黑色 BLACK | 灰色 GRAY |
|--------------|-----------------|-----------------|-----------------|-----------------|-----------------|-----------------|-----------------|-----------------|---------|
| PART NO. | 3081715300 | 3081838300 | 3081838400 | 3081838600 | 3081760400 | 3081838700 | 3081760500 | 3081838500 | |
| REV. | 06 | 06 | 06 | 06 | 06 | 06 | 06 | 06 | |
| SG PART NO. | 2ME3010-W04336H | 2ME3010-W04340H | 2ME3010-W04337H | 2ME3010-W04341H | 2ME3010-W04338H | 2ME3010-W04342H | 2ME3010-W04339H | 2ME3010-W04343H | |
| MODEL NAME | | | | | | | | | |
| 線長 (mm) | 2000±50 | 2000±50 | 3000±50 | 5000±100 | 10000±200 | | | | |
| 線線OD (mm) | 200±20 | 200±20 | 200±20 | 240±20 | 240±20 | 240±20 | 240±20 | 240±20 | B |
| 外殼線包裝尺寸 (mm) | 290x190±30 | 290x190±30 | 290x190±30 | 290x190±30 | 290x190±30 | 290x190±30 | 290x190±30 | 290x190±30 | |

- Notes:
- Connector: A type, M8x1.0, 4PIN, Female, Connecting wire
 - Material:
 - wire: PVC
 - 端PIN: 磷青銅 or 黃銅
 - Inner&Over Mold: TPU
 - Color: 外殼顏色依表樣設定
 - Wire Gauge: AWG 24, 0.08mm bare copper wire
 - Voltage Resistance: DC30V
 - Temperature Resistance: Above 80°C
 - UL Recognized Field Number: UL2725 or UL20379 or UL20594 or Equal
 - Must meet RoHS Compliant&Must meet Delta general Spec 10000-0162<5-1-30 Red phosphorous and phosphorous compounds
 - 此料需天鐵袋包裝, 包裝袋上的標籤, 需有各別料號及二維碼(二維碼請出內容料號)
 - Product should conform to IP67 rules

UNLESS OTHERWISE SPECIFIED TOLERANCES

| DECIMALS: | ANGLES: | TITLE | M8 SERIES | FEMALE CONN. (4PIN) |
|------------|----------|-------|-----------|---------------------------------|
| X : ±0.5 | X : ±2° | DWM | MF | PART NO. 2ME3010-W0433XH(36~43) |
| XX : ±0.3 | XX : ±1° | CHKD | JF | SCALE 2:1 UNIT: mm |
| XXX : ±0.2 | | APVD | STEVE | SIZE: A3 SHEET: 1 OF 1 REV: B |

Suzhou Singtron Auto Electronics CO.,LTD.
蘇州信音汽車電子有限公司

CUSTOMER COPY