

REV	ECN NO OR DESCRIPTION	REVISED	DATE
A	PDR NO.:T140609-2A	Vicky	2015.01.16

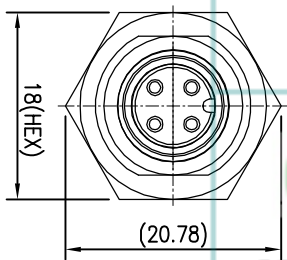
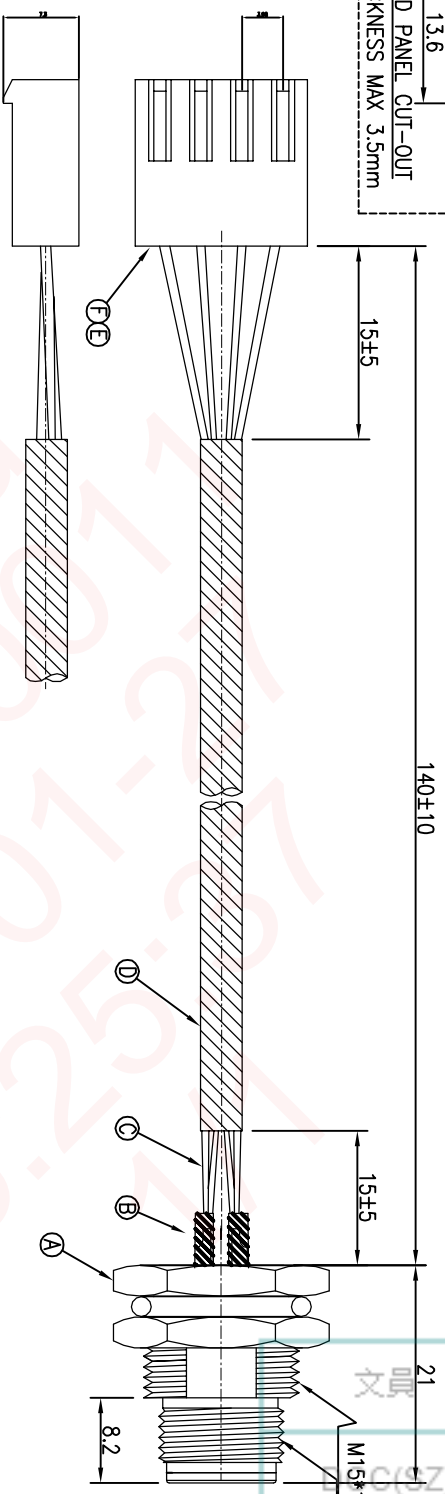
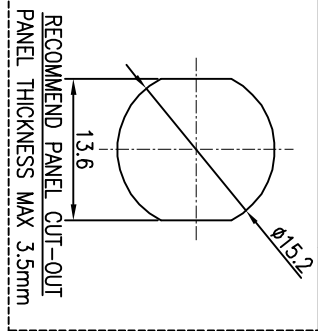

Conn.2

Conn.1

WATERPROOF RATE: IP67

2	YELLOW	4
3	WHITE	3
4	GREEN	2
1	RED	1
CONN.2 WIRE COLOR		CONN.1
PIN OUT		
CONN.2		CONN.1

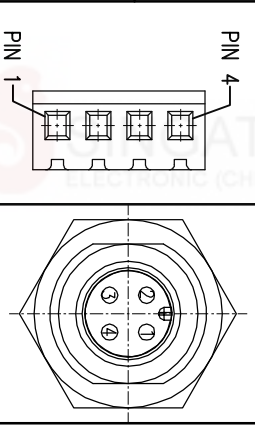

Pin Assignments Front View

NOTES:

- ELECTRICAL CHARACTERISTICS:
  - CURRENT RATING: 5 AMPS.
  - CONTACT RESISTANCE: 30 mohm Max.
  - INSULATION RESISTANCE: 100 Mohm Min. at 500VDC.
  - BREAKDOWN VOLTAGE: 500 VAC PER MINUTE.
- MECHANICAL CHARACTERISTICS: TIGHTENING TORQUES: 0.8~1.0Nm(7.08~8.85lbf.in.).
- ENVIRONMENTAL:
  - OPERATING TEMPERATURE: -20°C TO +80°C.
  - SEALING REQUIREMENTS: IP67.
  - LIFE TEST: 1,000 CYCLES MIN.
- OTHER GENERAL SPEC. TO REFER "M12 SERIES SPEC."
- FOR TECHNICAL DATA REFER TO YOUR LOCAL SINGATRON ELECTRONICS SALES OFFICE.
- ALL DIMENSIONS ARE NOMINAL FOR REFERENCE ONLY UNLESS OTHERWISE STATED.
- TO CONFORM TO SINGATRON HAZARDOUS SUBSTANCE FREE SPEC.
- GREEN PRODUCT IDENTIFICATION LABEL ON PACKAGING:

F	TERMINAL	4	BRASS	TIN-PLATED
E	HOUSING	1	NYLON 66 94V-0	WHITE
D	HEAT SHRINK TUBE	1	Ø5 125°C 300V	BLACK
C	WIRE	4	UL1007 22AWG	SEE PIN OUT
B	HEAT SHRINK TUBE	4	Ø2.4 含膠套管	BLACK
A	PANEL CONN.	1	P/N:2MT3003-W04300	N/A
NO	DESCRIPTION	QTY	MATERIAL	PLATING & COLOR

UNLESS OTHERWISE SPECIFIED TOLERANCES		Singatron Enterprise Co., Ltd. 信登企業股份有限公司	
DECIMALS:	ANGLES:	TITLE M12 SERIES FRONT MOUNT MALE CONN. (4PIN)	
X : ±0.5	X : ±2°	DWN	Vicky
X.X : ±0.3	X.X : ±1°	CHKD	Horten
X.XX : ±0.2		APVD	Steve
		SCALE 2:1 UNIT: mm	
		SIZE: A3 SHEET: 1 OF 1 REV: A	

CUSTOMER COPY