

REV.	ECN NO OR DESCRIPTION	REVISED	DATE
A	PDR NO.:S160408-7A	TOMMY	2017.03.16

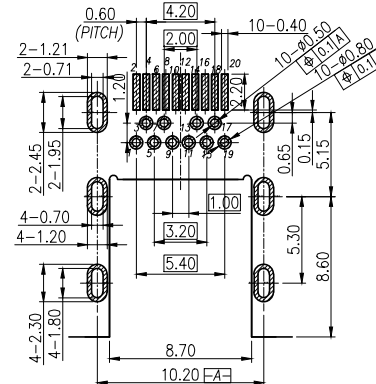
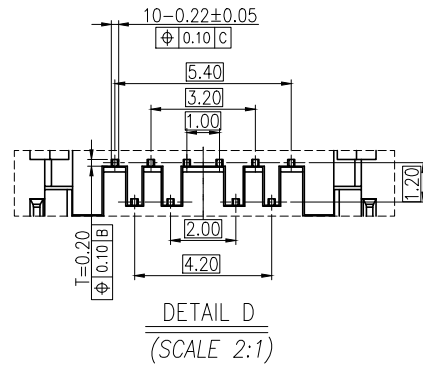
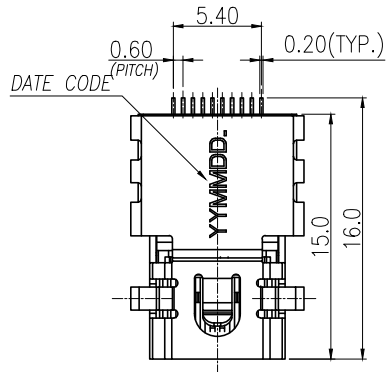

SPECIFICATIONS:

- ELECTRICAL CHARACTERISTICS:
 - CONTACT RESISTANCE CHANGE FROM INITIAL VALUE: 30mΩ MAX.
 - RATING: 40V DC 0.5A.
 - DIELECTRIC WITHSTANDING VOLTAGE: 500V AC FOR ONE MINUTE.
 - INSULATION RESISTANCE: 100MΩ MIN.
- MECHANICAL CHARACTERISTICS:
 - INSERTION FORCE: 4.5Kgf Max.
 - WITHDRAWAL FORCE: 1.0Kgf Min.
- LIFE TEST: 10,000 CYCLES.
- OTHER GENERAL SPEC. TO REFER "2MY3003-004111F SPEC".
- TO CONFORM TO SINGATRON HAZARDOUS SUBSTANCE FREE SPEC.
- HALOGEN FREE PRODUCT IDENTIFICATION MARK ON JACK:
- HALOGEN FREE PRODUCT IDENTIFICATION LABEL ON PACKAGING:
- FOR REFLOW SOLDERING LEAD-FREE PROCESS.
- PRINTED DATE CODE "YMMDD-" ON TOP OF CONNECTOR.
 - DD: DAY
 - MM: MONTH
 - YY: YEAR

RECOMMEND P.C.B LAYOUT (TOP VIEW)
 SOLDER PAD (TOL: X.XX ±0.05)

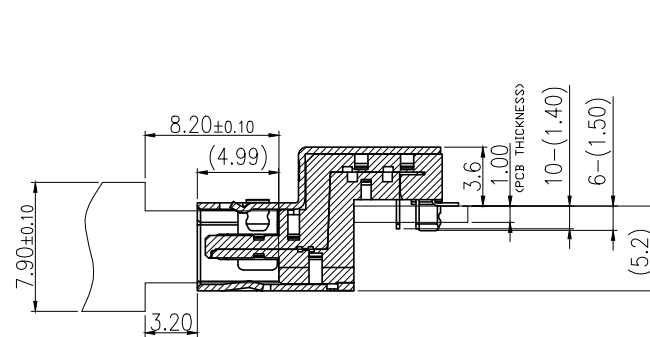
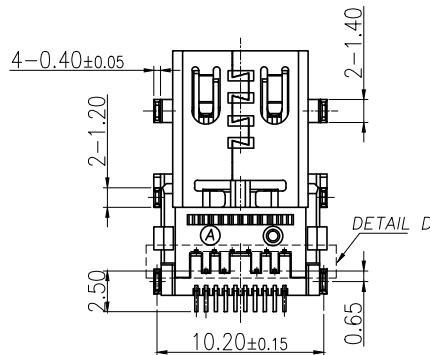
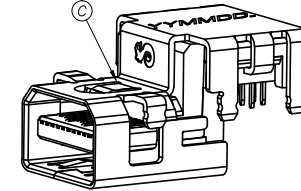
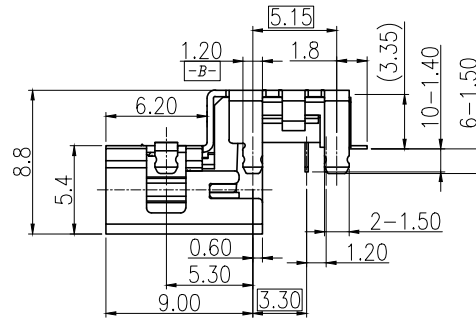
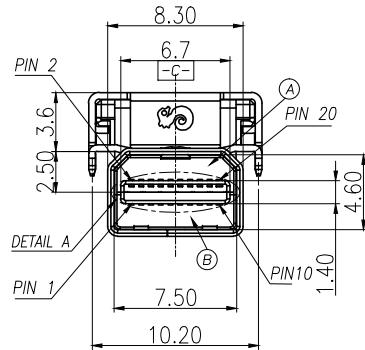

MATING DRAWING

C	SHELL	1	SUS304-1/2H,0.4T	BLACK Ni 60u"
B	INS_BOTTOM	1	Body: E130i UL 94v-0	BLACK
		10	Terminal: C2680-H 0.20T	AU 5U" ON CONTACT AREA OVER Ni 60U" MATTE SN 60U" MIN ON SOLDER AREA
A	INS_UP	1	Body: E130i UL 94v-0	BLACK
		10	Terminal: C2680-H 0.20T	AU 5U" ON CONTACT AREA OVER Ni 60U" MATTE SN 60U" MIN ON SOLDER AREA
NO	DESCRIPTION	QTY	MATERIAL	PLATING & COLOR
UNLESS OTHERWISE SPECIFIED TOLERANCES		Singatron Enterprise Co., Ltd. 		
DECIMALS: ANGLES:		TITLE: MINI DISPLAY PORT		
X	:±0.30 X :±2°	DWN	TOMMY	PART NO.2MY3003-004111F
X.X	:±0.25 X.X :±1°	CHKD	James	SCALE 1:1 UNIT: mm
X.XX	:±0.15	APVD	Boye	SIZE: A3 SHEET:1 OF 1 REV:A
CUSTOMER COPY				