

REV.	ECN NO OR DESCRIPTION	REVISED	DATE
A	PDR NO.1110317-1A	JAMES	2011.04.07
B	ECN NO.5140232	JAMES	2014.04.01

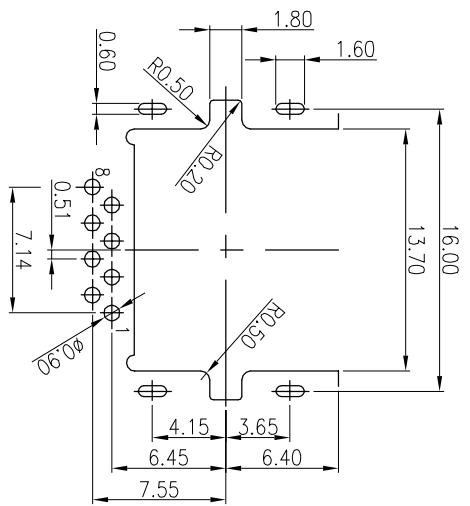
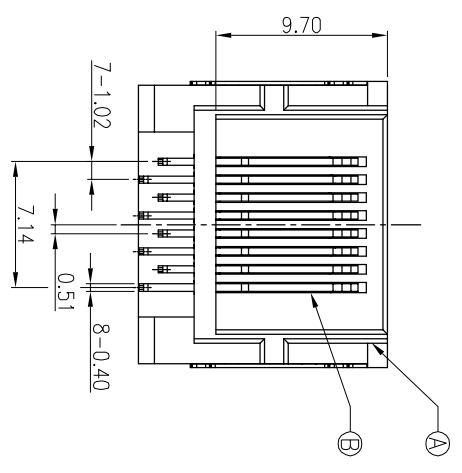
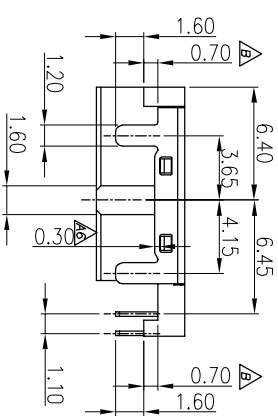
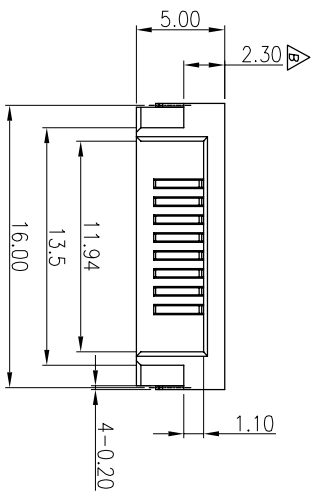
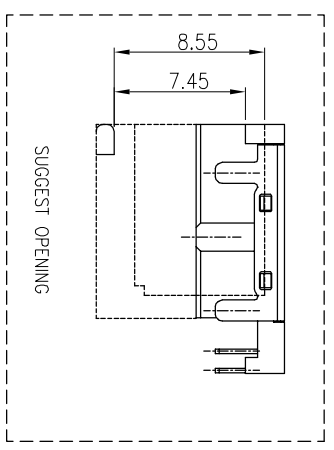
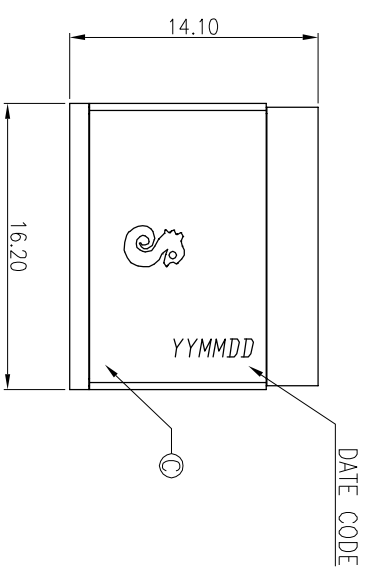

RECOMMENDED P.C.B LAYOUT(TOP VIEW)  
PCB TOLERANCES ±0.05

**SPECIFICATIONS:**

- 1. ELECTRICAL CHARACTERISTICS:**  
 1-1. CURRENT RATING: 0.5A MAX.  
 1-2. VOLTAGE RATING: 150VAC MAX.  
 1-3. CONTACT RESISTANCE: 50mΩ MAX.(INITIAL), 100mΩ MAX.(AFTER LIFE TEST), 100mΩ MIN.  
**2. MECHANICAL CHARACTERISTICS:**  
 2-1. DURABILITY: 5000 CYCLES.  
 2-2. INSERTION FORCE: 2.25kg MAX. WITH LATCH DEPRESSED.  
 2-3. OPERATING TEMPERATURE: -30°C ~ +70°C.  
 3. MARKING: MARK "S" ON TOP OF THE CONNECTOR.  
 4. PACKAGING : TAPE & REEL.  
 5. TO CONFORM TO SINGATRON HAZARDOUS SUBSTANCE FREE SPEC.  
 6. HALOGEN FREE PRODUCT IDENTIFICATION  
 MARK ON PRODUCT: ON THE PACKAGING:  
 7. HALOGEN FREE PRODUCT IDENTIFICATION LOGO ON THE PACKAGING:  
 8. FOR REFLOW SOLDERING LEAD-FREE PROCESS.  
 9. PRINTED DATE CODE "YY MM DD" ON TOP OF THE CONNECTOR.

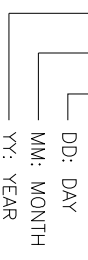

NO	DESCRIPTION	QTY	MATERIAL	PLATING & COLOR
C	SHIELDING	1	COPPER ALLOY	NI: 50U "MIN.
B	8P8C CONTACT	8	PHOSPHOR BRONZE	GOLD PLATING ON CONTACT AREAS Sn 120u" ON SOLDER TAIL; ALL OVER NI 50U "MIN.
A	BODY	1	HIGH TEMP.THERMOPLASTIC	BLACK

DECIMALS:	ANGLES:
X : ±	X : ±2°
X.X : ±0.25	X.X : ±1°
X.XX : ±0.15	

TITLE	Singatron Enterprise Co., Ltd 信高企業股份有限公司		
DWN	JAMES	PART NO.2RJ3010-008211F	
CHKD		SCALE 4:1	UNIT: mm
APVD	TONY	SIZE: A3	SHEET:1 / 1
CUSTOMER COPY			