

REV.	ECN NO OR DESCRIPTION	REVISED	DATE
A	PDR NO:T200108-6A	PAN	2020.12.16

SPECIFICATIONS:

- ELECTRICAL CHARACTERISTICS:
 - CURRENT RATING: 1.5A MAX.
 - VOLTAGE RATING: 150V MAX.
 - CONTACT RESISTANCE : 50mΩ MAX.(INITIAL).
100mΩ MAX.(AFTER LIFE TEST).
 - INSULATION RESISTANCE : 100MΩ MIN.
 - Dielectric Withstanding Voltage : 500 V AC
- MECHANICAL CHARACTERISTICS:
 - DURABILITY: 5000 CYCLES.
 - INSERTION FORCE: 2.15Kgf MAX. WITH LATCH DEPRESSED.
 - WITHDRAWAL FORCE: 3.0Kgf Min. WITH LATCH DEPRESSED.
 - OPERATING TEMPERATURE: -30℃ ~ +70℃.
- MARKING: MARK "S" ON TOP OF THE CONNECTOR.
- PACKAGING : TAPE & REEL.
- TO CONFORM TO SINGATRON HAZARDOUS SUBSTANCE FREE SPEC.
- HALOGEN FREE PRODUCT IDENTIFICATION
MARK ON PRODUCT:
- HALOGEN FREE PRODUCT IDENTIFICATION LOGO
ON THE PACKAGING:
- FOR REFLOW SOLDERING LEAD-FREE PROCESS.
- PRINTED DATE CODE "YY MM DD" ON TOP OF THE CONNECTOR.

DD: DAY
MM: MONTH
YY: YEAR

NODE	COLOR	Wavelength	DC Forward Current	Forward Voltage		
9(+)	10(-)	Amber	9 -P-10	Ad 587~593	20mA	1.7-2.7V
11(+)	12(-)	Green	11-12	Ad 560~570	20mA	1.7-2.7V

F	COVER	1	HIGH TEMP.THERMOPLASTIC	UL 94V-0 & White
E	LED	1	Green	Motte Sn 80u" ON SOLDER TAIL:
D	LED	1	Amber	Motte Sn 80u" ON SOLDER TAIL:
C	SHELL	1	STAINLESS STEEL	Ni:50u"Min UNDER PLATING COVER ALL
B	TERMINAL	8	PHOSPHOR BRONZE	3U"AU ON CONTACT AREA; Motte Sn 80u" ON SOLDER TAIL; ALL OVER Ni: 50u"MIN.
A	HOUSING	1	PA10T + 30%GF	UL 94V-0 & BLACK
NO	DESCRIPTION	QTY	MATERIAL	PLATING & COLOR

UNLESS OTHERWISE SPECIFIED TOLERANCES

Singatron Enterprise Co., Ltd.
信音企業股份有限公司

DECIMALS:	ANGLES:	TITLE	RJ45 JACK		
X : ±0.5	X : ±2°	DWN	PAN	PART NO. 2RJ3104-138211F	
X.X : ±0.3	X.X : ±1°	CHKD	ALLEN	SCALE 4:1	UNIT: mm
X.XX : ±0.2		APVD	BOYE	SIZE: A3	SHEET:1 OF 2
					REV: A

CUSTOMER COPY

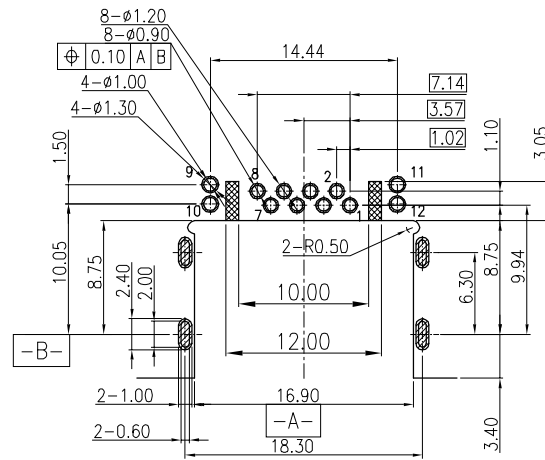
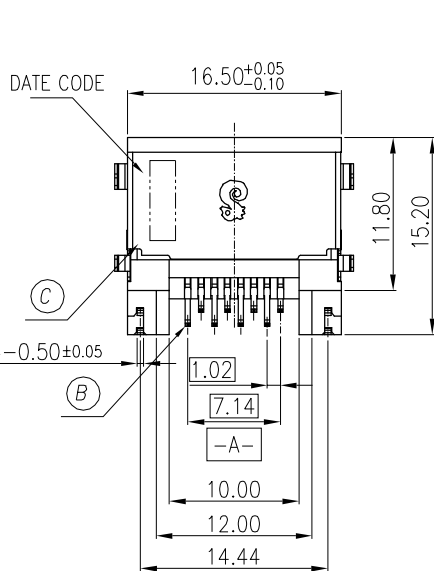
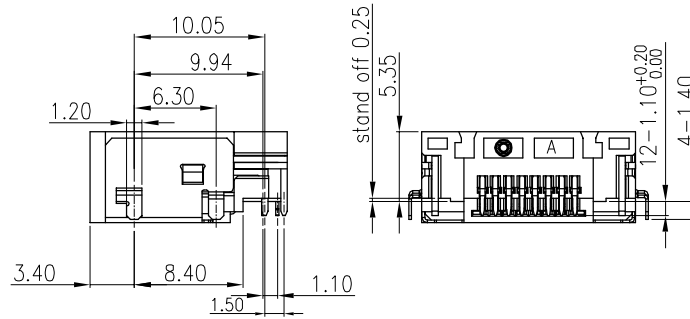
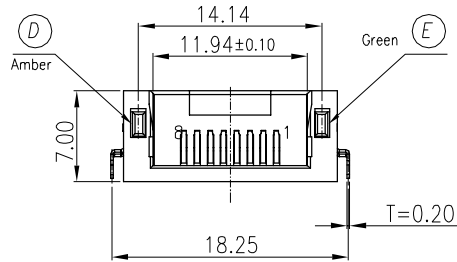
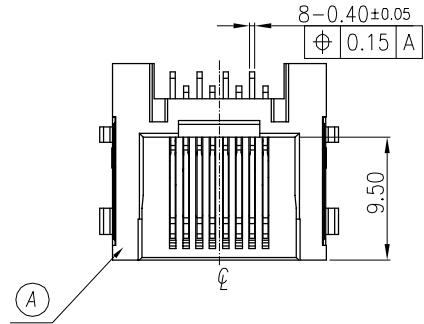
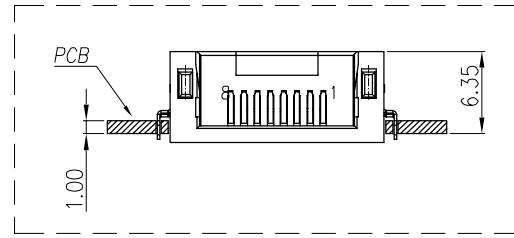

RECOMMENDED PCB LAYOUT
TOP VIEW ; TOL.±0.05

SOLDER PAD AREA STAND OFF AREA

REV.	ECN NO OR DESCRIPTION	REVISED	DATE
A	PDR NO:T200108-6A	PAN	2020.12.16

5.70 Plug Worst case 分析

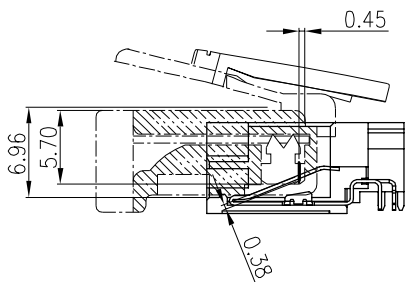

5.89 Plug Worst case 分析

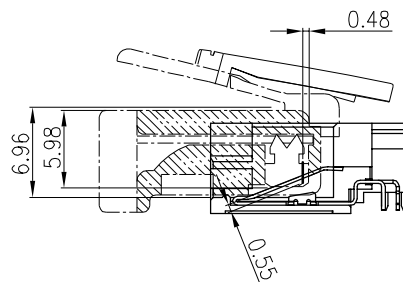

6.40 Plug Worst case 分析

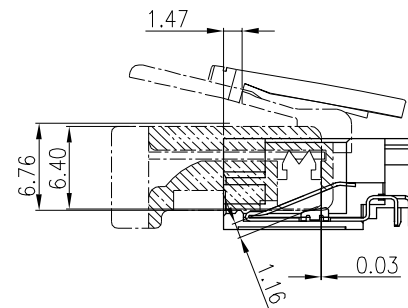

防RJ11插入模拟分析

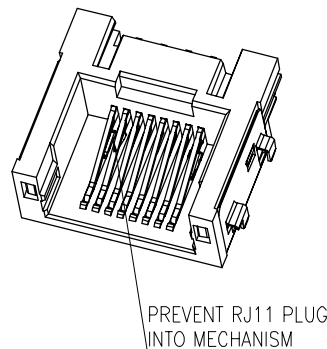
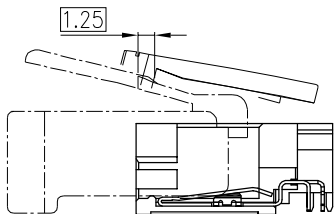

ø6.00&ø9.00 REF
PICK AREAø9.00

WITH CAP

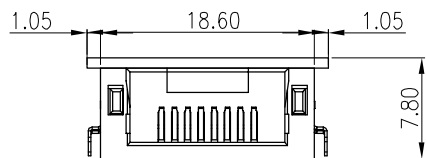
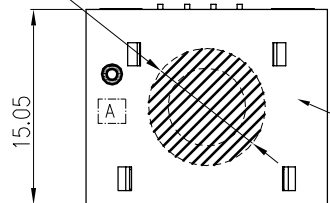

NO	DESCRIPTION	QTY	MATERIAL	PLATING & COLOR
UNLESS OTHERWISE SPECIFIED TOLERANCES		Singatron Enterprise Co., Ltd. 信音企業股份有限公司		
DECIMALS:	ANGLES:	TITLE	RJ45 JACK	
X :±0.5	X :±2°	DWN	PAN	PART NO. 2RJ3104-138211F
X.X :±0.3	X.X :±1°	CHKD	ALLEN	SCALE 4:1 UNIT: mm
X.XX :±0.2		APVD	BOYE	SIZE: A3 SHEET2 OF 2 REV: A
CUSTOMER COPY				