

REV.	ECN.NO.	DATE
A	RELEASED	04/07/10
B	Change Notes	07/23/11

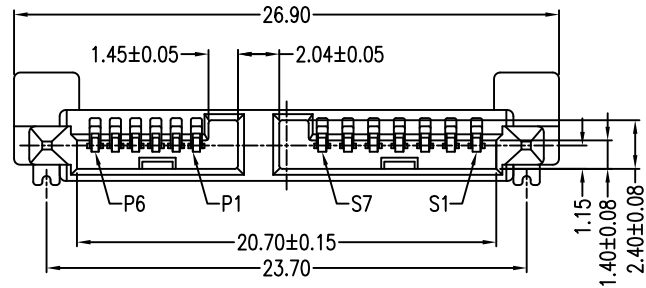

Pin Number	Signal Name	Pin Number	Power Line Designation
S1	GND	P1	DP
S2	A+	P2	+5V
S3	A-	P3	+5V
S4	GND	P4	MD
S5	B-	P5	GND
S6	B+	P6	GND
S7	GND		

**Notes:**

**\*Material**

Housing: LCP+50%GF, UL 94V-0 rated;  
 Color: Black.  
 Contact: Phosphor Bronze  
 Plating: Au Plating on contact area  
 Sn(100u"Min) plating on solder Tail.  
 Ni(40u"Min) contact underplating overall.  
 Harpoon: Brass  
 Plating: Sn(100u"Min) plating on solder Tail.  
 Ni(40u"Min) contact underplating overall.

**\*Mechanical**

Insertion Force: 45N max.  
 Withdrawal Force: 2.5N min.  
 Durability: 500cycles

**\*Electrical Specification**

Current Rating: 1.5 Ampere per contact  
 Contact Resistance: 30mΩ max.  
 Insulation Resistance: 1000MΩmin.  
 Dielectric Withstanding Voltage: 500 VAC

**\*Environmental**

Operating Temperature: -55°C to +85°C

**\*How to Order:**

2SAT-F13-V5D-30

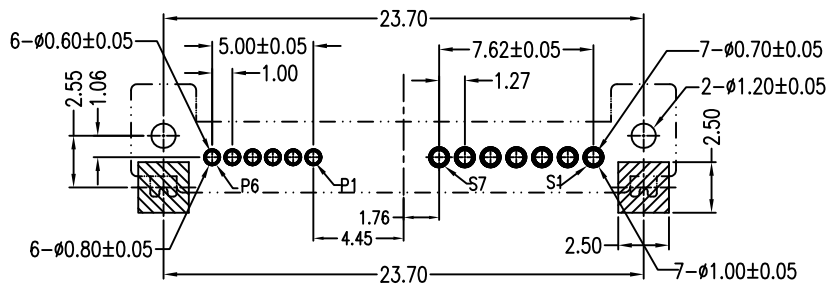
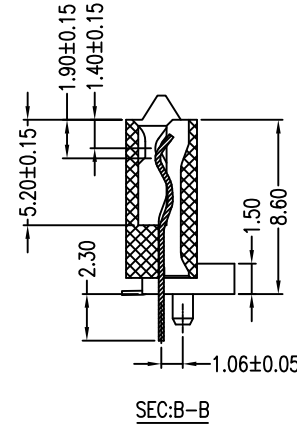
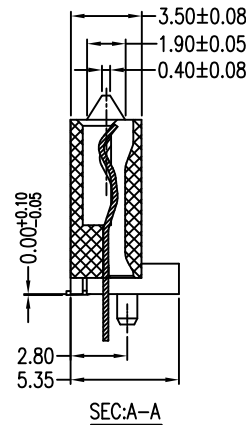
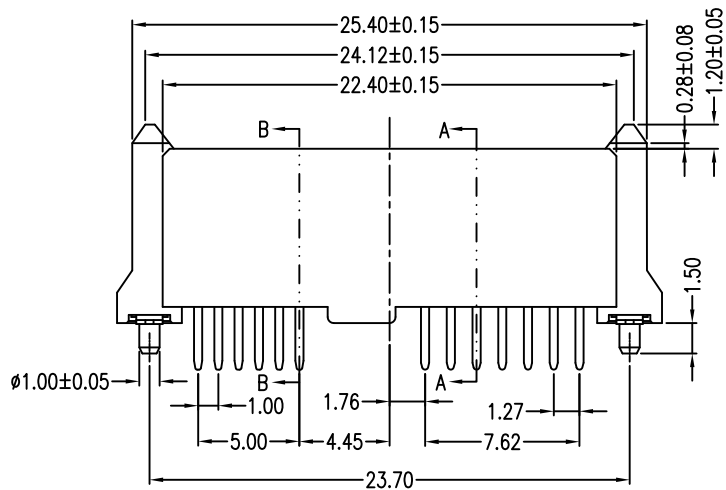
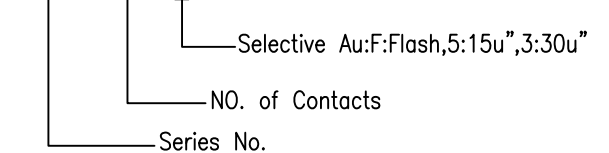

RECOMMENDED PCB LAYOUT T=1.60mm  
 (Tol±0.05)

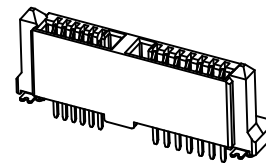

Units	mm	Scale	2.5:1	Drawing By	Data	SINGATRON U.S.A.				
Tolerance Unless Otherwise Specified				May	08/02-'11					
.X	~	±0.38		Reviewed By	Data	Date	07/23/11	Title	SATA 7+6P Vertical DIP Female (With Post)	
.XX	~	±0.25		Sharon	08/02-'11	Sheet	1 of 1			
.XXX	~	±0.20		Approval By	Data	Third Angle Projection				
Angle	~	± 3°		Jason	08/02-'11	Drawing No.	2SAT-F13-V5D-30	REV	B	