

REV.	ECN.NO.	DATE
B	Change housing and harpoon	02/04/13
B1	Revise P/N	03/04/15

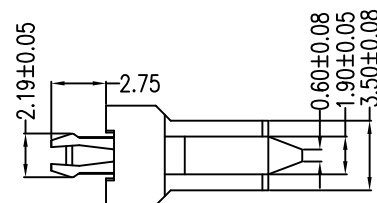
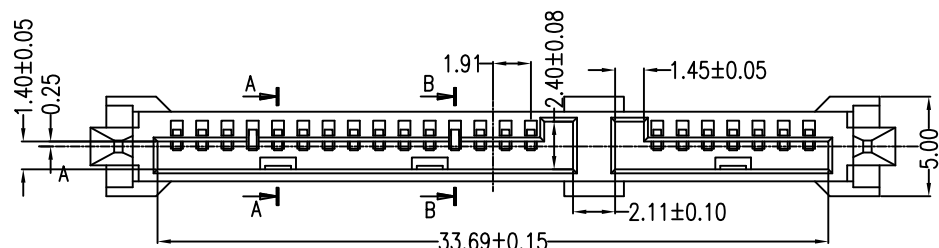

**NOTES:**

**\*Material**

Housing: LCP+50%G.F, UL 94V-0 rated; Color: Black.  
 Contact: Phosphor Bronze  
 Plating: Au Plating On Contact Area, Sn(100u"Min.)Plating On Solder Tail, Ni(40u" Min.) Underplating Overall.  
 Harpoon: Brass  
 Plating: Sn(100u"Min)Plating Over Ni(50u"Min)

**\*Mechanical**

Insertion Force: 45N max.  
 Withdrawal Force: 10N min.  
 Durability: 500 cycles.

**\*Electrical Specification**

Current Rating: 1.5 Ampere Per Contact.  
 Contact Resistance: 30 Milliohms max.  
 Insulation Resistance: 1000 Megohms min.  
 Dielectric Withstanding Voltage: 500 VAC

**\*Environmental**

Operating Temperature: 0°C to +85°C

**\*How To Order**

2SAT-F22-R5M-70

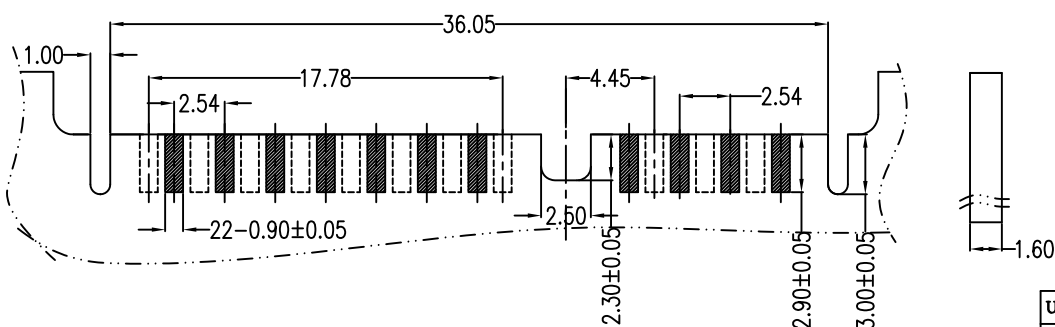
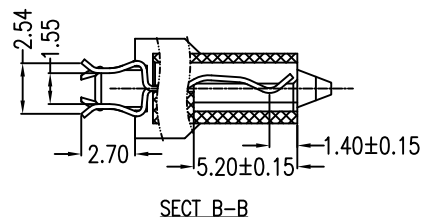
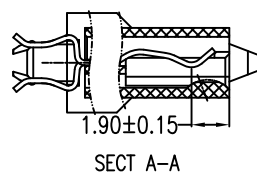
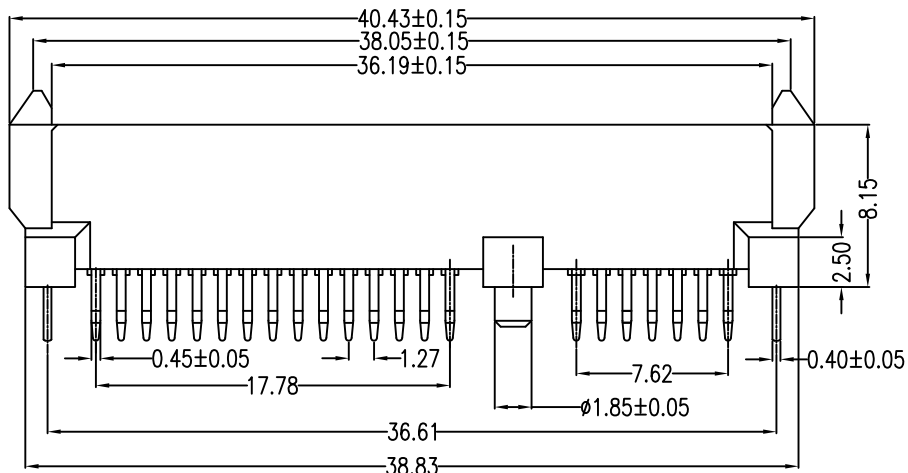
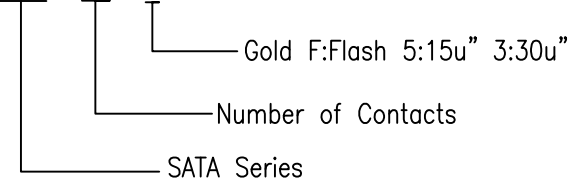

P.C.B LAYOUT(T=1.60)  
COMPONENT SIDE

Units	mm	Scale	5:2	Drawing By	Data	SINGATRON U.S.A.				
Tolerance Unless Otherwise Specified				Alan	3/4-'15	Date	03/04/15	Title	Straight Serial ATA Two Row Straddle Type Female	
.X	~	±0.38		Reviewed By	Data	Sheet	1 of 1			
.XX	~	±0.25		Sharon	3/4-'15	Third Angle Projection				
.XXX	~	±0.20		Approval By	Data					
Angle	~	± 3°		Jason	3/4-'15	Drawing No.	2SAT-F22-R5M-70	REV	B1	