

REV.	ECN.NO.	DATE
A	RELEASED	03/10/05
B	Revise Cavity, Part NO.,Size, P.C.B.	04/19/05
C	Revise Notes	07/13/06

NOTES:

***Material**

Housing: LCP,UL 94-0 Rated;
Contact: Brass;
Plating: Gold plating over Nickel on contact area; Tin Plating on Solder Tail.

***Mechanical**

Insertion Force: 4080g max;
Withdrawal Force: 1020g min;
Durability: 2500 cycles.

***Electrical Specification**

Operation Voltage:100 VAC max.
Current Rating: 1.5 Ampere per contact
Contact Resistance: 30m OHM MIN.
Insulation Resistance: 1000M OHM MIN
Dielectric Withstanding Voltage:500VAC.

***Environmental**

Operating Temperature : -55°c to +125°c.

***How to order:**

2SAT-M07-R5D-0S
 Blank:Black Y:Yellow(810C) R:Red(185C)
 0:DIP(3.10mm) 1:DIP(2.05mm)
 Gold F:Flash 5:15u" 2:20u" 3:30u"
 Number of contacts

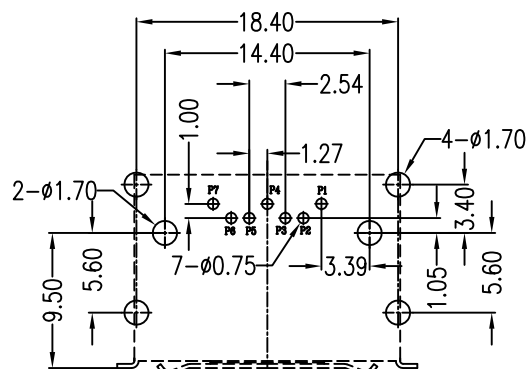
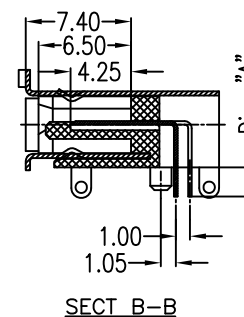
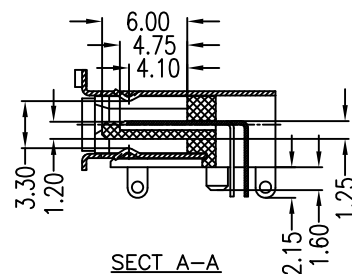
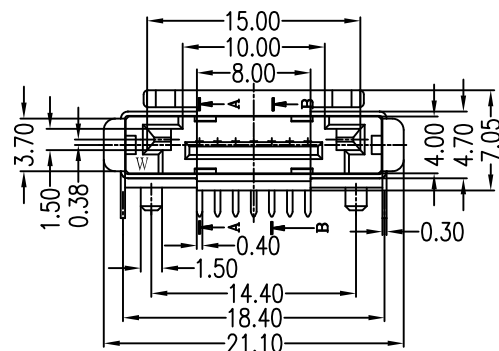
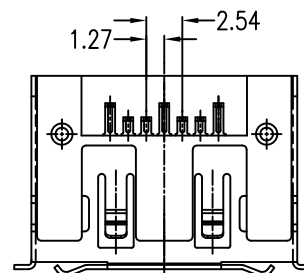
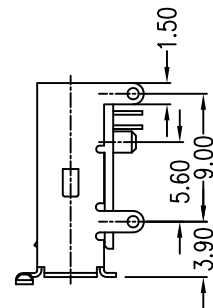
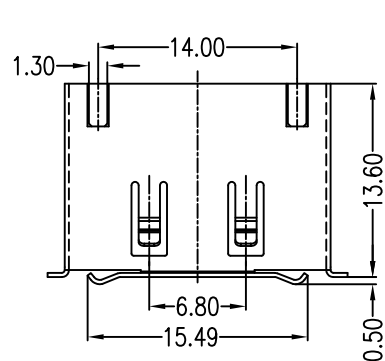

P.C.B Layout
t=1.60mm

Part NO.	Dim "A"
2SAT-M07-R5D-0S	3.10mm
2SAT-M07-R5D-1S	2.05mm

REV	Insertion/Withdrawal Force: 2550g max/ 710g min— 4080g max/ 1020g min			Drawing By		Date		SINGATRON U.S.A.			
Units	MM	Scale	1:1	Peter	07/13/06	Date	07/13/06	Title	Serial ATA II 7P 90° DIP		
Tolerance Unless Otherwise Specified				Reviewed By	Sharon	Date	07/13/06		Sheet	1 of 1	Type Male Single Spring
	.X	~ ±0.38		Approval By	Jason	Date	07/13/06	Third Angle Projection			
	.XX	~ ±0.25						Drawing No.	2SAT-M07-RxD-0S	REV	C
	.XXX	~ ±0.20									
	Angle	~ ± 3°									