

REV.	ECN.NO.	DATE
A	RELEASED	09/25/08
B	REVISE DIMENSION	12/26/08

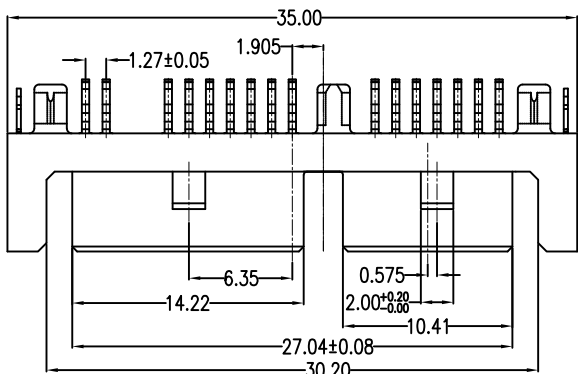

Pin Number	Signal Name
S1	GND
S2	RX+
S3	RX-
S4	GND
S5	TX-
S6	TX+
S7	GND

Pin Number	Power Line Designation
P1	+3.3V
P2	+3.3V
P3	GND
P4	GND
P5	+5.5V
P6	+5.5V
P7	DAS/DSS
P8	Optional
P9	Optional

NOTES:

***Material**

Housing: LCP, UL 94V-0 rated, Color: Black;
 Contact: Brass;
 Plating: Gold plating over Nickel on contact area; Tin plating on solder tail.
 Harpoon: Brass;
 Plating: Tin plating over Nickel.

***Mechanical**

Insertion Force: 45N max.
 Withdrawal Force: 10N min.
 Durability: 500 cycles

***Electrical Specification**

Current Rating: 1.5 Ampere per contact;
 Contact Resistance: 30 Milliohms max.
 Insulation Resistance: 1000 megohms min.
 Dielectric Withstanding Voltage: 500 V AC.

***Environmental**

Operating Temperature: -55°C to +85°C

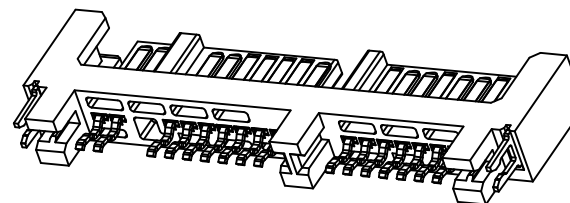
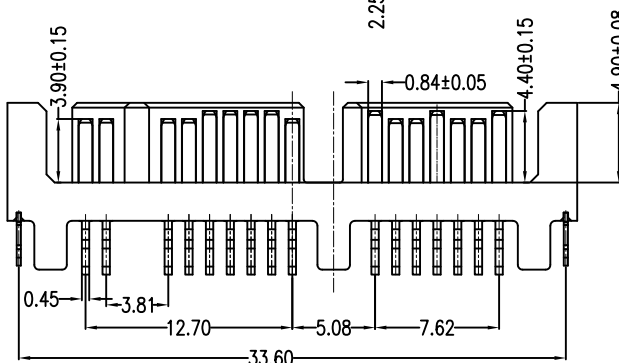
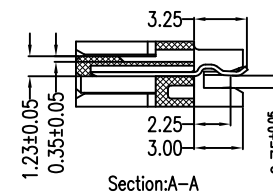
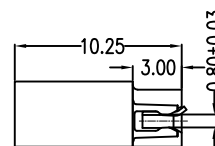
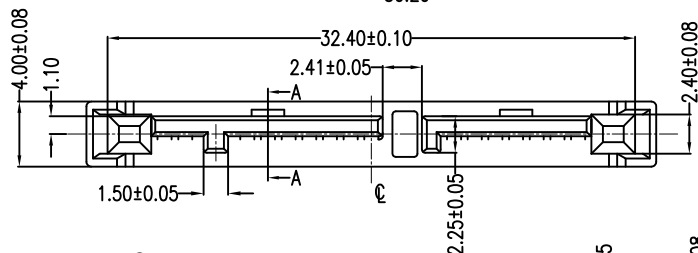

Product 3D

2SAT-M16-R5M-00

Series No.

NO. of Contacts

Selective Gold:
 F:Flash,5:15u",3:30"

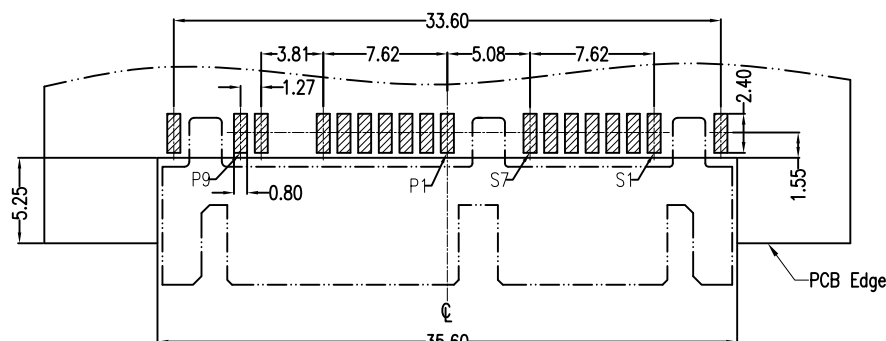

PCB LAYOUT (T=0.85)
 Top View

Units	mm Scale	2:1	Drawing By	Data	SINGATRON U.S.A.			
			Peter	12/25-'08	Date	12/25/08	Title	Serial ATA 7+7+2P Straddle Male
			Reviewed By	Data	Sheet	1 of 1		
			Sharon	12/25-'08	Third Angle Projection			
			Approval By	Data	Drawing No.	2SAT-M16-RxM-00	REV	B
			Jason	12/25-'08				
Tolerance Unless Otherwise Specified								
.X	~	±0.38						
.XX	~	±0.25						
.XXX	~	±0.20						
Angle	~	± 3°						