

1 2 3 4 5 6 7 8

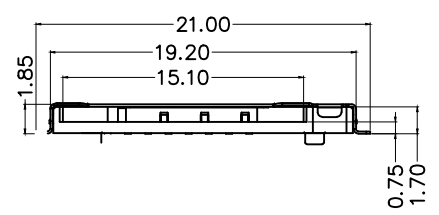

SIM pin assignment	
PIN#	Name
C1	VCC
C2	RST
C3	CLK
C5	GND
C6	VPP
C7	I/O

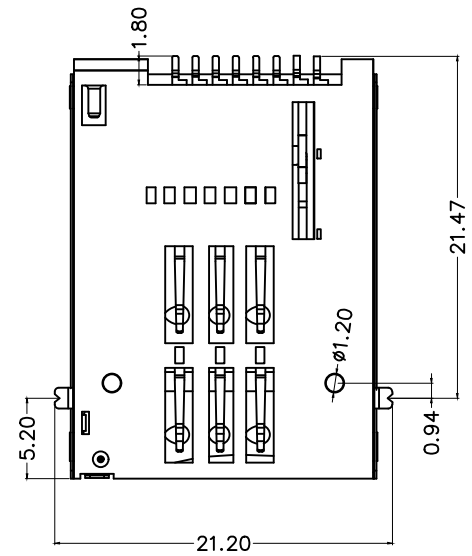
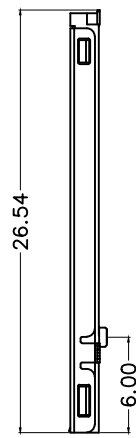
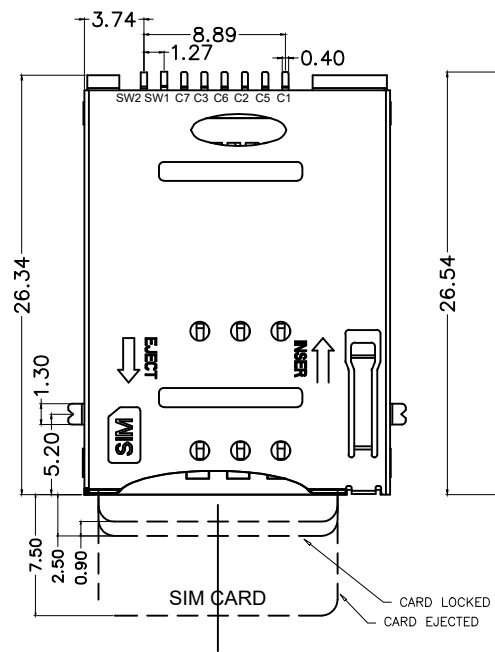
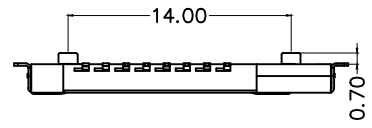
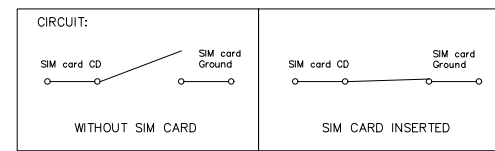

- 1.SPECIFICATIONS
 INSULATION RESISTANCE: 500M min.AT DC 500V DC
 WITHSTANDING VOLTAGE: 250V ACrms FOR 1 MINUTE
 CONTACT RESISTANCE: 100M max. AT 10MA/20mV max
 CURRENT RATING: 0.5A
 VOLTAGE RATING: 5.0 vrms
 OPERATING TEMP.RANGE:-55 C+85 C
 MATING CYCLES: 5000 INSERTIONS
- 2.MATERIAL:
 INSULATOR: H-TEMPERATURE PLASTIC,UL 94V-0,
 COLOR*BLACK
 TERMINAL: COPPER ALLOY,T=0.15mm
 SHELL: STAINLESS STEEL,T=0.15mm
- 3.FINISH:
 TERMINAL:50u" min NICKEL UNDERPLATED ON ALLOVER,GOLD PLATING
 ON CONTACT ARER, 80u"min TIN ON SOLDER TAIL.
 SHELL:50u" NICKEL UNDERPLATED ON ALLOVER, GOLD FLASH ON SOLDER LATCH

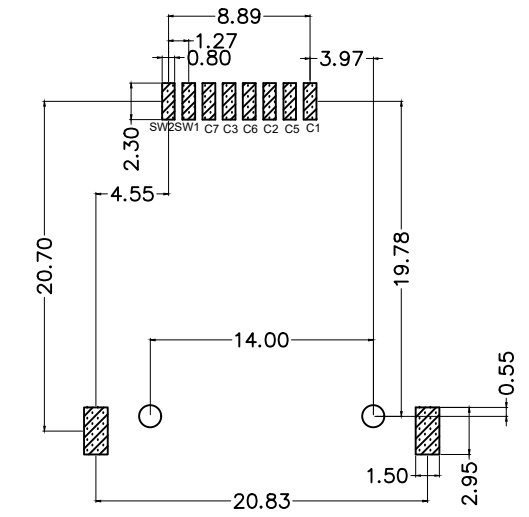

PCB 焊盘区
 RECOMMENDED PCB LAYOUT
 GENERAL TOLERANCE ± 0.05

Singatron Enterprise Co., Ltd.					
GENERAL TOLERANCE		TITLE SIM Card Conn.Standard Push Type, H:1.85,with post			
XX. \pm	XXX. \pm	DWN	COCO 2012/05/10	PART NO.2SM6403-ST018521D0-1S	
X. ± 0.30	.XXX ± 0.05	CHKD	CHARLES	SCALE 1:1	UNIT: mm
.X ± 0.25	X. $\pm 3'$	APVD	JAMES	SIZE: A3	SHEET:1 OF 1
.XX ± 0.20	.X' $\pm 2'$	CUSTOMER COPY			
REV: A					

1 2 3 4 5 6 7 8