

REV.	ECN NO OR DESCRIPTION	REVISED	DATE
A	PDR NO:S150610-4A	jttlucky	2016.04.19

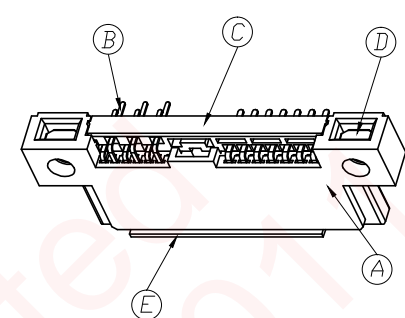

- NOTES
- MATERIAL: See drawing
  - ELECTRICAL
    - Insulator resistance: 1000M ohms Min. @ 500 VDC
    - Withstanding voltage: 500 VAC / minute
    - Contact resistance: 45m ohms Max.
  - MECHANICAL
    - Mating force: 20N Max.
    - Unmating force: 4N Min.
    - Durability: 500 cycles Min.
    - Contact retention force: 4N(0.40kgf) Min

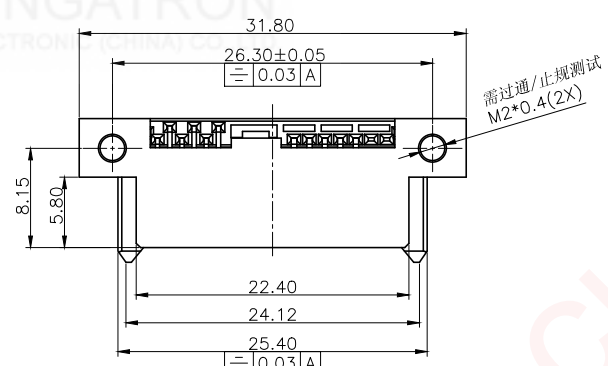
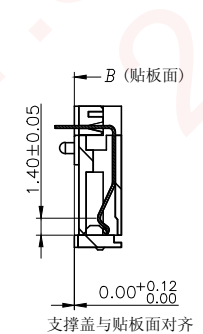
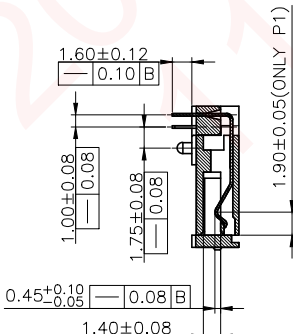
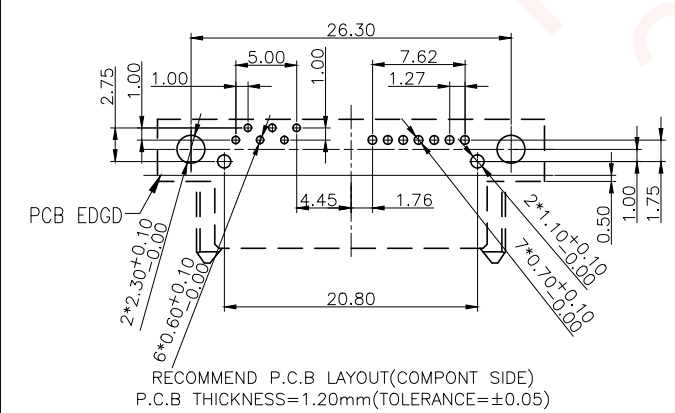
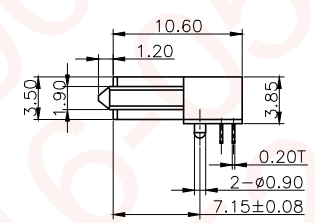
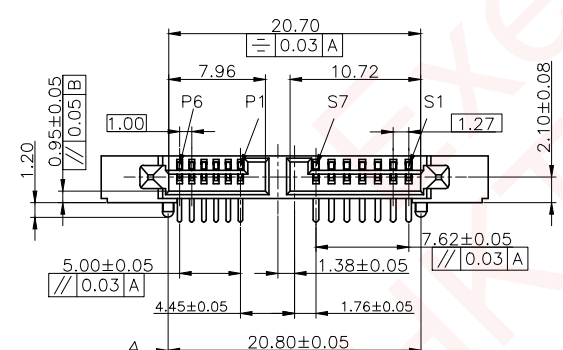
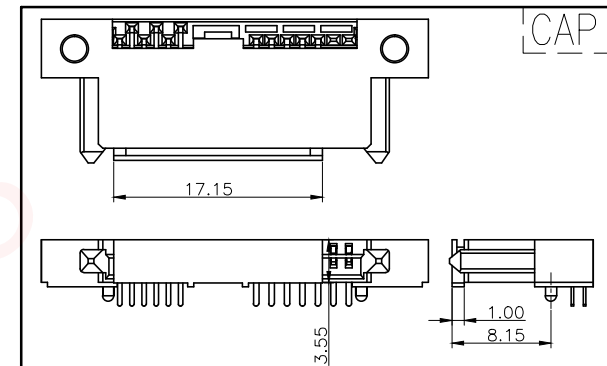

NO	DESCRIPTION	QTY	MATERIAL	PLATING & COLOR
E	COVER	1	LCP +30% G.F UL 94V-0	BLACK
D	NUT	2	COPPER ALLOY	OVER Ni 50u"MIN.
C	CAP	1	LCP +30% G.F UL 94V-0	BLACK
B	CONTACT	13	PHOSPHOR BRONZE	Au 1U" PLATING ON CONTACT AREA; 80U" MIN. MATTE TIN PLATING ON ;
A	HOUSING	1	LCP +30% G.F UL 94V-0	BLACK

UNLESS OTHERWISE SPECIFIED TOLERANCES		Singatron Enterprise Co., Ltd. 信音企业股份有限公司	
DECIMALS:	ANGLES:	TITLE: SATA CONN DIP TYPE H=2.1mm	
X :±0.5	X :±2°	DWN	jttlucky PART NO.2ST3Y04-000111F
X.X :±0.3	X.X :±1°	CHKD	james SCALE:1:1 UNIT: mm
X.XX :±0.2		APVD	boye SIZE: A3 SHEET:1 OF 1 REV: A
<b>CUSTOMER COPY</b>			