

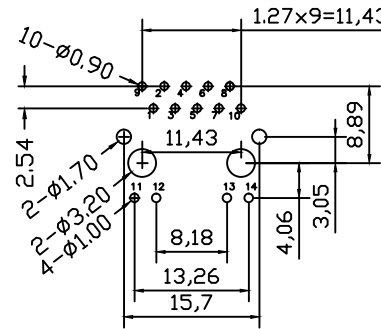

| REVISION RECORD | | | | |
|-----------------|-----|-------------|------|------|
| REV | ECO | DESCRIPTION | DRFT | CHKD |
| | | | | |

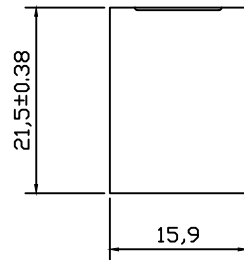

PCB Layout

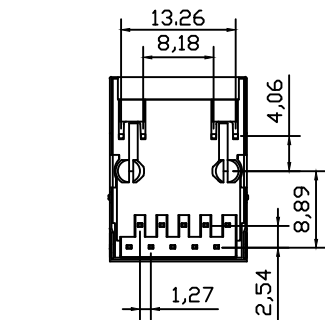
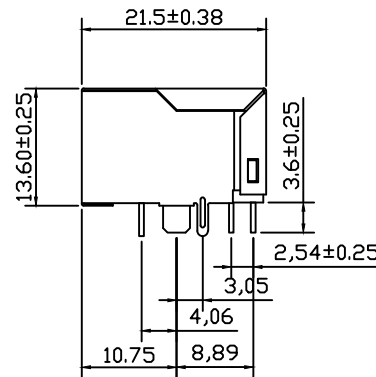
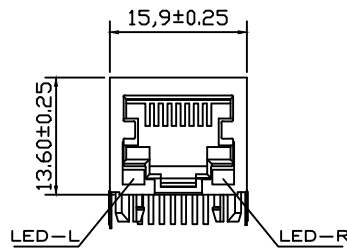

| Standard LED | Wavelength | Forward*V(MAX) | TYP |
|--------------|------------|----------------|------|
| Green | 565nm | 2.5v | 2.2v |
| Yellow | 565nm | 2.5v | 2.1v |

With a forward current of 20mA

NOTE:

- Shielded - 0.20mm THICKNESS BRASS C2680 H. PLATING NICKEL 30u"-50u".
- Housing- Standard Material Nylon66,Glass Filled Polyester UL94V-0 Standed Color Black.
- Insert Pin- Plastic:PBT UL94V-0,Standard Color Black. Pini:0.35mm Thickness Phos-Bronze C5210 EH. Plating:Nickel40u"~60u" for all and Sn 100% ,and Gold Plating.
- Contact Pin- Plastic:PBT,Glass Filled,UL94V-0, Standard Color Black. Pini:0.35mm SUS430. Plating:Nickel40u"~60u" for all and Sn 100%.

Ordering Code:

XXXXXX XX XX X X X
① ② ③ ④ ⑤ ⑥

- Series No.
- Transformer Type:
- Shield Type.
- R=標準料;H=高溫料.
- LED Code: See above table
- RJ45 Plating

| | |
|----------------|------------------|
| DFTO K-Y | DATE: 2014/03/10 |
| CHKD W-P-Huang | DATE: 2014/03/10 |
| MFO W-P-Huang | DATE: 2014/03/10 |
| APPVL | DATE: |
| 股線角: | 顏色: |
| MATERIAL: | |
| TREAT: | |
| 處理: | |
| Q'TY: | |
| 數量: | |
| SCALE: | 1:1 |
| 比 例: | |

| | | | |
|--------------------|--|--------|-----|
| SINGATRON (U.S.A.) | | | |
| TITLE | RJ45 1PORT TRANSFORMER CONNECTOR (10/100 Base-T) | | |
| 名稱 | | | |
| DRAWING NO. | 2TJ131-C714RA1 | SIZE | REV |
| 圖檔編號 | | A3 | A |
| DRAWING NO. | | 1 of 2 | |
| 客戶編號 | | | |

| Code | RJ45 Plating | | | LED Code | | | |
|------|--------------|----------------|---------------|----------|---------|-----------|---------|
| | Contact Area | Solder tail | Under plating | Left LED | | Right LED | |
| F | 3u" gold | 150u" Tin Min. | 50u" Nickel | +11,-12 | -11,+12 | +13,-14 | -13,+14 |
| 1 | 6u" gold | | | Green | - | Yellow | - |
| 2 | 15u" gold | | | Yellow | - | Green | - |
| 3 | 30u" gold | | | Green | - | Green | - |
| 4 | 50u" gold | | | D | Green | - | Yellow |
| | | | | E | Yellow | - | Green |
| | | | | F | Yellow | - | Orange |
| | | | | G | Orange | Green | Yellow |
| | | | | H | Green | - | Yellow |
| | | | | 0 | - | - | - |

Schematic:



| REVISION RECORD | | | | |
|-----------------|-----|-------------|------|------|
| REV | ECO | DESCRIPTION | DRFT | CHKD |
| | | | | |

Type C7

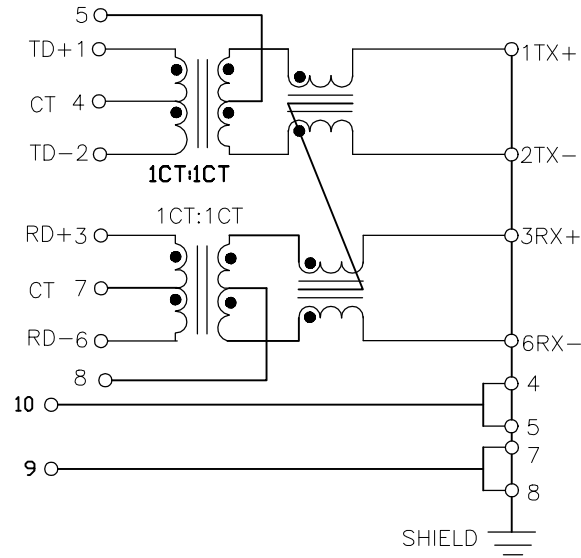

| Electrical Specifications @25°C | | | | | | | | |
|---------------------------------|---------|--|----------------------|--------|--------|---------|---------------------|------------------|
| Turns Ratio (±2%) | | DCL (uH Min.) @100 KHz/0.1V with 8mA DC Bias | Cross talk (dB Min.) | | | | HI-POT 1.0 mA (V) | |
| TX | RX | | 0.5-10 MHz | 30 MHz | 50 MHz | 100 MHz | WITHOUT CAPACITANCE | WITH CAPACITANCE |
| 1CT:1CT | 1CT:1CT | 350 | -50 | -40 | -35 | -30 | 1500 AC | 2250 DC |

| Continue | | | | | | | |
|--------------------------|---------------------------|--------------------------------------|-----------|--------|-----------|--------------------------|---------------|
| Insertion Loss (dB Max.) | | Return Loss (dB Min.) @ Load 100 OHM | | | | | CMR (dB Min.) |
| 1-100 MHz | 100-125 MHz (10/100/1000) | 1-30 MHz | 30-50 MHz | 60 MHz | 60-80 MHz | 80-100 MHz (10/100/1000) | 1-100 MHz |
| -1.0 | -1.2 | -18 | -16 | -14 | -12 | -10 | -30 |

Environmental:

- 1.Storage Temp: -40°C to +85°C.
- 2.Operating Temp: 0°C to +70°C.
- 3.MATES WITH MODULAR PLUG CONFORMING TO FCC PART 68,SUBPARTF.

PROFILE OF WAVE SOLDER :

- 1.Peak temperature(Tp) :250°C±5°C.
- 2.Peak temperature(Tp) time: 5sec max.

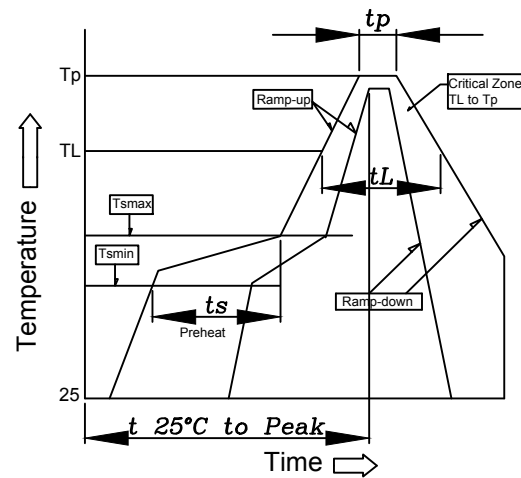

Part Number:

2TJ131-C714RA1

- Plating: 1:Gold 6u"
- With LED Type.
- Standard operation temp.
- Locate: rear of 3.05
- Without fingers.
- Transformer Type.
- Series No.

| | | |
|------------------------|------------------|----------------------------------|
| DFTO K-Y | DATE: 2014/03/10 | SINGATRON (U.S.A.) |
| CHKD W-P-Huang | DATE: 2014/03/10 | |
| MFO W-P-Huang | DATE: 2014/03/10 | |
| APPVL | DATE: | |
| 單位 MM | 角處公差 | TITLE |
| 長度公差 | ± | 名稱 |
| .0 ±0.38 | ± | RJ45 1PORT TRANSFORMER CONNECTOR |
| .00 ±0.20 | ± | (10/100 Base-T) |
| .000 ±0.10 | ± | DRAWING NO. 2TJ131-C714RA1 |
| THIRD ANGLE PROJECTION | TREAT: | 圖檔編號 |
| 第三角 | 處理 | 2TJ131-C714RA1 |
| 角 | Q'TY: | SIZE A3 |
| 比 | 數量 | REV A |
| 1:1 | SCALE: | DRAWING NO. |
| | 1:1 | 客戶編號 |
| | | 2 of 2 |