

1

2

3

4

5

6

7

8

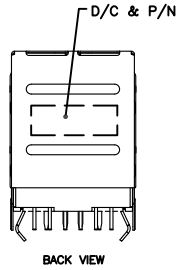
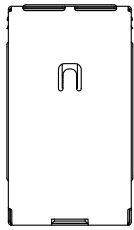

SCHEMATIC FOR RJ45:

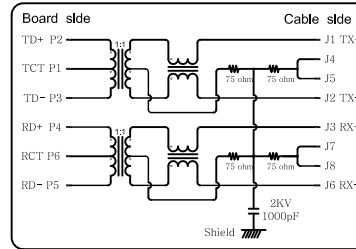

SPECIFICATIONS :

- MATERIAL**
 - HOUSING : THERMOPLASTIC, PBT+30%GF, UL 94V-0, BLACK,HSF
 - MODULE CASE & SPACER : THERMOPLASTIC, LCP UL 94V-0, BLACK,HSF
 - RJ CONTACTS : PHOSPHOR BRONZE, C5210R-EH
 - PLATING : SELECT GOLD ON CONTACT AREA (SEE PART NO), 100U" MIN TIN PLATING ON SOLDER TAILS, 30U"MIN NICKEL OVERALL
 - RJ SOLDER TAIL TERMINAL : BRASS, C2680R-EH
 - PLATING : 100U"MIN TIN ON 30U"MIN NICKEL OVERALL
 - RJ SHIELD : STAINLESS, THICKNESS=0.2MM, PRE-SOLDERING
 - USB TERMINAL : BRASS
 - PLATING : SELECT GOLD ON CONTACT AREA (SEE PART NO), 100U" MIN TIN PLATING ON SOLDER TAILS, 30U"MIN NICKEL OVERALL
 - USB SHIELD : BRASS
 - PLATING : 30U"MIN NICKEL
- ELECTRICAL**
 - INSULATION RESISTANCE : 500 MOHMS MIN
 - DIELECTRIC WITHSTANDING VOLTAGE : 1500 VAC FOR 1 MINUTE
- DURABILITY TEST RATING**
 - RJ45**
 - INSERTION FORCE WITH THE LATCH DEPRESSED :22N MAX
 - REMOVAL FORCE WITH THE LATCH DEPRESSED :44N MAX
 - DURABILITY :750 CYCLES
 - USB**
 - INSERTION FORCE : 35N MAX
 - REMOVAL FORCE : 10N MIN
 - DURABILITY :1500 CYCLES
- OPERATING AND STORAGE TEMPERATURE**
 - OPERATING TEMPERATURE : 0°C TO +70°C
 - STORAGE TEMPERATURE : -40°C TO +85°C
- TEMPERATURE CONDITION OF WAVE SOLDERING:**

ELECTRICAL CHARACTERISTICS :

- INSERTION LOSS :**
 - 1~100 MHz -1.0dB MAX.
- RETURN LOSS(LOAD 100Ω) :**
 - 1~30 MHz -18dB MIN
 - 30~60 MHz -16dB MIN
 - 60~80 MHz -12dB MIN
- COMMON MODE REJECTION**
 - 1~100 MHz -30dB MIN
- CROSS TALK**
 - 1~100 MHz -30dB MIN
- INDUCTANCE @ 100KHz, 0.1V, 8mA DC BIAS**
 - (P2-P3),(P4-P5) : 350 uH MIN
- DCR**
 - (J1-J2),(J3-J6) : 1.2 OHM MAX
- HI-POT TEST**
 - PCB SIDE TO CABLE SIDE : 1500VAC 60S OR 2250VDC 60S
- URNS RATION 100KHz**
 - (P2-P3) : (J1-J2) = 1:1 ±%3
 - (P4-P5) : (J3-J6) = 1:1 ±%3

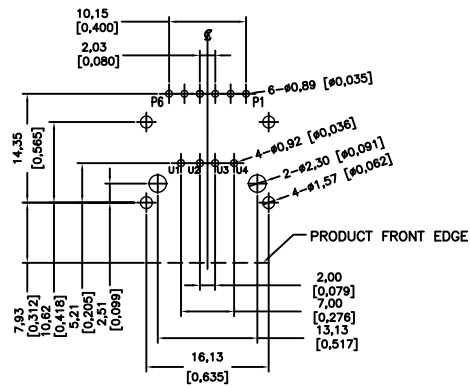
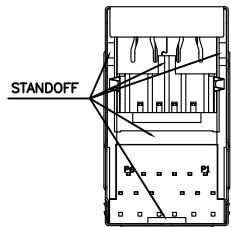
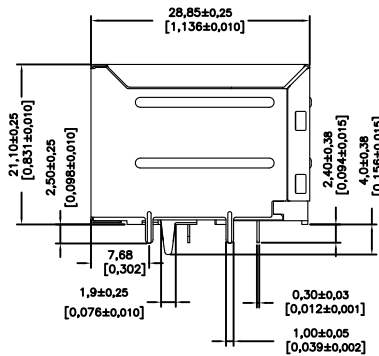
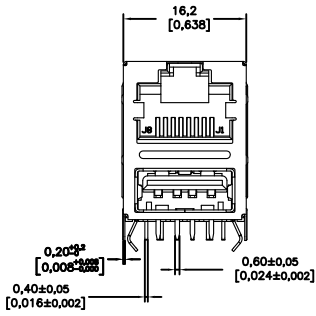
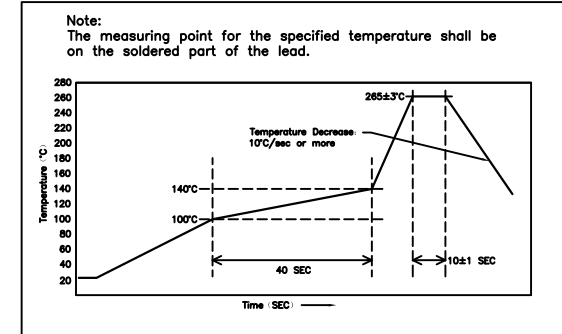

RECOMMENDED PCB LAYOUT (COMPONENT SIDE VIEW)

PART NO : 2TJ915-0284140011

Series Code: _____ Package Code: 1: Tray
 Environmental Code: 0: ROHS Plating Code: 1: Gold Flash
 Mechanical Code: 28: Without All Spring
 Schematic Code: 414: 414 Circuit
 LED Code: 00: Without LED

HSF COMPLIANT

21-Jul-17

GENERAL TOLERANCE

.X± 0.20	X.*± 1"
.XX± 0.10	.X*± 0.5"
.XXX±	

Singatron Enterprise Co., Ltd.

TITLE	RJ45 IMC,100BASE-T,LED OPTION			
DWN	Tony Zheng	PART NO.2TJ915-0284140011		
CHKD	Herry	SCALE 1:1	UNIT: mm	
APVD	Herry	SIZE: A3	SHEET:1 OF 1	REV: A

CUSTOMER COPY