

F  
E  
D  
C  
B  
A

1

2

3

4

5

6

7

8

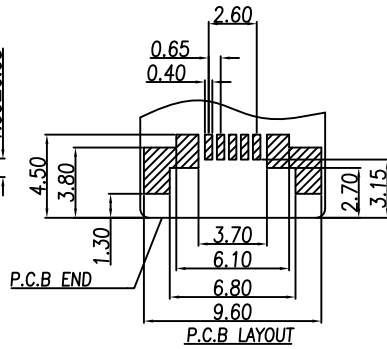
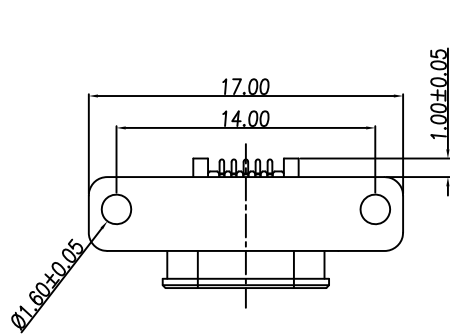

FIG.2 MATING CONDITION

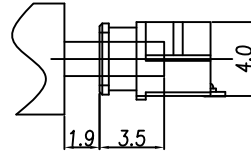
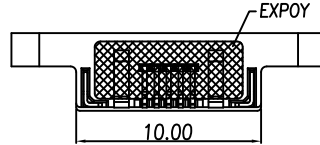
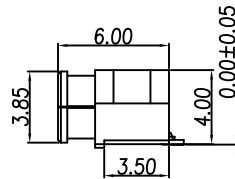
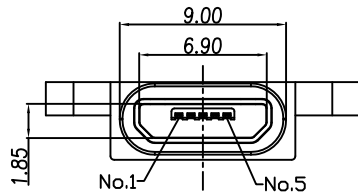
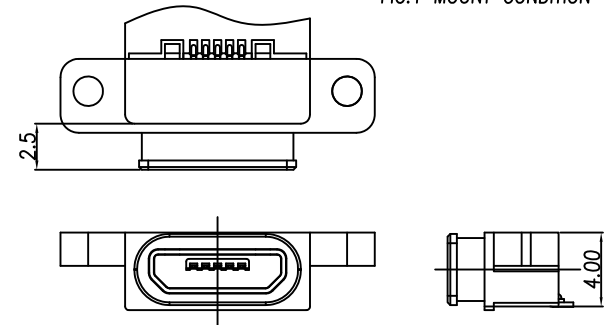

FIG.1 MOUNT CONDITION



## NOTE:

## 1. MATERIAL :

- 1-1. HOUSING : LCP UL94V-0 ; COLOR : BLACK  
1-2. CONTACT : PHOSPHOR BRONZE  
1-3. SHELL : STAINLESS STEEL  
1-4. O-RING : SILICON  
1-5. PAD : BRASS

## 2. FINISH :

- 2-1. CONTACT : CONTACT AREA : GOLD 10u"  
GOLD FLASH ON OTHER AREA  
UNDERPLATED : NICKEL 50u"  
2-2. SHELL : MATTE TIN PLATED  
2-3. PAD : MATTE TIN PLATED

## 3. ELECTRICAL SPECIFICATION :

- 3-1. CONTACT CURRENT RATING : 1.8A (ONLY PIN1&5) ; OTHER 0.5A (ONLY PIN2,3&4)  
3-2. CONTACT VOLTAGE RATING : 30V  
3-3. CONTACT RESISTANCE : 30m Ohm MAX  
3-4. INSULATION RESISTANCE : 100M Ohm MIN AT DC 500V.  
3-5. DIELECTRIC WITHSTANDING VOLTAGE : AC 100V AC/1 MINUTE 10mA.  
3-6. WATERPROOF : IPX7

## 4. Environmental :

- 4-1. Operation Temperature : -40°~85°

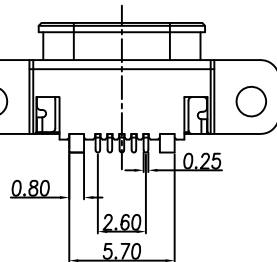
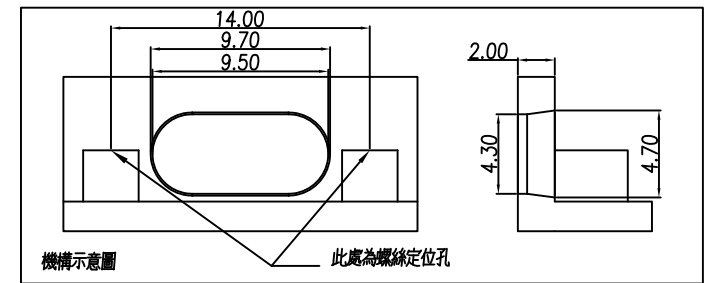
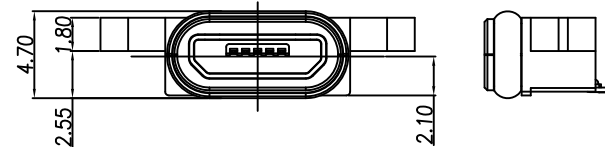

FIG.3 GASKET INTEGRATION CONDITION



Singatron Enterprise Co., Ltd.

TITLE waterproof micro usb 5P(F) SMT (定位柱)

TOLERANCE	DWN	Yeh Chou	PART NO. 2UB-W05F2-102-11	A
.x ±0.20	CHKD	Emily Suen	SCALE 1:1 UNIT: mm	
.xx ±0.10	APVD	Emily Suen	SIZE: A3 SHEET: 1 of 2	REV: A
.xxx ±0.05	CUSTOMER COPY			
.xxxx ±0.03				
ANGULA ±1°				

1

2

3

4

5

6

7

8



步驟一:

- 1.將成品一一放入包裝盤內,依同一方向置入.
- 2.包裝方式,如圖所示.
- 3.一個包裝盤1100pcs.

步驟二:

- 1.一個紙箱可以裝10個包裝盤.
- 2.每盤1100pcs,每箱11000pcs.
- 3.將包裝盤放入防水袋中,包裝完後再封箱.

步驟三:

- 1.用膠帶將紙箱封實.
- 2.將標籤貼於紙箱上.

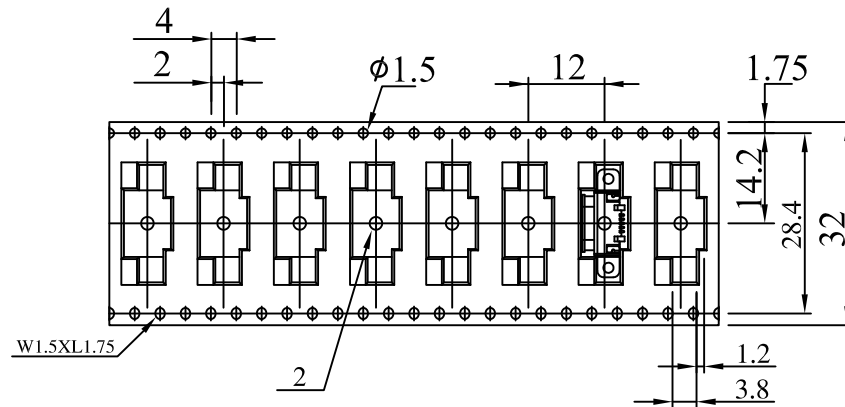
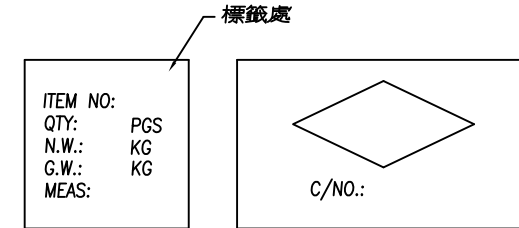
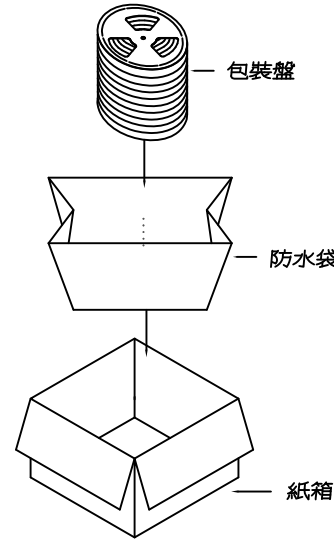
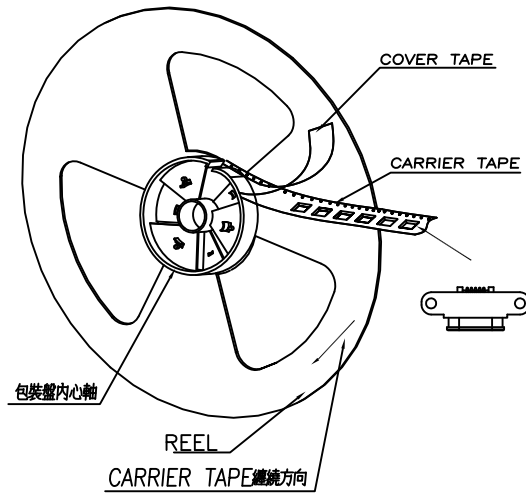
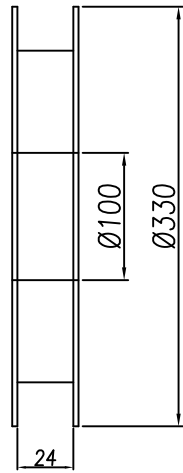

NOTE:

- 1.若有未裝滿之零數箱,必須以緩衝材塞滿.
- 2.在搬運過程中要輕拿輕放.
- 3.載運輸中不可堆放過多,不可有重壓現象.
- 4.在裝滿產品後,必須空留帶前和帶後10格以上,然後用紙膠布貼上.
- 5.上帶在貼下帶時必須平整,且黏貼處不要出現氣泡.

Singatron Enterprise Co., Ltd.

TITLE waterproof micro usb 5P(F) SMT (定位柱)

TOLERANCE	.x ±0.20	.xx ±0.10	.xxx ±0.05	.xxxx ±0.03	ANGULA ±1°
DWN	Yeh Chou	PART NO. 2UB-W05F2-102-11	SCALE 1:1	UNIT: mm	REV: A
CHKD	Emily Suen	SIZE: A3	SHEET: 2 of 2		
APVD	Emily Suen				

CUSTOMER COPY