

REV.	ECN NO OR DESCRIPTION	REVISED	DATE
A	PRODUCT RELEASE	Ye wei	2023.04.24

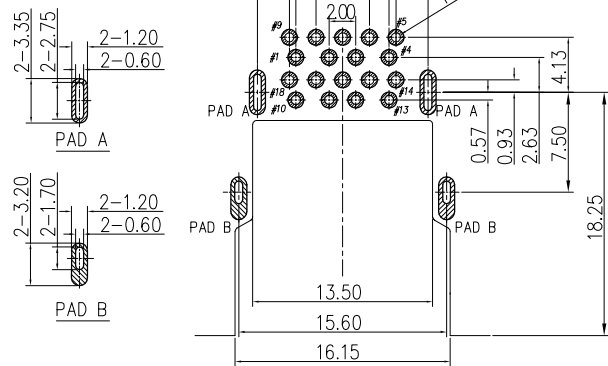
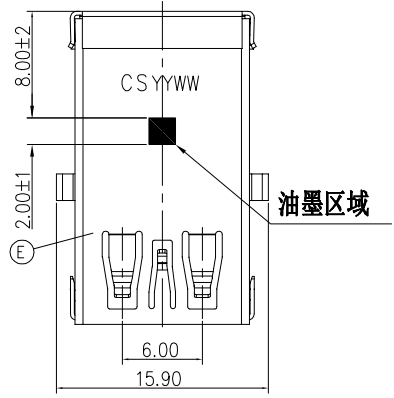

RECOMMENDED P.C.B. LAYOUT  
TOLERANCE (TOP VIEW) ±0.05mm

SPECIFICATIONS:

- ELECTRICAL CHARACTERISTICS:
  - CURRENT RATING: 1.8A (VBUS&GND) ; OTHER CONTACTS 0.25A
  - CONTACT RESISTANCE: 30mΩ (INITIAL)MAX.
  - DIELECTRIC WITHSTANDING VOLTAGE: 500V AC FOR 1 MINUTE
  - INSULATION RESISTANCE: 100MΩ MIN. MEASURED BY 500 VDC.
- MECHANICAL CHARACTERISTICS:
  - INSERTION FORCE : 35N MAX. INITIAL.
  - WITHDRAWAL FORCE : 9.8N MIN INITIAL, 8N MIN, FOR AFTER TEST.
- LIFE TEST:5000 CYCLES,
  - OPERATING TEMPERATURE: -55~+85°C
- OTHER GENERAL SPEC TO REFER "USB 3.0 SERICE\_SPEC"
- TO CONFORM TO SINGATRON HAZARDOUS SUBSTANCE FREE SPEC.
- HALOGEN FREE PRODUCT IDENTIFICATION MARK : ⊙
- HALOGEN FREE PRODUCT IDENTIFICATION LABEL ON PACKAGING:
- FOR IR REFLOW ROFILE,PEAK TEMPERATURE:260°C MAX.10SECS.
- PACKAGING : TAPE & REEL.

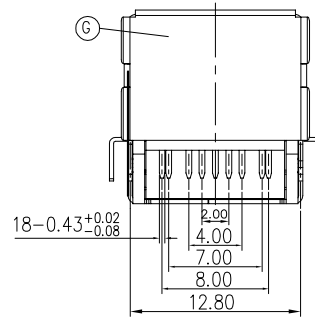
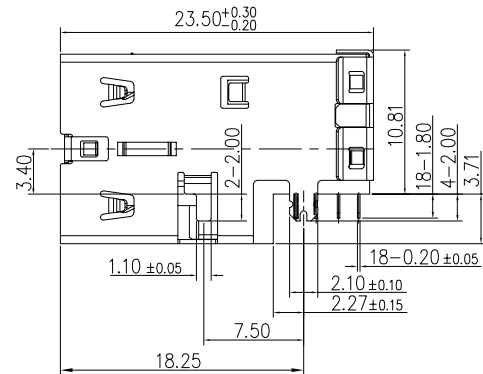
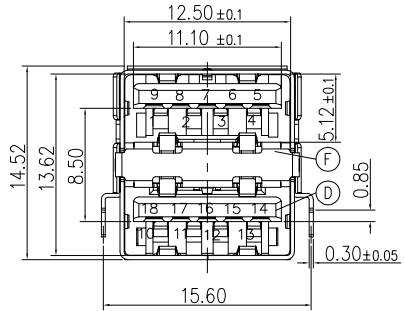

REMARK	PIN NO.:		SIGNAL NAME
USB2 CONTACT PIN	1	10	VBUS
	2	11	D-
	3	12	D+
	4	13	GND
USB3 CONTACT PIN	5	14	SSRX-
	6	15	SSRX+
	7	16	GND_DRAIN
	8	17	SSTX-
	9	18	SSTX+

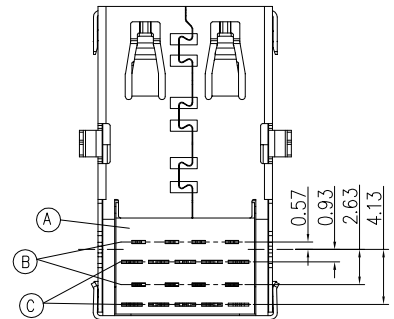

NO	DESCRIPTION	QTY	MATERIAL	PLATING & COLOR
G	REAR SHELL	1	STAINLESS STEEL	CLEAN
F	FINGER	1	STAINLESS STEEL	CLEAN
E	SHELL	1	STAINLESS STEEL	ALL OVER NICKEL PLATING
D	HOUSING	1	HI-THERMAL PLASTICUL94V-0	SEE TABLE
C	USB3.0 CONTACT	10	BRASS	SEE TABLE
B	USB2.0 CONTACT	8	COPPER ALLOY	SEE TABLE
A	STOPPER	1	HI-THERMAL PLASTICUL94V-0	SEE TABLE

TABLE

PART NO.:	PLATING & COLOR	
2UB2Y12-300011F	GOLD FLASH ON CONTACT AREA MATTE TIN 100u"MIN. ON SOLDER TAIL NICKEL 50u" MIN. UNDER PLATED	BLACK
2UB2Y12-303011F	Au 30u"MIN. ON CONTACT AREA MATTE TIN 100u"MIN. ON SOLDER TAIL NICKEL 50u" MIN. UNDER PLATED	BLACK

UNLESS OTHERWISE SPECIFIED TOLERANCES

DECIMALS: ANGLES:

X :±0.5 X :±2°

X.X :±0.3 X.X :±1°

X.XX :±0.2

Singatron Enterprise Co., Ltd.  
信音企業股份有限公司

双层USB3.1 DIP TYPE

DWN Ye wei PART NO.2UB2Y12-30X011F

CHKD Jim-deng SCALE 1:1 UNIT: mm

APVD Jim-deng SIZE: A1 SHEET: 10F1 REV: A

CUSTOMER COPY