

RECOMMENDED PCB LAYOUT(TOP VIEW)
THICKNESS 0.8MM:DEFAULT TOLERANCE:±0.05

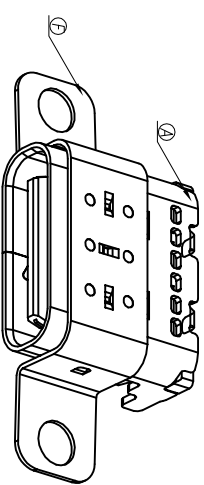

- NOTE:
- MECHANICAL PERFORMANCE:
 - 1-1.INSERTION FORCE: 0.5~2.0kgf.
 - 1-2.REMOVAL FORCE: 0.8kgf~2.0kgf.
 - 1-3.DURABILITY: 10000 CYCLES.
 - ELECTRICAL PERFORMANCE:
 - 2-1. CURRENT RATING:5.0A
VOLTAGE RATING:5.0V
 - 2-2. LCR: VBUS & GND PINS AND OTHER PINS: 40mΩ/PIN MAX.
SHIELD: 50mΩ/MAX
LCR MAX. CHANGE OF ALL PINS: 10mΩ.
 - 2-3.INSULATION RESISTANCE: 100MΩ MIN
 - 2-4.DIELECTRIC WITHSTAND VOLTAGE:AC 100V FOR 1 MINUTE.
 - ENVIRONMENTAL PERFORMANCE:
 - OPERATING TEMPERATURE: -25°C~+85°C.
 - TO CONFORM TO SINGATRON HAZARDOUS SUBSTANCE FREE SPECIFICATION
 - HALOGEN FREE PRODUCT IDENTIFICATION LOGO ON PACKAGING:
 - OTHER GENERAL SPEC.TO REFER"USB TYPE C Series SPEC."

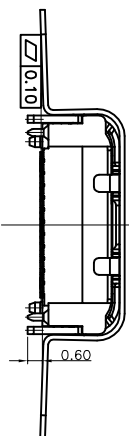
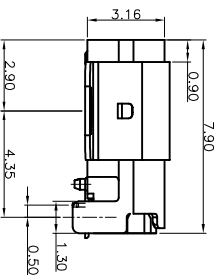
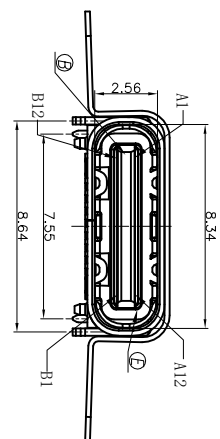
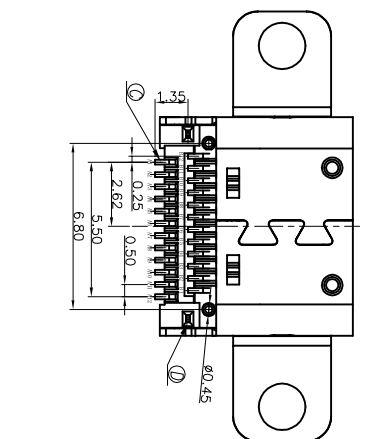

A1	GND	B12	GND
A2	SSTXP1	B11	SSRXP1
A3	SSTXN1	B10	SSRXN1
A4	VBUS	B9	VBUS
A5	CC1	B8	SBUS2
A6	DP1	B7	DN2
A7	DN1	B6	DP2
A8	SBU1	B5	CC2
A9	VBUS	B4	VBUS
A10	SSRXN2	B3	SSTXN2
A11	SSRXP2	B2	SSTXP2
A12	GND	B1	GND
PIN	SIGNAL NAME	PIN	SIGNAL NAME

F	TOP SHELL	1	STAINLESS STEEL	NICKEL 30μ* MIN. UNDER PLATED
E	EMI PLATE	1	STAINLESS STEEL	CLEAR ONLY
D	MID PLATE	1	STAINLESS STEEL	IN 40μ* MIN. UNDER PLATED OVER ALL THE 80μ* MIN. PLATED ON SOLDER AREA.
C	CONTACTS	24	COPPER ALLOY	300μ*MIN Au ON CONTACT AREA GOLD FLASH ON SOLDER AREA 50μ* MIN NICKEL ALL OVER
B	HOUSING	1	LCP UL 94 V-0	BLACK
A	FRONT SHELL	1	STAINLESS STEEL	NICKEL 30μ* MIN. UNDER PLATED
NO	DESCRIPTION	QTY	MATERIAL	PLATING & COLOR
UNLESS OTHERWISE SPECIFIED TOLERANCES				
DECIMALS:	ANGLES:	SINGATRON Enterprise Co., Ltd. 信晋企业股份有限公司		
X :±0.5	X :±2°	TITLE	USB CF DOUBLE SMT WITH SCREW HOLE	
X.X :±0.3	X.X :±1°	DWN	Ye wei	
X.XX :±0.2		CHKD	jim-deng	
		APVD	jim-deng	
CUSTOMER COPY				

REV	ECN NO. OR DESCRIPTION	REVISED	DATE
A	PRODUCT RELEASE	Ye wei	2021.11.12