

RECOMMENDED
PANEL CUT-OUT

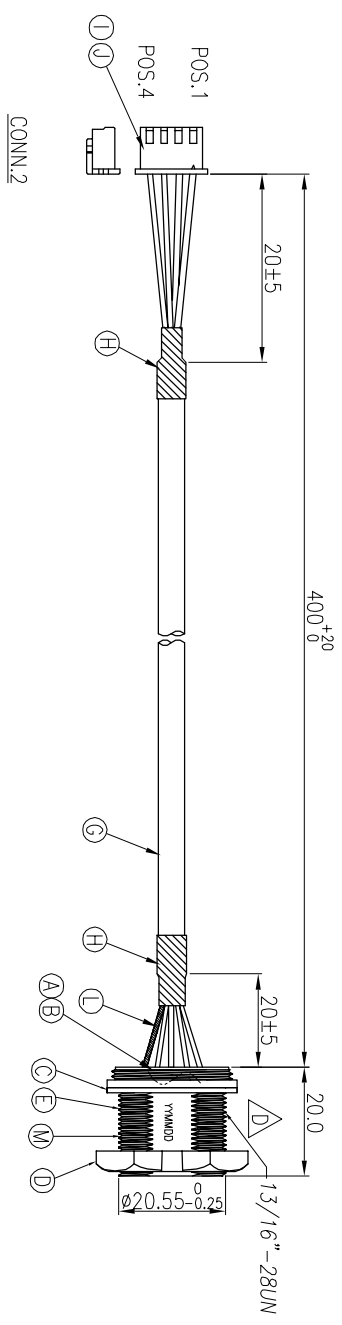

WATERPROOF RATE: IP67
CONN.1

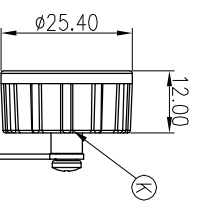

	DRAIN	SHIELD
4	WHITE (28AWG)	4
3	GREEN(28AWG)	3
2	BLACK(24AWG)	2
1	RED (24AWG)	1
CONN.2		CONN.1
WIRE COLOR		
PIN DEFINE		

Twisted Pair

NOTES:

1. WATERPROOF DEGREE OF PROTECTION: IP67(WHEN PROPERLY MATED)
2. RATING: 30V 1A
3. SPECIFICATIONS:SEE "USB SERIES SPECIFICATIONS".
4. TO CONFORM TO SINGATRON HAZARDOUS SUBSTANCE FREE SPEC.
5. GREEN PRODUCT IDENTIFICATION LABEL ON PACKAGING: **RoHS COMPLIANT**
6. FOR PANEL THICKNESS Max.:4.0mm
7. TEMPERATURE RANGE: -20~80℃
8. TIGHTENING TORQUES: 0.8~1.0Nm(7.08~8.85lbf.in.).

1. WATERPROOF DEGREE OF PROTECTION: IP67(WHEN PROPERLY MATED)

IP67: IMMERSED IN 1M WATER FOR 30 MINUTES

2. RATING: 30V 1A

3. SPECIFICATIONS:SEE "USB SERIES SPECIFICATIONS".

4. TO CONFORM TO SINGATRON HAZARDOUS SUBSTANCE FREE SPEC.

5. GREEN PRODUCT IDENTIFICATION LABEL ON PACKAGING: **RoHS COMPLIANT**

6. FOR PANEL THICKNESS Max.:4.0mm

7. TEMPERATURE RANGE: -20~80℃

8. TIGHTENING TORQUES: 0.8~1.0Nm(7.08~8.85lbf.in.).

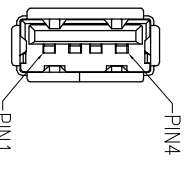
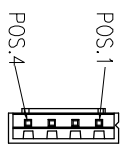

Pin Assignments
Front View

Pin Assignments
Front View

	3	4	5
M	UV GLUE	1	N/A
L	HEAT SHRINK TUBE	1	N/A
K	WATERPROOF CAP	1	N/A

REV	ECN NO	OR DESCRIPTION	REVISED	DATE
A	PDR NO.:A210906-1A		MF	2021.12.14
B	ECN NO.:S202205-C14		Elrod	2022.05.31
C	ECN NO.:S202206-C14		Elrod	2022.07.15
D	ECN NO.:S202305-C10		Elrod	2023.11.20

J	TERMINAL	4	PHOSPHOR BRONZE	GOLD PLATING
I	HOUSING	1	PLATIC	WHITE
H	HEAT SHRINK TUBE	2	N/A	BLACK
G	CABLE	1	USB2.0 28#*1P+24# *2C+ADB,UV Resistant FT4	BLACK PVC JACKET
F	USB A JACK	1	UI94V-0	N/A
E	HOUSING	1	PC UI.94V-0	BLACK
D	SCREW NUT	1	NYLON66 UI.94-HB	BLACK
C	GASKET	1	EPDM	BLACK
B	GLUE	1	JAY23A+B	BLACK
A	PCB	1	FR-4 UI.94V-0	GREEN
NO	DESCRIPTION		MATERIAL	PLATING & COLOR

UNLESS OTHERWISE SPECIFIED TOLERANCES

DECIMALS: ANGLES:

X :±0.5 X :±2°

X.X :±0.3 X.X :±1°

X.XX :±0.2 X.XX :±0.2

TITLE WATERPROOF USB2.0 JACK TO CONNECTOR

DWN Elrod PART NO.2UB3001-W051C8H

CHKD JUN SCALE 1:1 UNIT: mm

APVD JF SIZE: A3 SHEET:1 OF 1 REV:D

CUSTOMER COPY